





DRAWING TO BE READ IN CONJUNCTION WITH THE ARCHITECTS-- STORMWATER-- ENGINEERS PLANS PLUS ASSOCIATED SHEETS ATTACHED

LEGEND

CONCRETE PATHS & DRIVEWAY

TURF - REFER TO SHEET 3 FOR DETAILS

100mm COMPACTED RHYOLITE TO SHADED AREAS - REFER TO SHEET 3 FOR DETAILS

GARAGE BINS

CLOTHESLINES

WATER TANKS

1.8M HIGH COLORBOUND BOUNDARY FENCE AND DIVIDING FENCES PLUS RETURNS

1.5M HIGH SLATTED FRONT BOUNDARY FENCE

EXTERNAL YARD TAP

LETTERBOX

26.00 DENOTES DESIGN SPOT LEVELS

BWH DENOTES RETAINING WALL TO ENGINEERS DETAILS

450 x 450 STEPPING PAVERS

PRIVATE OPEN SPACE

DATE	BY	AMENDMENT

LANDSCAPE DESIGNER

**JK's GARDEN CREATIONS**  
10 KANWARY CLOSE  
RAYMOND TERRACE. NSW. 2324  
John A. Kime  
Mob. 0412582966  
email.gardenfora704@gmail.com  
Member AILDM  
Diploma in Horticulture Landscape Dsn. Cert. Ag  
IN ASSOCIATION WITH:-

**tolero**  
LANDSCAPE DESIGN

Mishka Sternbeck  
P.O. BOX 203 RUTHERFORD NSW 2320  
Mob: 0422406688  
email: mishkas@optusnet.com.au  
Member AILDM  
Diploma in Landscape Design

SITE ADDRESS

**MULTI DWELLING**  
LOT 25, DP 243010  
28 BLACKETT CLOSE,  
EAST MAITLAND

CLIENT

**RED McDONALD**

ARCHITECT



Pd Box 648 Maitland NSW 2320. JK: 0401 002 069. E: jk@urbanlivingdesign.com.au  
ENERGY SMART DESIGN, DEVELOPMENT & ASSESSMENT

DRAWN JK	DATED 16/02/2022
SCALES 1:100 @ A1 1:200 @ A3	CHECKED MS
SHEET 2 OF 3	JOB No.

Landscape Plan BROW191222

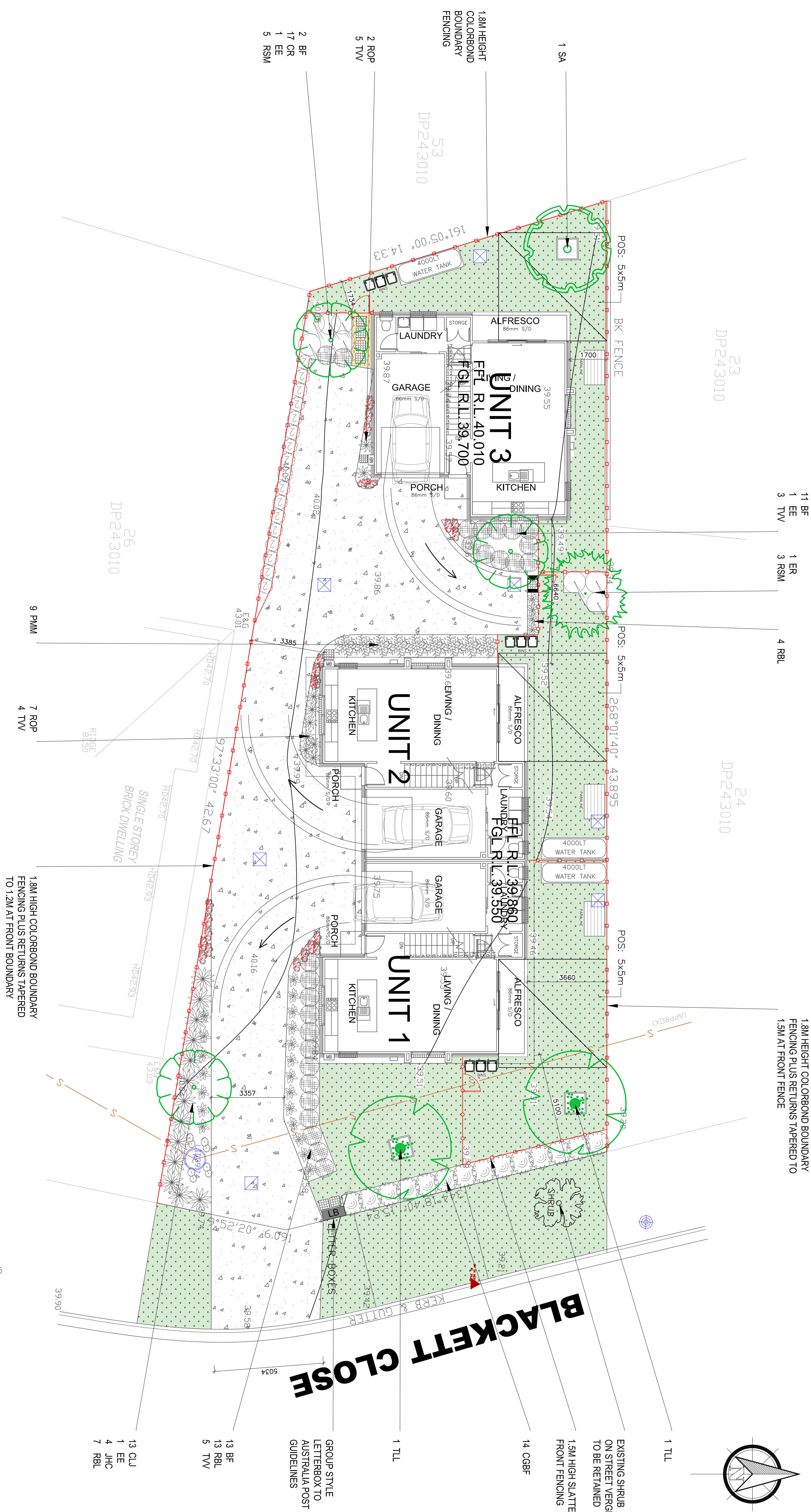

SITE AREA	749.4 m <sup>2</sup>
GROSS FLOOR AREA	394.8 m <sup>2</sup>
HARD STAND AREA	449.3 m <sup>2</sup>
SITE COVERAGE	60%
MAX. ALLOWED	60%
TOTAL LANDSCAPED AREA	40%

UNIT 1
PRIVATE OPEN SPACE excluding clothes drying and water tank
60 SQ/M

UNIT 2
PRIVATE OPEN SPACE excluding clothes drying and water tank
50 SQ/M

UNIT 3
PRIVATE OPEN SPACE excluding clothes drying and water tank
65 SQ/M

PLANT LEGEND

- BF BUXUS FAULKNER

CGBF CALLISTEMON GREAT BALLS OF FIRE

CLJ CALLISTEMON LITTLE JOHN

CR CORDYLINE RUBRA

EE ELAEOCARPUS EUMUNDI

ER ELEOCARPUS RETICULATUS

JHC JUNIPERUS HORIZONTALIS CTV
- PMM PITTOSPORUM MISS MUFFET

ROP RAPHIOLEPSIS ORIENTAL PEARL

RSM RAPHIOLEPSIS SNOW MAIDEN

RBL ROSMARINUS BLUE LAGOON

SA SYZYGIUM AUSTRALE

TLL TRISTANIOPSIS LAURINA LUCSIOUS

TVV TULBAGHIA VIOLACEA 'VAREIGATA'

PLANT SCHEDULE

TREES, SHRUBS, GRASSES & GROUNDCOVERS		Pot Size		Mature Size	
ID	Botanical Name	Common Name	Qty.	mm/ltr	W x H mtrs
BF	Buxus faulkner	Korean box	26	200mm	1.2x1.2m
CGBF	Callistemon 'Great Balls of Fire'	Red bottlebrush	14	200mm	1.2x1.2m
CU	Callistemon 'Little John'	Dwarf red bottlebrush	17	200mm	1.5x1.5m
CR	Cordylone fruticosa 'Rubra'	Red Palm Lily	17	200mm	1 x 2m
EE	Eleocarpus eumundi	Eumundi quongdong	3	25ltr	4 x 9m
ER	Eleocarpus reticulatus	Blue berry ash	1	25ltr	5 x 9m
JHC	Juniperus horizontalis ctvr		4	150mm	G/cover
PMM	Pittosporum miss muffet	Dwarf Japanese mock orange	9	200mm	1.2x1.2m
ROP	Raphiolepis oriental pearl		9	200mm	1 x 1m
RSM	Raphiolepis snow maiden		8	200mm	1.5 x 1.5m
RBL	Rosmarinus blue lagoon	Dwarf rosemary	24	150mm	1 x 7m
SA	Syzygium australe	Bush cherry	1	25ltr	5 x 9m
TLL	Tristaniopsis laurina 'luscious'	Water gum	2	25ltr	5 x 9m
TVV	Tulbaghia violacea variegata	Ornamental Variegated society garlic	17	150mm	4 x 4m

ALL HEIGHTS ARE AVERAGE DEPENDENT ON SOIL, CLIMATE, MAINTENANCE, ETC.

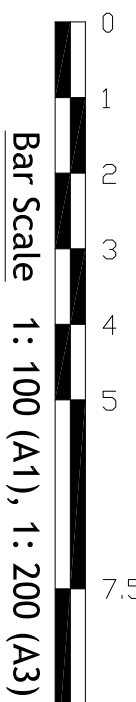



INITIAL PREPARATION

Verify all dimensions on site prior to commencement, locate all underground services and ensure no damage occurs to them throughout the contract. Comply with the requirements of the Council site guidelines in reference to erosion and sediment control regulations and other environmental controls to contain all within confines of the site. Spray with approved herbicide weed killer to all proposed lawn and garden areas to manufactures directions. Spray all weeds before commencement of any site works are carried and throughout the contract so as to suppress any weeds that may arise. Source all plants before start of job so the time factor to purchase from species list, will be true to plant schedule. The trees and shrubs recommended may sometimes be difficult to source due to times of year, weather, disease etc, this being the case, please inform early so arrangements to substitute can be made. Excess soils and contaminated soil are to removed within the guidelines of the council requirements to approved sites.

**SOIL PREPARATION**  
Cultivate to the minimum depth of 200mm in all garden areas and 100mm depth in all lawn areas; add a clay breaker to all garden areas, before the addition of garden soil is added. In all areas where fill is required, gain required levels using a premium soil mix. Where excavation is required as with clay excavate as required to allow for addition of 200-400mm depth of premium garden soil to garden areas and 100-300mm depth of topsoil to lawn areas. Undertake all required action to ensure that no root balls of proposed plants sit in clay wells and that all garden and lawn areas drain satisfactorily. It is the contractor's responsibility to ensure the end result of the project is that all lawn and garden areas drain sufficiently (both surface and subsurface), are at required finished levels and have sufficient soil depths to enable lawn and plants to thrive and grow. Soil levels are to allow for the addition of turf and mulches to specified requirements.

**GARDEN EDGING** Timber edging shall be located to all planter bed edges where meeting new or existing turfed areas. Use 38x150mm treated pine edging with 50x50 pegs at 1200 centres finished 30mm below top of edging.

**PLANTING**  
Purchase plants from an approved nursery that supplies plants that are true to type and species, healthy and able to store at nursery to maintain vigor before planting. Plant within 24hrs of plants being delivered. Set out plants as indicated on plan. Plant holes shall be dug approximately twice the width and 100mm deeper than the plant root balls that they are to receive. Add fertilizer, followed by 100mm of garden soil shall be placed into the base of hole and lightly consolidated. Remove plant from container install and backfill with garden soil and firmed into place. Base of stem shall finish flush with finished soil level. Thoroughly water all plants on first planting to soak soil of plant and surrounding soil so as to allow roots to adjust, do not allow drying out. Water regular over the first 3-4 weeks.

**FERTILISING**  
Use slow release fertilizers such as osmocote and or agriform tablets on all plants.

**MULCHING**  
Install 100mm minimum of Forest mulch as a mulch over all gardens. Shaded areas mulch with 10-25mm pebble mulch with weedmat under.

**GRAVEL AREAS**  
-Consolidated crushed thyoille, 100mm thick, over a compacted road base. Contain areas between gardens & gravel with timber edging.

**RETAINING WALLS**  
Erection of masonry block retaining walls treated timber retaining walls to be as per retaining wall specification guidelines. All retaining walls and footings to remain within the confines of boundary.

**TURF**  
Prepare for, level and lay cultivated Buffalo turf to all areas nominated on the plan as being lawn. To be layed within 24 hrs of delivery on site, making sure all areas are level for drainage, garden edging and paths.

**COMPLETION**  
Prior to practical completion removal from site all unwanted debris occurring from work. Satisfy council that all landscaping work has been undertaken in strict accordance with council's landscape codes and guide lines.

At the completion of landscape works and prior to the issue of the Certificate of Practical Completion.

Carry out the following during the maintenance period( determined by Builder). These works shall include but not limited to watering, weeding, fertilizing, pest and disease control, returfing, staking and tying, replanting, cultivation, pruning, aerating, renovation, top dressing and the like.

**EXISTING TREES**  
The existing trees to be retained on site are to be protected by surrounding with a 1.8m high chainmesh fence 3.00m from the base of the tree. This fence is to be erected prior to works commencing on site and is to be retained until all building works are completed. The enclosed area is to remain free of materials, machinery, vehicles or site sheds. With this preparation is to protect the existing tree and its critical roots from mechanical damage, compaction or any other adverse impacts resulting from construction activity and allowing the trees to grow the optimum growth once all works have been finalised.

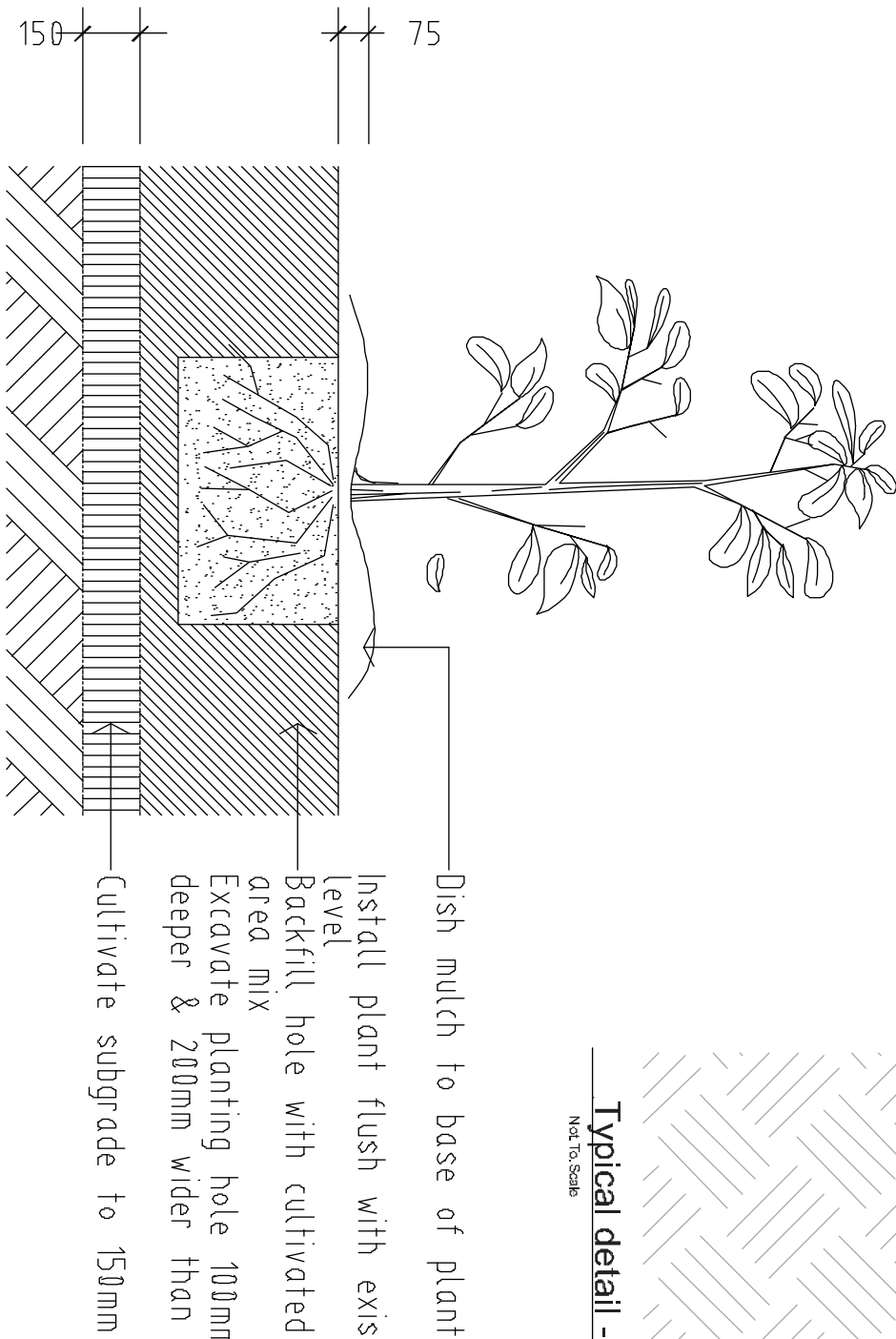
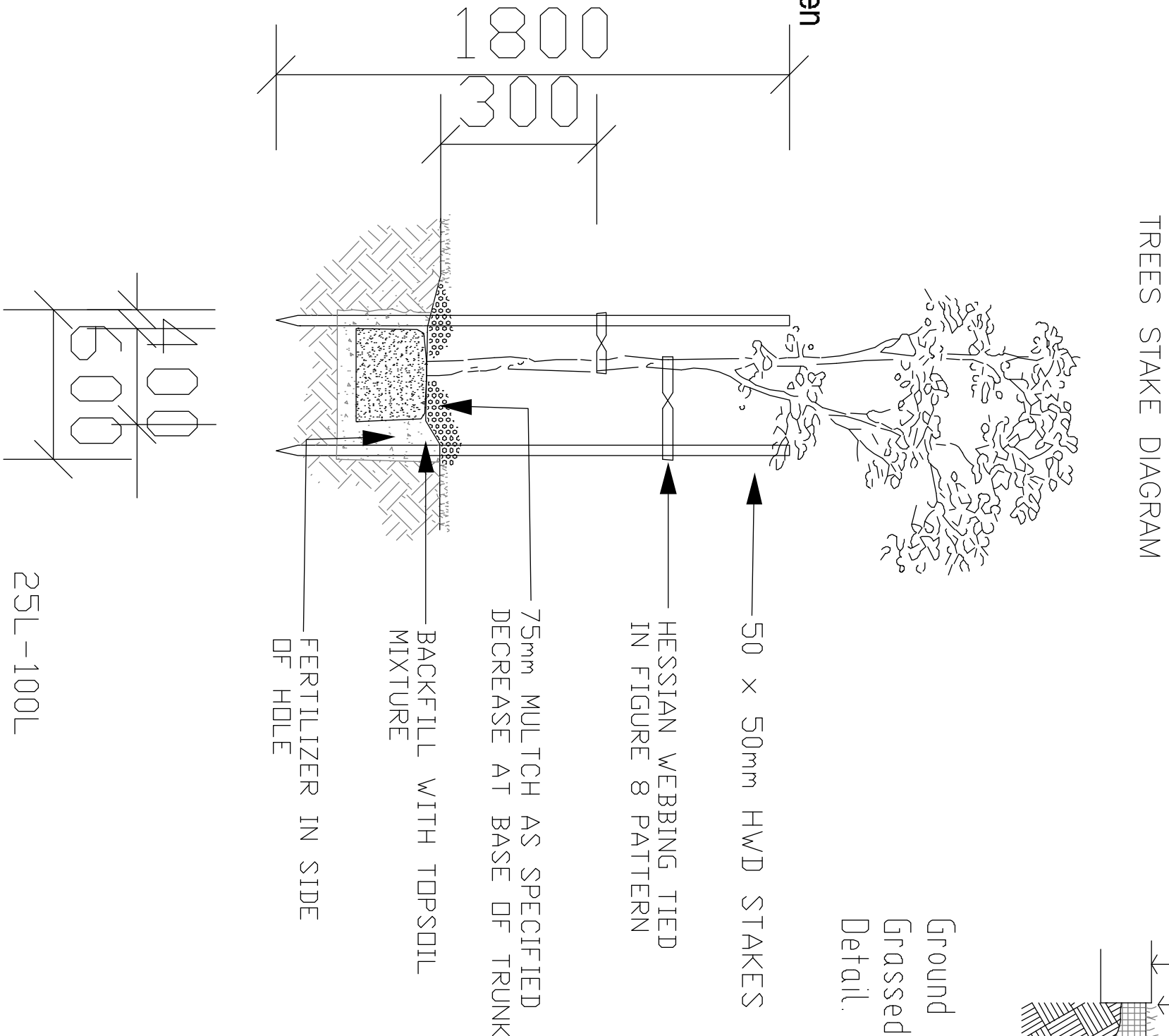
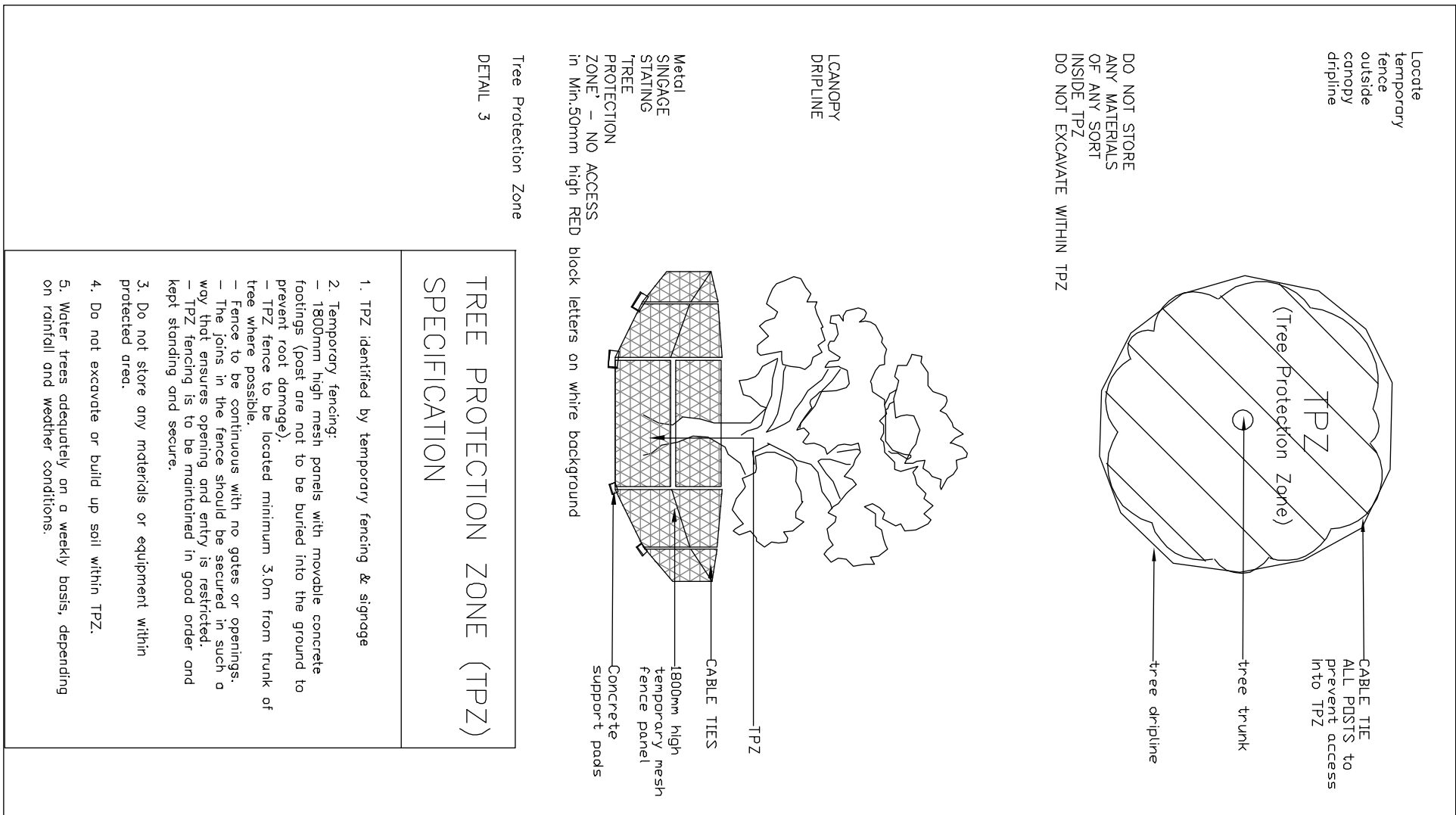

Planting in garden beds

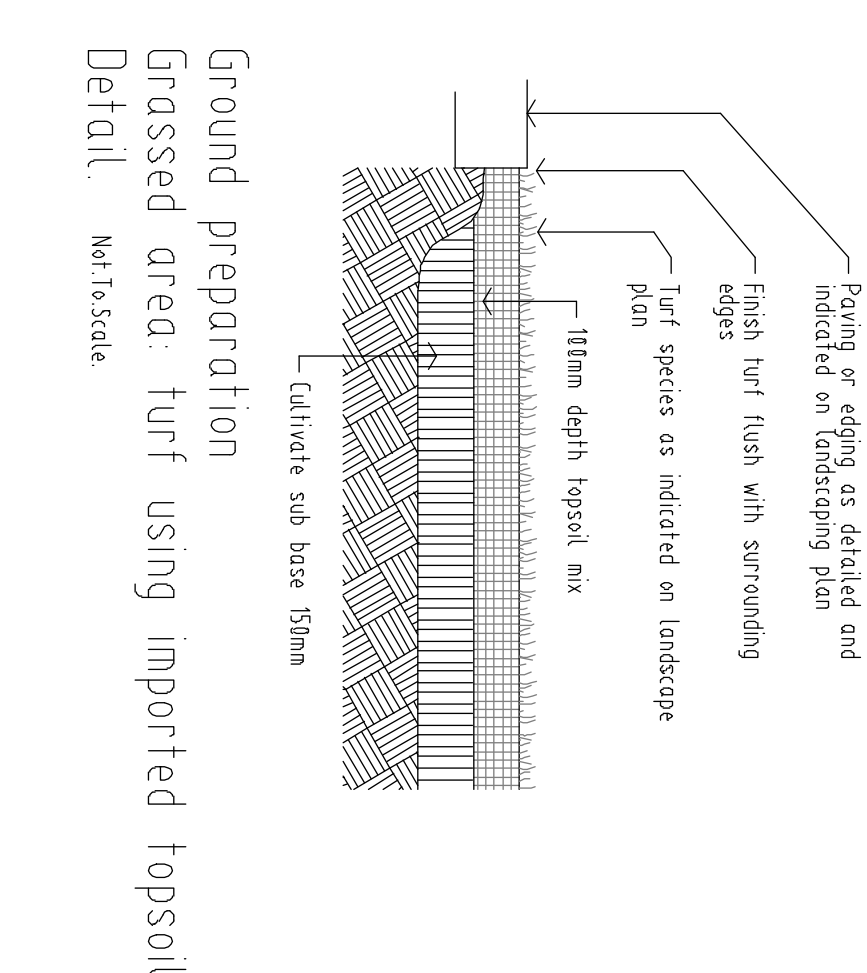

PLANT SCHEDULE			
TREES, SHRUBS, GRASSES & GROUNDCOVERS			
ID	Botanical Name	Common Name	
BF	Buxus faulkneri	Korean box	
CGBF	Callistemon 'Great Balls of Fire'	Red bottlebrush	
CU	Callistemon 'Little John'	Dwarf red bottlebrush	
CR	Cordyline fruticosa 'Rubra'	Red Palm Lily	
EE	Eleocharis eumundi	Eumundi quondong	
ER	Eleocharis reticulatus	Blue berry ash	
JHC	Juniperus horizontalis cvr	Dwarf Japanese mock orange	
PM	Pittosporum miss miffet	Dwarf Japanese mock orange	
RSM	Raphiolepis oriental pearl	Dwarf rosemary	
RBL	Rosmarinus blue lagoon	Bush cherry	
SA	Syzygium australe	Water gum	
TLL	Tristanopsis laurina 'Luscious'	Ornamental Variegated society garlic	
TVV	Tulbaghia violacea variegata	Ornamental Variegated society garlic	

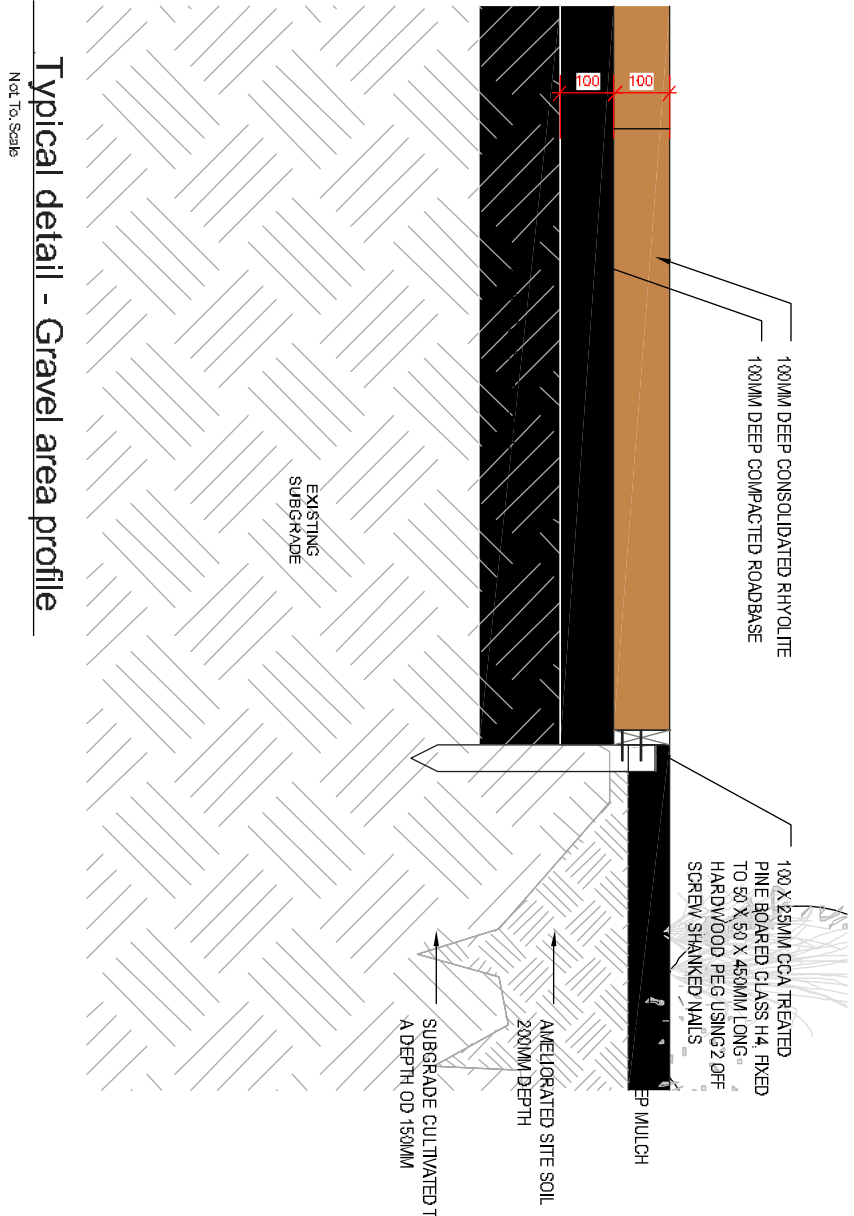

DRAWING TO BE READ IN CONJUNCTION WITH THE ARCHITECTS--STORMWATER-- ENGINEERS PLANS PLUS ASSOCIATED SHEETS ATTACHED

**JK'S GARDEN CREATIONS**  
10 KANNARY CLOSE,  
RAYMOND TERRACE, NSW. 2324  
John A. Kime  
Mob. 0412582966  
email: gardenthor704@gmail.com  
Member ALDM  
Diploma in Horticulture Landscape Design, Cert. Ag  
IN ASSOCIATION WITH:

**LANDSCAPE DESIGNER**

DATE BY AMENDMENT

**DIAL 1100 BEFORE YOU RING**

**tolero LANDSCAPE DESIGN**  
Mishka Sternbeck  
P.O. BOX 203 RUTHERFORD NSW 2320  
Mob: 0422406688  
email: mishkas@optusnet.com.au  
Member ALDM  
Diploma in Landscape Design

**CLIENT**  
MULTI DWELLING  
LOT 25, DP 243010  
28 BLACKETT CLOSE,  
EAST MAITLAND

**ARCHITECT**  
RED McDONALD

**DRAWN**  
JK  
DATE 16/02/2022  
CHECKED MS  
JOB NO. BROW191222

**Specification Plan**