

ALL DIMENSIONS, AREAS AND EASEMENTS ARE APPROXIMATE ONLY AND SUBJECT TO FINAL SURVEY.

Re-notification 2024

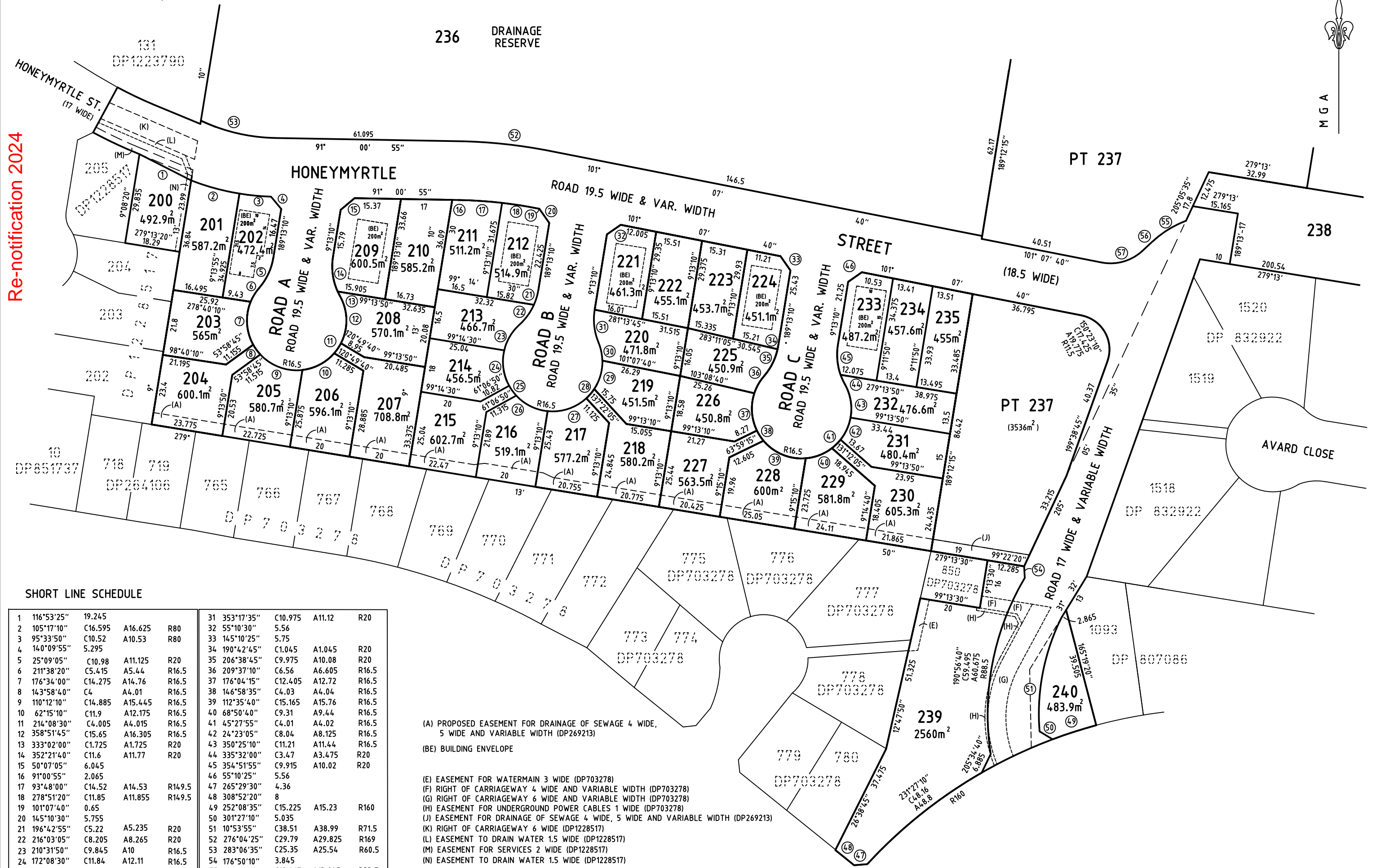
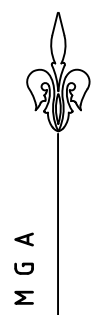

SHORT LINE SCHEDULE

1	116°53'25"	19.245					
2	105°17'10"	C16.595	A16.625	R80			
3	95°33'50"	C10.52	A10.53	R80			
4	140°09'55"	5.295					
5	25°09'05"	C10.98	A11.125	R20			
6	211°38'20"	C5.415	A5.44	R16.5			
7	176°34'00"	C14.275	A14.76	R16.5			
8	143°58'40"	C4	A4.01	R16.5			
9	110°12'10"	C14.885	A15.445	R16.5			
10	62°15'10"	C11.9	A12.175	R16.5			
11	214°08'30"	C4.005	A4.015	R16.5			
12	358°51'45"	C15.65	A16.305	R16.5			
13	333°02'00"	C1.725	A1.725	R20			
14	352°21'40"	C11.6	A11.77	R20			
15	50°07'05"	6.045					
16	91°00'55"	2.065					
17	93°48'00"	C14.52	A14.53	R149.5			
18	278°51'20"	C11.85	A11.855	R149.5			
19	101°07'40"	0.65					
20	145°10'30"	5.755					
21	196°42'55"	C5.22	A5.235	R20			
22	216°03'05"	C8.205	A8.265	R20			
23	210°31'50"	C9.845	A10	R16.5			
24	172°08'30"	C11.84	A12.11	R16.5			
25	144°05'50"	C4.03	A4.04	R16.5			
26	116°28'00"	C11.62	A11.875	R16.5			
27	71°36'30"	C13.55	A13.96	R16.5			
28	40°21'15"	C4.03	A4.04	R16.5			
29	16°04'10"	C9.795	A9.945	R16.5			
30	348°04'50"	C6.135	A6.17	R16.5			
31	353°17'35"	C10.975	A11.12	R20			
32	55°10'30"	5.56					
33	145°10'25"	5.75					
34	190°42'45"	C1.045	A1.045	R20			
35	206°38'45"	C9.975	A10.08	R20			
36	209°37'10"	C6.56	A6.605	R16.5			
37	176°04'15"	C12.405	A12.72	R16.5			
38	146°58'35"	C4.03	A4.04	R16.5			
39	112°35'40"	C15.165	A15.76	R16.5			
40	68°50'40"	C9.31	A9.44	R16.5			
41	45°27'55"	C4.01	A4.02	R16.5			
42	24°23'05"	C8.04	A8.125	R16.5			
43	350°25'10"	C11.21	A11.44	R16.5			
44	335°32'00"	C3.47	A3.475	R20			
45	354°51'55"	C9.915	A10.02	R20			
46	55°10'25"	5.56					
47	265°29'30"	4.36					
48	308°52'20"	8					
49	252°08'35"	C15.225	A15.23	R160			
50	301°27'10"	5.035					
51	10°53'55"	C38.51	A38.99	R71.5			
52	276°04'25"	C29.79	A29.825	R169			
53	283°06'35"	C25.35	A25.54	R60.5			
54	176°50'10"	3.845					
55	238°18'10"	C12.965	A13.045	R33.5			
56	227°08'45"	4.695					
57	254°08'10"	C14.07	A14.605	R15.5			

- (A) PROPOSED EASEMENT FOR DRAINAGE OF SEWAGE 4 WIDE, 5 WIDE AND VARIABLE WIDTH (DP269213)
- (BE) BUILDING ENVELOPE
- (E) EASEMENT FOR WATERMAIN 3 WIDE (DP703278)
- (F) RIGHT OF CARRIAGEWAY 4 WIDE AND VARIABLE WIDTH (DP703278)
- (G) RIGHT OF CARRIAGEWAY 6 WIDE AND VARIABLE WIDTH (DP703278)
- (H) EASEMENT FOR UNDERGROUND POWER CABLES 1 WIDE (DP703278)
- (J) EASEMENT FOR DRAINAGE OF SEWAGE 4 WIDE, 5 WIDE AND VARIABLE WIDTH (DP269213)
- (K) RIGHT OF CARRIAGEWAY 6 WIDE (DP1228517)
- (L) EASEMENT TO DRAIN WATER 1.5 WIDE (DP1228517)
- (M) EASEMENT FOR SERVICES 2 WIDE (DP1228517)
- (N) EASEMENT TO DRAIN WATER 1.5 WIDE (DP1228517)

SURVEYOR Name: REBECCA LYN JONES Date: Reference: 224172_ST2_DP	PLAN OF SUBDIVISION OF LOT 425 IN DP1262858, LOT 848 IN DP703278, LOT 1094 IN DP807086, LOT 8884 IN DP786883, LOT 1538 IN DP832922 AND LOT 206 IN DP1228517	LGA: MAITLAND Locality: THORNTON Reduction Ratio: 1:800 Lengths are in metres	REGISTERED
---	--	---	-------------------