

CIVIL ENGINEERING PLANS

WOODBERRY LEARNING CENTRE CAR PARK UPGRADES

LOT 1 DP 557998

WOODBERRY ROAD, WOODBERRY

NOTES

GENERAL

1. THESE DRAWINGS ARE TO BE READ IN CONJUNCTION WITH THE CONDITIONS STATED IN COUNCIL'S DEVELOPMENT APPROVAL AND THE APPROVED ARCHITECTURAL DRAWINGS WHERE APPLICABLE.
2. WHERE DRAWINGS ARE NOTED AS PRELIMINARY ISSUE, THEY SHOULD NOT BE USED TO OBTAIN A CONSTRUCTION CERTIFICATE NOR USED FOR CONSTRUCTION PURPOSES.
3. DRAWINGS ARE A DIAGRAMMATICAL REPRESENTATION OF THE WORK TO BE CARRIED OUT AND DIMENSIONS SHALL NOT BE OBTAINED BY SCALING.
4. ALL LOT DIMENSIONS, AREAS AND EASEMENTS ARE SUBJECT TO REGISTRATION OF DEPOSITED PLAN.
5. ALL LEVELS SHALL BE OBTAINED FROM ESTABLISHED BENCH MARKS AS DIRECTED BY THE SITE SUPERVISOR.
6. THE CONTRACTOR SHOULD CONFIRM THE INVERT LEVEL OF SPECIFIED DISCHARGE POINTS FOR GRAVITY PIPE NETWORKS (E.G. STORMWATER AND SEWER) PRIOR TO WORK, WITH ANY DISCREPANCY REPORTED TO METIRI BEFORE PROCEEDING.
7. ALL EXISTING UNDERGROUND SERVICES MUST BE LOCATED AND EXPOSED PRIOR TO EARTHWORKS COMMENCING AND IT IS THE RESPONSIBILITY OF THOSE PERSONS USING THIS PLAN TO CONFIRM BOTH POSITION AND LEVEL OF THESE UTILITIES IN CONJUNCTION WITH THE APPROPRIATE AUTHORITY. THE CONTRACTOR IS RESPONSIBLE FOR THE LOCATION, PROTECTION AND ADJUSTMENT TO ALL IN GROUND AND ABOVE GROUND SERVICES.
8. THE CONTRACTOR SHALL HAVE A REGISTERED SURVEYOR CONFIRM IF EXISTING SURVEY MARKS ARE LIKELY TO BE DISTURBED BY THE PROPOSED WORKS AND IF SO, SUBMIT A PRESERVATION OF SURVEY INFRASTRUCTURE (POSI) APPLICATION TO NSW LAND REGISTRY SERVICES (LRS) IN ACCORDANCE WITH THE SURVEYOR-GENERAL'S DIRECTIONS NO.11 PRESERVATION OF SURVEY INFRASTRUCTURE.



LOCALITY PLAN

CONSTRUCTION ISSUE

SHEET LIST

SHEET NUMBER	SHEET TITLE
01	COVERSHEET
02	DETAIL PLAN
03	EROSION & SEDIMENT CONTROL PLAN
04	EROSION & SEDIMENT CONTROL DETAILS
05	EROSION & SEDIMENT CONTROL NOTES
06	TYPICAL SECTIONS & DETAILS
07	ROAD PROFILES - SHEET 1
08	ROAD PROFILES - SHEET 2
09	STORMWATER DRAINAGE PROFILES & SCHEDULES
10	PAVEMENT JOINT PLAN
11	LINEMARKING & SIGNPOSTING PLAN
12	TREE REMOVAL PLAN

REV.	REVISION DETAILS	DES	DWN	CHK	DATE
0	PRELIMINARY ISSUE FOR REVIEW	JRR	DBM	JRR	07/06/22
1	AMENDMENTS	JRR	DBM	JRR	22/06/22
2	MINOR AMENDMENTS	JRR	DBM	JRR	24/06/22
3	ADDED TREE REMOVAL PLAN AND OTHER MINOR AMENDMENTS	JRR	DBM	JRR	28/06/22
4	CONCRETE PAVEMENT DETAILS ADDED.	JRR	DBM	JRR	13/07/22
5	AMENDMENTS	JRR	JRR	JRR	21/07/22

SURVEYED	
METIRI	
DATUM	SCALE
AHD	



PROJECT	CIVIL ENGINEERING PLANS WOODBERRY LEARNING CENTRE CAR PARK UPGRADES LOT 1 DP 557998 WOODBERRY ROAD, WOODBERRY
CLIENT	NSW DEPARTMENT OF EDUCATION

SHEET TITLE			
COVERSHEET			
PROJECT NUMBER	SHEET NUMBER	TOTAL SHEETS	REVISION
210171	01	12	5

LEGEND

[Grey Box]	PROPOSED AC AREAS
[Light Green Box]	PROPOSED CONCRETE AREAS
[Green Box]	PROPOSED LANDSCAPED AREAS
[Light Green Box]	PROPOSED SYNTHETIC TURF AREAS
[Dashed Line]	SURFACE CONTOURS (EXISTING/PROPOSED)
[RL10.000]	SURFACE SPOT LEVEL (EXISTING/PROPOSED)
[5.00%]	SURFACE SLOPE (EXISTING/PROPOSED)
[Brick Pattern]	RETAINING WALL (EXISTING/PROPOSED)
[S-S]	SEWER MAINS (EXISTING/PROPOSED)
[W-W]	WATER MAINS (EXISTING/PROPOSED)
[OHP]	OVERHEAD POWER (EXISTING/PROPOSED)
[UGE]	UNDERGROUND (EXISTING/PROPOSED)
[T-T]	TELECOMMUNICATIONS (EXISTING/PROPOSED)
[G-G]	GAS MAINS (EXISTING/PROPOSED)
[Blue Dashed]	STORMWATER PIPE (EXISTING/PROPOSED)
[Blue Dashed]	PROPOSED SUBSOIL DRAINAGE (INDICATIVE)
[Kerb Inlet Pit]	KERB INLET PIT (EXISTING/PROPOSED)
[Grated Pit]	GRATED PIT (EXISTING/PROPOSED)
[Sealed Pit]	SEALED PIT (EXISTING/PROPOSED)
[Headwall Outlet]	HEADWALL OUTLET (EXISTING/PROPOSED)
[Table Drain/Swale]	TABLE DRAIN/SWALE (EXISTING/PROPOSED)

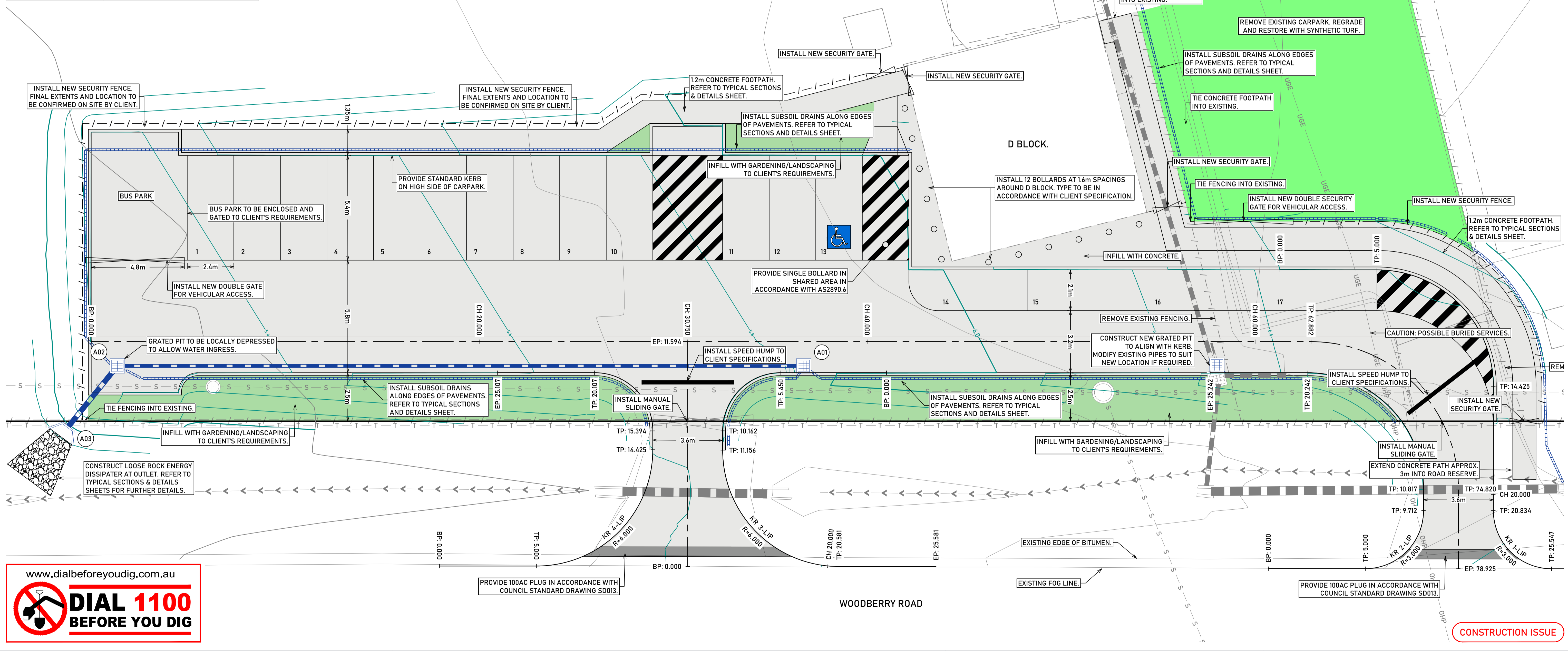

www.dialbeforeyoudig.com.au

REV.	REVISION DETAILS	DES	DWN	CHK	DATE
0	PRELIMINARY ISSUE FOR REVIEW	JRR	DBM	JRR	07/06/22
1	AMENDMENTS	JRR	DBM	JRR	22/06/22
2	MINOR AMENDMENTS	JRR	DBM	JRR	24/06/22
3	ADDED TREE REMOVAL PLAN AND OTHER MINOR AMENDMENTS	JRR	DBM	JRR	28/06/22
4	CONCRETE PAVEMENT DETAILS ADDED.	JRR	DBM	JRR	13/07/22

METIRI

DATUM: AHD SCALE: 1:100

SCALE @ A1

Metiri
Engineers • Surveyors • Planners

ABN 86 633 598 875 ACN 633 598 875
5/33 The Boulevard, Toronto NSW 2283
4950 5995 mail@metiri.com.au metiri.com.au

PROJECT: CIVIL ENGINEERING PLANS
WOODBERRY LEARNING CENTRE CAR PARK UPGRADES
LOT 1 DP 557998
WOODBERRY ROAD, WOODBERRY

CLIENT: NSW DEPARTMENT OF EDUCATION

SHEET TITLE: DETAIL PLAN			
PROJECT NUMBER	SHEET NUMBER	TOTAL SHEETS	REVISION
210171	02	12	4

LEGEND

	PROPOSED AC AREAS
	PROPOSED CONCRETE AREAS
	PROPOSED ROAD VERGE AREAS
	SURFACE CONTOURS (EXISTING/PROPOSED)
	SURFACE SPOT LEVEL (EXISTING/PROPOSED)
	SURFACE SLOPE (EXISTING/PROPOSED)
	RETAINING WALL (EXISTING/PROPOSED)
	SEWER MAINS (EXISTING/PROPOSED)
	WATER MAINS (EXISTING/PROPOSED)
	OVERHEAD POWER (EXISTING/PROPOSED)
	UNDERGROUND (EXISTING/PROPOSED)
	TELECOMMUNICATIONS (EXISTING/PROPOSED)
	GAS MAINS (EXISTING/PROPOSED)
	STORMWATER PIPE (EXISTING/PROPOSED)
	KERB INLET PIT (EXISTING/PROPOSED)
	GRATED PIT (EXISTING/PROPOSED)
	SEALED PIT (EXISTING/PROPOSED)
	HEADWALL OUTLET (EXISTING/PROPOSED)
	TABLE DRAIN/SWALE (EXISTING/PROPOSED)
	PROPOSED SEDIMENT FENCING
	PROPOSED EXCLUSION FENCING
	PROPOSED DIVERSION DRAIN (CLEAN/DIRTY)
	PROPOSED GEOTEXTILE INLET FILTER
	PROPOSED MESH & GRAVEL FILTER
	PROPOSED STOCKPILE
	PROPOSED GRAVEL SITE ACCESS

NOTES

- CONSTRUCTION SEQUENCING**
1. INSTALL EXCLUSION FENCING AS REQUIRED.
 2. CONSTRUCT STABILISED SITE ACCESS, DETERMINE LOCATION FOR SITE PARKING AND AMENITIES (IF REQUIRED).
 3. INSTALL CLEAN WATER DIVERSION DRAINS UP-SLOPE OF PROPOSED EARTHWORKS (IF REQUIRED).
 4. INSTALL SEDIMENT FENCING DOWN-SLOPE OF PROPOSED EARTHWORKS.
 5. CONSTRUCT DIRTY WATER DIVERSION DRAINS AND SEDIMENT BASIN/S (IF REQUIRED).
 6. CONSTRUCT REMAINING SEDIMENT CONTROLS IN ACCORDANCE WITH ESCP AND TO COUNCILS REQUIREMENTS WHERE SPECIFIED.
 7. CARRY OUT SITE CLEARING AND STRIPPING WORKS WHERE REQUIRED. STOCKPILE TOPSOIL AS DETAILED. MINIMISE GROUND DISTURBANCE AS MUCH AS PRACTICALLY POSSIBLE.
 8. REPLACE TOPSOIL AND REHABILITATE DISTURBED AREAS.
 9. APPLY PERMANENT STABILISATION CONTROLS (LANDSCAPING) AND REMOVE SEDIMENT CONTROLS.

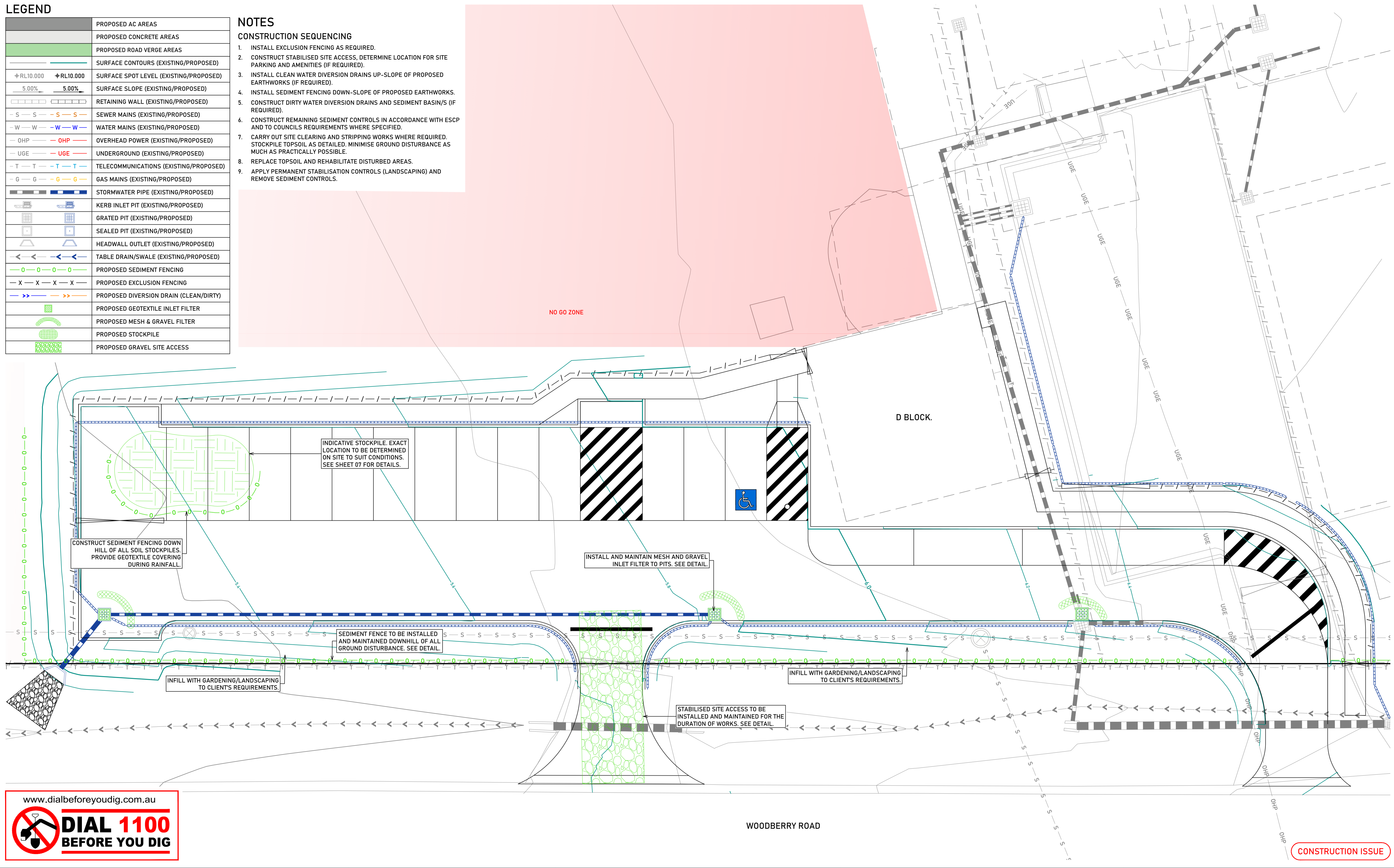

www.dialbeforeyoudig.com.au

CONSTRUCTION ISSUE

REV.	REVISION DETAILS	DES	DWN	CHK	DATE
0	PRELIMINARY ISSUE FOR REVIEW	JRR	DBM	JRR	07/06/22
1	AMENDMENTS	JRR	DBM	JRR	22/06/22
2	MINOR AMENDMENTS	JRR	DBM	JRR	24/06/22
3	ADDED TREE REMOVAL PLAN AND OTHER MINOR AMENDMENTS	JRR	DBM	JRR	28/06/22
4	CONCRETE PAVEMENT DETAILS ADDED.	JRR	DBM	JRR	13/07/22
5	AMENDMENTS	JRR	JRR	JRR	21/07/22

METIRI

DATUM: AHD SCALE: 1:100

SCALE @ A1

Metiri
Engineers • Surveyors • Planners

ABN 86 633 598 875 ACN 633 598 875
5/33 The Boulevard, Toronto NSW 2283
4950 5995 mail@metiri.com.au metiri.com.au

PROJECT: CIVIL ENGINEERING PLANS
WOODBERRY LEARNING CENTRE CAR PARK UPGRADES
LOT 1 DP 557998
WOODBERRY ROAD, WOODBERRY

CLIENT: NSW DEPARTMENT OF EDUCATION

SHEET TITLE			
EROSION & SEDIMENT CONTROL PLAN			
PROJECT NUMBER	SHEET NUMBER	TOTAL SHEETS	REVISION
210171	03	12	5

NOTES

SEDIMENT FENCE (SD 6-8)

1. CONSTRUCT SEDIMENT FENCES AS CLOSE AS POSSIBLE TO BEING PARALLEL TO THE CONTOURS OF THE SITE, BUT WITH SMALL RETURNS AS SHOWN IN THE DRAWING TO LIMIT THE CATCHMENT AREA OF ANY ONE SECTION. THE CATCHMENT AREA SHOULD BE SMALL ENOUGH TO LIMIT WATER FLOW IF CONCENTRATED AT ONE POINT TO 50 LITRES PER SECOND IN THE DESIGN STORM EVENT, USUALLY THE 10-YEAR EVENT.
2. CUT A 150mm DEEP TRENCH ALONG THE UPSLOPE LINE OF THE FENCE FOR THE BOTTOM OF THE FABRIC TO BE ENTRENCHED.
3. DRIVE 1.5m LONG STAR PICKETS INTO GROUND AT 2.5m INTERVALS (MAX) AT THE DOWNSLOPE EDGE OF THE TRENCH. ENSURE ANY STAR PICKETS ARE FITTED WITH SAFETY CAPS.
4. FIX SELF-SUPPORTING GEOTEXTILE TO THE UPSLOPE SIDE OF THE POSTS ENSURING IT GOES TO THE BASE OF THE TRENCH. FIX THE GEOTEXTILE WITH WIRE TIES OR AS RECOMMENDED BY THE MANUFACTURER. ONLY USE GEOTEXTILE SPECIFICALLY PRODUCED FOR SEDIMENT FENCING. THE USE OF SHADE CLOTH FOR THIS PURPOSE IS NOT SATISFACTORY.
5. JOIN SECTIONS OF FABRIC AT A SUPPORT POST WITH A 150mm OVERLAP.
6. BACKFILL THE TRENCH OVER THE BASE OF THE FABRIC AND COMPACT IT THOROUGHLY OVER THE GEOTEXTILE.

STOCKPILES (SD4-1)

1. PLACE STOCKPILES MORE THAN 2 (PREFERABLY 5) METRES FROM EXISTING VEGETATION, CONCENTRATED WATER FLOW, ROADS AND HAZARD AREAS.
2. CONSTRUCT ON THE CONTOUR AS LOW, FLAT, ELONGATED MOUNDS.
3. WHERE THERE IS SUFFICIENT AREA, TOPSOIL STOCKPILES SHALL BE LESS THAN 2m IN HEIGHT.
4. WHERE THEY ARE TO BE IN PLACE FOR MORE THAN 10 DAYS, STABILISE FOLLOWING THE APPROVED ESCP OR SWMP TO REDUCE THE C-FACTOR TO LESS THAN 0.10.
5. CONSTRUCT EARTH BANKS (STANDARD DRAWING 5-5) ON THE UPSLOPE SIDE TO DIVERT WATER AROUND STOCKPILES AND SEDIMENT FENCES (STANDARD DRAWING 6-8) 1m TO 2m DOWNSLOPE.

STABILISED SITE ACCESS (SD6-14)

1. STRIP THE TOPSOIL, LEVEL THE SITE AND COMPACT THE SUBGRADE.
2. COVER THE AREA WITH NEEDLE-PUNCHED GEOTEXTILE.
3. CONSTRUCT A 200mm THICK PAD OVER THE GEOTEXTILE USING ROAD BASE OR 30 MM AGGREGATE.
4. ENSURE THE STRUCTURE IS AT LEAST 15 METRES LONG OR TO BUILDING ALIGNMENT AND AT LEAST 3 METRES WIDE.
5. WHERE A SEDIMENT FENCE JOINS ONTO THE STABILISED ACCESS, CONSTRUCT A HUMP IN THE STABILISED ACCESS TO DIVERT WATER TO THE SEDIMENT FENCE.

MESH AND GRAVEL INLET FILTER (SD6-11)

1. INSTALL FILTERS TO KERB INLETS ONLY AT SAG POINTS.
2. FABRICATE A SLEEVE MADE FROM GEOTEXTILE OR WIRE MESH LONGER THAN THE LENGTH OF THE INLET PIT AND FILL IT WITH 25mm TO 50mm GRAVEL.
3. FORM AN ELLIPTICAL CROSS-SECTION ABOUT 150mm HIGH X 400mm WIDE.
4. PLACE THE FILTER AT THE OPENING LEAVING AT LEAST A 100-MM SPACE BETWEEN IT AND THE KERB INLET. MAINTAIN THE OPENING WITH SPACER BLOCKS.
5. FORM A SEAL WITH THE KERB TO PREVENT SEDIMENT BYPASSING THE FILTER.
6. SANDBAGS FILLED WITH GRAVEL CAN SUBSTITUTE FOR THE MESH OR GEOTEXTILE PROVIDING THEY ARE PLACED SO THAT THEY FIRMLY ABUT EACH OTHER AND SEDIMENT-LADEN WATERS CANNOT PASS BETWEEN.

KERBSIDE TURF STRIP (SD6-13)

1. INSTALL A 400mm MINIMUM WIDE ROLL OF TURF ON THE FOOTPATH NEXT TO THE KERB AND AT THE SAME LEVEL AS THE TOP OF THE KERB.
2. LAY 1.4m LONG TURF STRIPS NORMAL TO THE KERB EVERY 10m.
3. REHABILITATE DISTURBED SOIL BEHIND THE TURF STRIP FOLLOWING THE ESCP/SWMP.

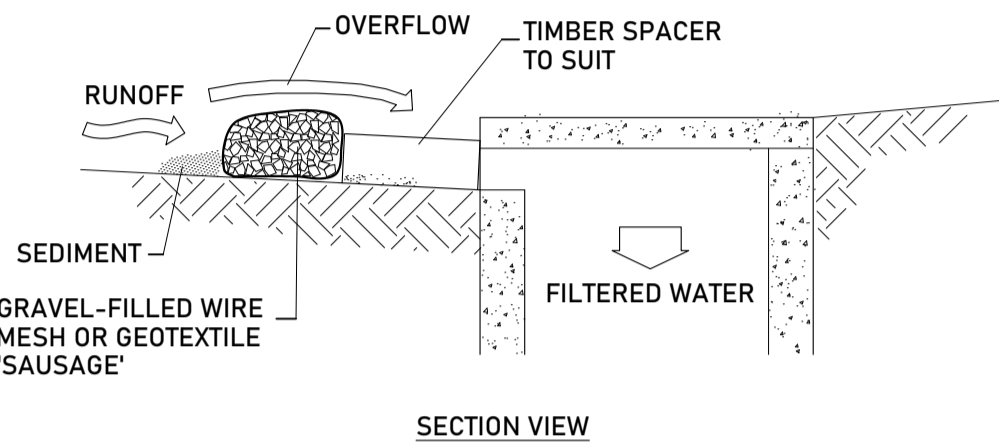
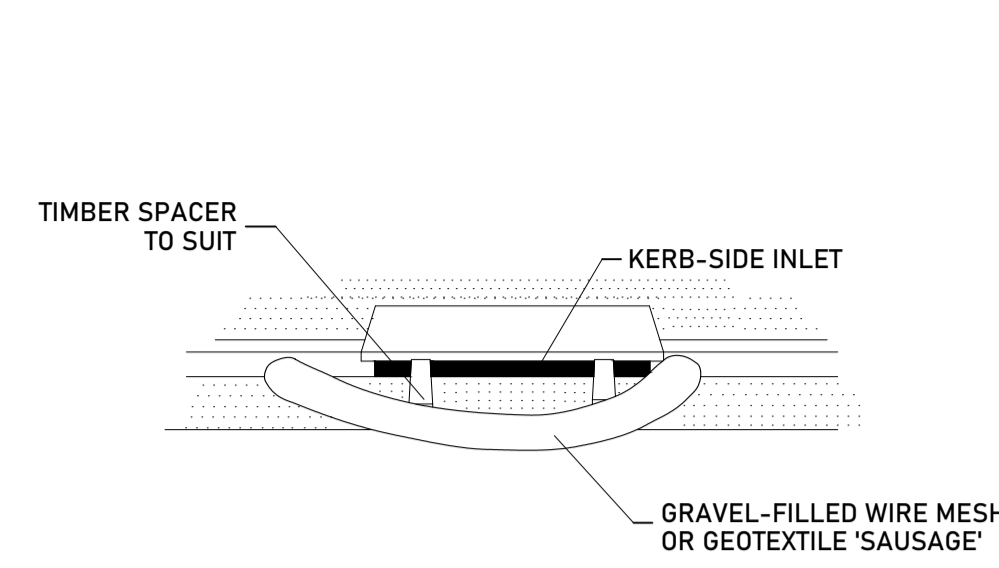

MESH AND GRAVEL INLET FILTER (SD 6-11) DETAIL
NTS

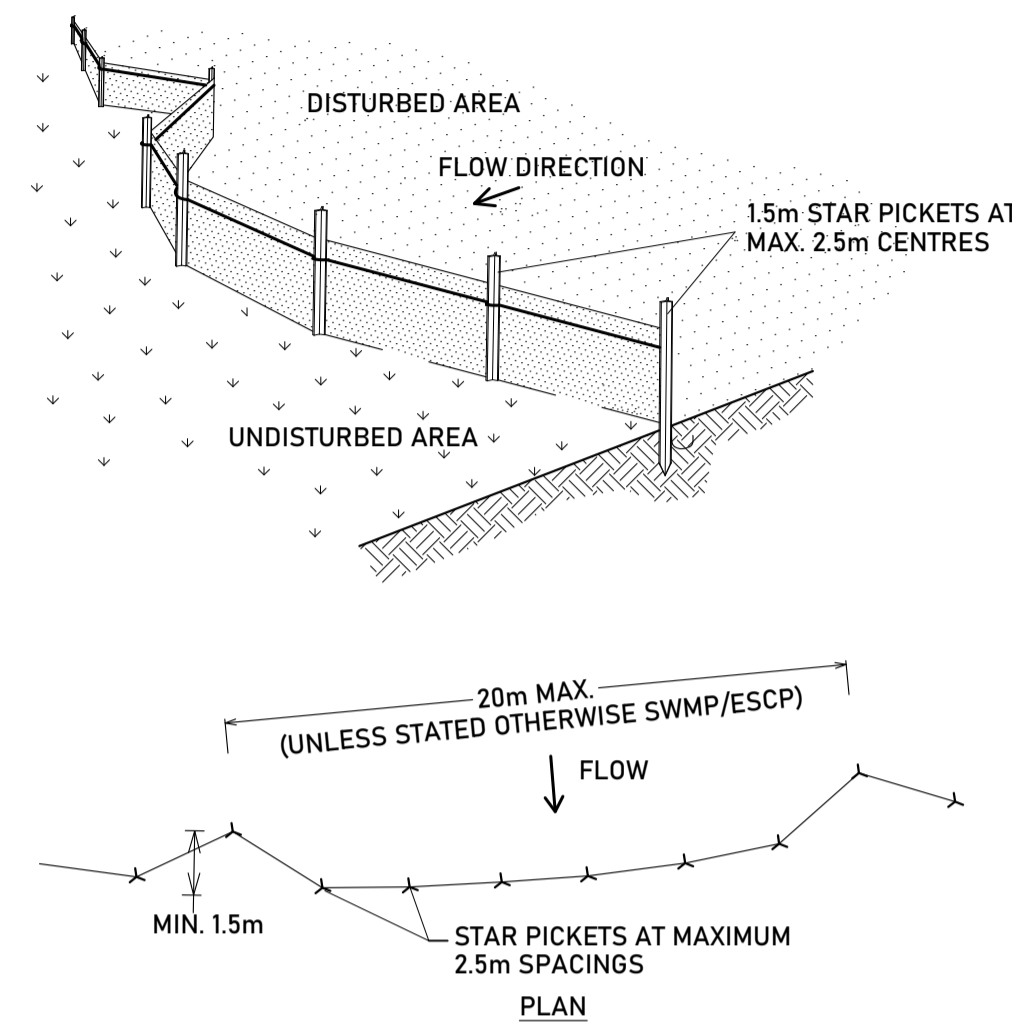
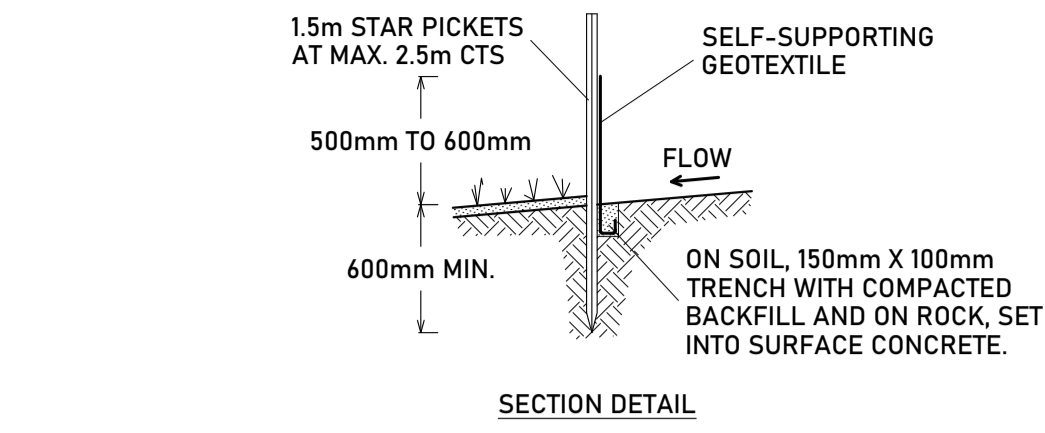

SEDIMENT FENCE (SD 6-8) DETAIL
NTS

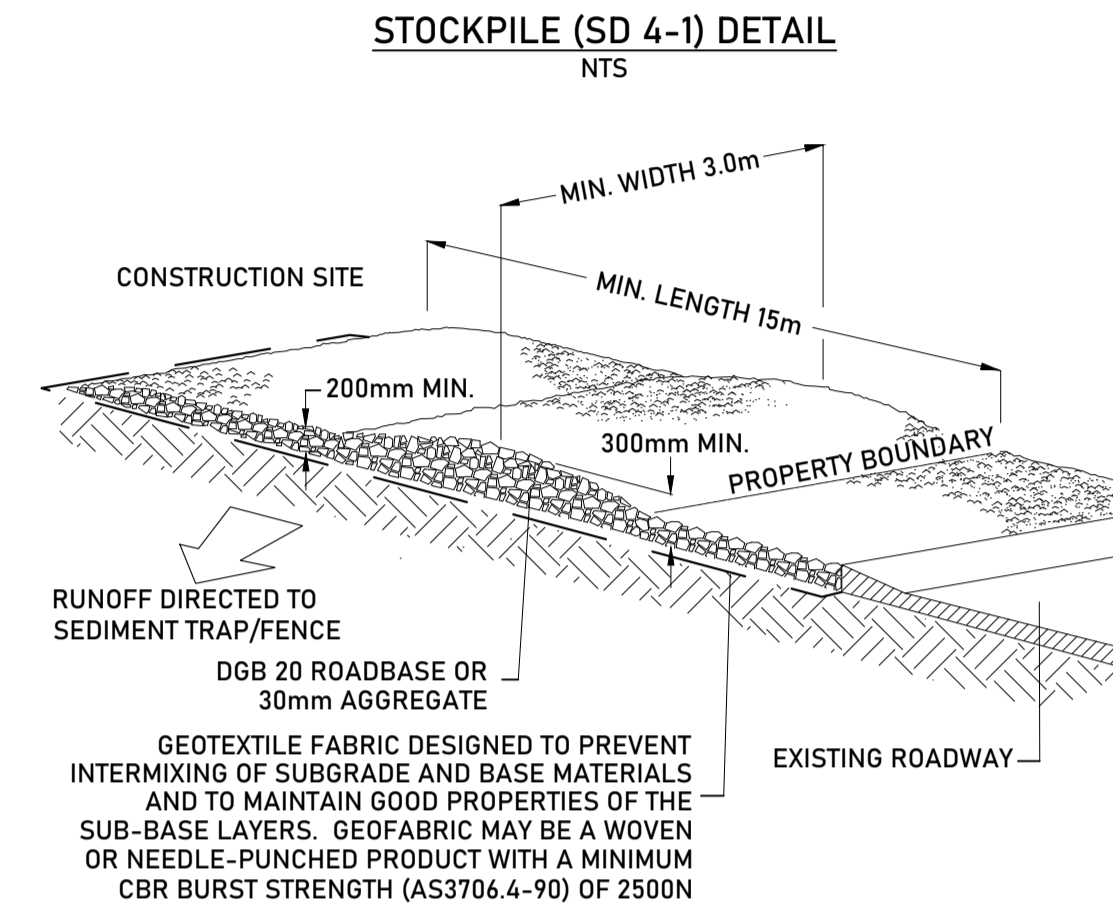
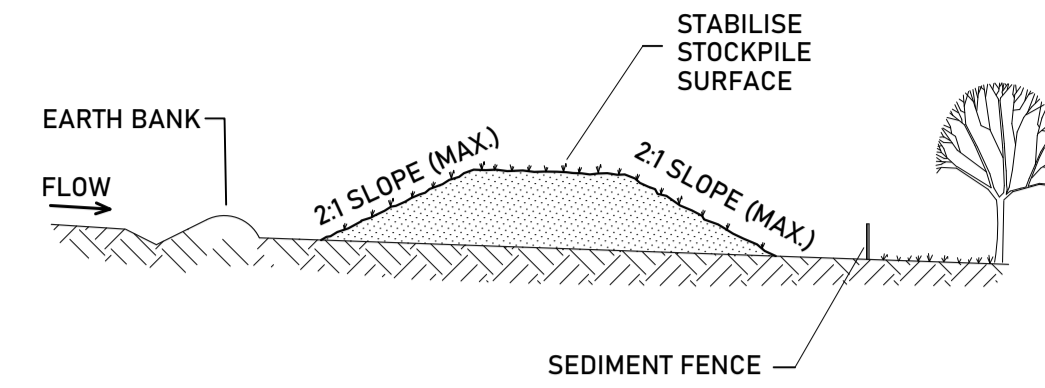

STABILISED SITE ACCESS (SD 6-14) DETAIL
NTS

CONSTRUCTION ISSUE

REV.	REVISION DETAILS	DES	DWN	CHK	DATE
0	PRELIMINARY ISSUE FOR REVIEW	JRR	DBM	JRR	07/06/22
1	AMENDMENTS	JRR	DBM	JRR	22/06/22
2	MINOR AMENDMENTS	JRR	DBM	JRR	24/06/22
3	ADDED TREE REMOVAL PLAN AND OTHER MINOR AMENDMENTS	JRR	DBM	JRR	28/06/22
4	CONCRETE PAVEMENT DETAILS ADDED.	JRR	DBM	JRR	13/07/22
5	AMENDMENTS	JRR	JRR	JRR	21/07/22

SURVEYED		METIRI	
DATUM	SCALE		
AHD			

PROJECT	CIVIL ENGINEERING PLANS WOODBERRY LEARNING CENTRE CAR PARK UPGRADES LOT 1 DP 557998 WOODBERRY ROAD, WOODBERRY		
CLIENT	NSW DEPARTMENT OF EDUCATION		

SHEET TITLE			
EROSION & SEDIMENT CONTROL DETAILS			
PROJECT NUMBER	SHEET NUMBER	TOTAL SHEETS	REVISION
210171	04	12	5

PLOT DATE: 21/07/2022 FILE PATH: C:\OneDrive\Metiri Consultants Pty Ltd\Metiri - Documents\Projects\2021\210171\04 - CADD\Drawings\Civil Engineering Plans\

EROSION & SEDIMENT CONTROL NOTES

GENERAL

1. ESCP REFERS TO EROSION AND SEDIMENT CONTROL PLAN AND SWMP REFERS TO SOIL AND WATER MANAGEMENT PLAN.
2. ESC REFERS TO EROSION AND SEDIMENT CONTROL.
3. SEDIMENT, INCLUDES, BUT IS NOT LIMITED TO, CLAY, SILT, SAND, GRAVEL, SOIL, MUD, CEMENT, AND CERAMIC WASTE.
4. ANY REFERENCE TO THE BLUE BOOK REFERS TO MANAGING URBAN STORMWATER- SOILS AND CONSTRUCTION. LANDCOM, 2004.
5. ANY REFERENCE TO THE IECA WHITE BOOKS (2008) REFERS TO IECA2008. BEST PRACTICE EROSION AND SEDIMENT CONTROL. BOOKS 1-6. INTERNATIONAL EROSION CONTROL ASSOCIATION (AUSTRALASIA). PICTON NSW.
6. ANY MATERIAL DEPOSITED IN ANY CONSERVATION AREA FROM WORKS ASSOCIATED WITH THE DEVELOPMENT SHALL BE REMOVED IMMEDIATELY BY MEASURES INVOLVING MINIMAL GROUND AND/OR VEGETATION DISTURBANCE AND NO MACHINERY, OR FOLLOWING DIRECTIONS BY COUNCIL AND/OR WITHIN A TIMEFRAME ADVISED BY COUNCIL.

THE ESCP

7. THE ESCP AND ITS ASSOCIATED ESC MEASURES SHALL BE CONSTANTLY MONITORED, REVIEWED, AND MODIFIED AS REQUIRED TO CORRECT DEFICIENCIES. COUNCIL HAS THE RIGHT TO DIRECT CHANGES IF, IN ITS OPINION, THE MEASURES THAT ARE PROPOSED OR HAVE BEEN INSTALLED ARE INADEQUATE TO PREVENT POLLUTION.
8. PRIOR TO ANY ACTIVITIES ON SITE, THE RESPONSIBLE PERSON(S) IS TO BE NOMINATED. THE RESPONSIBLE PERSON(S) SHALL BE RESPONSIBLE FOR THE ESC MEASURES ONSITE. THE NAME, ADDRESS AND 24-HOUR CONTACT DETAILS OF THE PERSON(S) SHALL BE PROVIDED TO COUNCIL IN WRITING. COUNCIL SHALL BE ADVISED WITHIN 48 HOURS OF ANY CHANGES TO THE RESPONSIBLE PERSON(S), OR THEIR CONTACT DETAILS, IN WRITING.
9. AT LEAST 14 DAYS BEFORE THE NATURAL SURFACE IS DISTURBED IN ANY NEW STAGE, THE CONTRACTOR SHALL SUBMIT TO THE CERTIFIER, A PLAN SHOWING ESC MEASURES FOR THAT STAGE. THE DEGREE OF DESIGN DETAIL SHALL BE BASED ON THE DISTURBED AREA.
10. AT ANY TIME, THE ESC MEASURES ON SITE SHALL BE APPROPRIATE FOR THE AREA OF DISTURBANCE AND ITS CHARACTERISTICS INCLUDING SOILS (IN ACCORDANCE WITH THOSE REQUIRED FOR THE SITE AS PER DCP).
11. THE IMPLEMENTATION OF THE ESCP SHALL BE SUPERVISED BY PERSONNEL WITH APPROPRIATE QUALIFICATIONS AND/OR EXPERIENCE IN ESC ON CONSTRUCTION SITES.
12. THE APPROVED ESCP SHALL BE AVAILABLE ON-SITE FOR INSPECTION BY COUNCIL OFFICERS WHILE WORK ACTIVITIES ARE OCCURRING.
13. THE APPROVED ESCP SHALL BE UP TO DATE AND SHOW A TIMELINE OF INSTALLATION, MAINTENANCE AND REMOVAL OF ESC MEASURES.
14. ALL ESC MEASURES SHALL BE APPROPRIATE FOR THE SEDIMENT TYPE(S) OF THE SOILS ON SITE, IN ACCORDANCE WITH THE BLUE BOOK, IECA WHITE BOOKS OR OTHER CURRENT RECOGNISED INDUSTRY STANDARD FOR ESC FOR AUSTRALIAN CONDITIONS.
15. ADEQUATE SITE DATA, INCLUDING SOIL DATA FROM A NATA APPROVED LABORATORY, SHALL BE OBTAINED TO ALLOW THE PREPARATION OF AN APPROPRIATE ESCP, AND ALLOW THE SELECTION, DESIGN AND SPECIFICATION OF REQUIRED ESC MEASURES.
16. ALL WORKS SHALL BE CARRIED OUT IN ACCORDANCE WITH THE APPROVED ESCP (AS AMENDED FROM TIME TO TIME) UNLESS CIRCUMSTANCES ARISE WHERE: A) COMPLIANCE WITH THE ESCP WOULD INCREASE THE POTENTIAL FOR ENVIRONMENTAL HARM; OR B) CIRCUMSTANCES CHANGE DURING CONSTRUCTION AND THOSE CIRCUMSTANCES COULD NOT HAVE BEEN FORESEEN; OR C) COUNCIL DETERMINES THAT UNACCEPTABLE OFF-SITE SEDIMENTATION IS OCCURRING AS A RESULT OF A LAND-DISTURBING ACTIVITY. IN EITHER CASE, THE PERSON(S) RESPONSIBLE MAYBE REQUIRED TO TAKE ADDITIONAL, OR ALTERNATIVE PROTECTIVE ACTION, AND/OR UNDERTAKE REASONABLE RESTORATION WORKS WITHIN THE TIMEFRAME SPECIFIED BY THE COUNCIL.
17. ADDITIONAL ESC MEASURES SHALL BE IMPLEMENTED, AND A REVISED ESCP SUBMITTED FOR APPROVAL TO THE CERTIFIER (WITHIN FIVE BUSINESS DAYS OF ANY SUCH AMENDMENTS) IN THE EVENT THAT: A) THERE IS A HIGH PROBABILITY THAT SERIOUS OR MATERIAL ENVIRONMENTAL HARM MAY OCCUR AS A RESULT OF SEDIMENT LEAVING THE SITE; OR B) THE IMPLEMENTED WORKS FAIL TO ACHIEVE COUNCIL'S WATER QUALITY OBJECTIVES SPECIFIED IN THESE CONDITIONS; OR C) SITE CONDITIONS SIGNIFICANTLY CHANGE; OR D) SITE INSPECTIONS INDICATE THAT THE IMPLEMENTED WORKS ARE FAILING TO ACHIEVE THE "OBJECTIVE" OF THE ESCP.
18. A COPY OF ANY AMENDED ESCP SHALL BE FORWARDED TO AN APPROPRIATE COUNCIL OFFICER, WITHIN FIVE BUSINESS DAYS OF ANY SUCH AMENDMENTS.

SITE ESTABLISHMENT INCLUDING CLEARING & MULCHING

19. NO LAND CLEARING SHALL BE UNDERTAKEN UNLESS PRECEDED BY THE INSTALLATION OF ADEQUATE DRAINAGE AND SEDIMENT CONTROL MEASURES, UNLESS SUCH CLEARING IS REQUIRED FOR THE PURPOSE OF INSTALLING SUCH MEASURES, IN WHICH CASE, ONLY THE MINIMUM CLEARING REQUIRED TO INSTALL SUCH MEASURES SHALL OCCUR.
20. BULK TREE CLEARING AND GRUBBING OF THE SITE SHALL BE IMMEDIATELY FOLLOWED BY SPECIFIED TEMPORARY EROSION CONTROL MEASURES (E.G. TEMPORARY GRASSING OR MULCHING) PRIOR TO COMMENCEMENT OF EACH STAGE OF CONSTRUCTION WORKS.
21. TREES AND VEGETATION CLEARED FROM THE SITE SHALL BE MULCHED ON SITE WITHIN 7 DAYS OF CLEARING.
22. APPROPRIATE MEASURES SHALL BE UNDERTAKEN TO CONTROL ANY DUST ORIGINATING DUE TO THE MULCHING OF VEGETATION ONSITE.
23. ALL OFFICE FACILITIES AND OPERATIONAL ACTIVITIES SHALL BE LOCATED SUCH THAT ANY EFFLUENT, INCLUDING WASH-DOWN WATER, CAN BE TOTALLY CONTAINED AND TREATED WITHIN THE SITE.
24. ALL REASONABLE AND PRACTICABLE MEASURES SHALL BE TAKEN TO ENSURE STORM WATER RUNOFF FROM ACCESS ROADS AND STABILISED ENTRY/ EXIT SYSTEMS, DRAINS TO AN APPROPRIATE SEDIMENT CONTROL DEVICE.
25. SITE EXIT POINTS SHALL BE APPROPRIATELY MANAGED TO MINIMISE THE RISK OF SEDIMENT BEING TRACKED ONTO SEALED, PUBLIC ROADWAYS.
26. STORMWATER RUNOFF FROM ACCESS ROADS AND STABILISED ENTRY/ EXIT POINTS SHALL DRAIN TO AN APPROPRIATE SEDIMENT CONTROL DEVICE.

SITE MONITORING AND MAINTENANCE

49. THE APPLICANT SHALL ENSURE THAT APPROPRIATE PROCEDURES AND SUITABLY QUALIFIED PERSONNEL ARE ENGAGED TO PLAN AND CONDUCT SITE INSPECTIONS AND WATER QUALITY MONITORING THROUGHOUT THE CONSTRUCTION AND MAINTENANCE PHASE.
50. ALL ESC MEASURES SHALL BE INSPECTED AND ANY MAINTENANCE UNDERTAKEN IMMEDIATELY:
 - A) AT LEAST DAILY (WHEN WORK IS OCCURRING ON-SITE);
 - AND B) AT LEAST WEEKLY (WHEN WORK IS NOT OCCURRING ON-SITE);
 - AND C) WITHIN 24HRS OF EXPECTED RAINFALL;
 - AND D) WITHIN 18HRS OF A RAINFALL EVENT THAT CAUSES RUNOFF ON THE SITE.
51. WRITTEN RECORDS SHALL BE KEPT ON SITE OF ESC MONITORING AND MAINTENANCE ACTIVITIES CONDUCTED DURING THE CONSTRUCTION AND MAINTENANCE PERIODS AND BE AVAILABLE TO COUNCIL OFFICERS ON REQUEST.
52. ALL ENVIRONMENTALLY RELEVANT INCIDENTS SHALL BE RECORDED IN A FIELD LOG THAT SHALL REMAIN ACCESSIBLE TO ALL RELEVANT REGULATORY AUTHORITIES.
53. ALL WATER QUALITY DATA, INCLUDING DATES OF RAINFALL, DATES OF TESTING, TESTING RESULTS AND DATES OF WATER RELEASE, SHALL BE KEPT IN AN ON-SITE REGISTER. THE REGISTER IS TO BE MAINTAINED UP TO DATE FOR THE DURATION OF THE APPROVED WORKS AND BE AVAILABLE ON-SITE FOR INSPECTION BY ALL RELEVANT REGULATORY AUTHORITIES ON REQUEST.
54. AT NOMINATED INSTREAM WATER MONITORING SITES, A MINIMUM OF 3 WATER SAMPLES SHALL BE TAKEN AND ANALYSED, AND THE AVERAGE RESULT USED TO DETERMINE QUALITY.

INSTREAM WORKS

55. ALL INSTREAM WORKS (INCLUDING IN OR ADJACENT TO WATERCOURSES NATURAL OR MANMADE, FLOWING OR NOT) SHALL BE CARRIED OUT IN ACCORDANCE WITH THE IECA WHITE BOOKS.

SITE MANAGEMENT INCLUDING DUST

38. PRIORITY SHALL BE GIVEN TO THE PREVENTION, OR AT LEAST THE MINIMISATION, OF SOIL EROSION, RATHER THAN THE TRAPPING OF DISPLACED SEDIMENT. SUCH A CLAUSE SHALL NOT REDUCE THE RESPONSIBILITY TO APPLY AND MAINTAIN, AT ALL TIMES, ALL NECESSARY ESC MEASURES.
39. MEASURES USED TO CONTROL WIND EROSION SHALL BE APPROPRIATE FOR THE LOCATION AND PREVENT SOIL EROSION AND EMISSIONS FROM SITE AT ALL TIMES, INCLUDING WORKING HOURS, OUT OF HOURS, WEEKENDS, PUBLIC HOLIDAYS, AND DURING ANY OTHER SHUTDOWN PERIODS.
40. THE APPLICATION OF LIQUID OR CHEMICAL-BASED DUST SUPPRESSION MEASURES SHALL ENSURE THAT SEDIMENT-LADEN RUNOFF RESULTING FROM SUCH MEASURES DOES NOT CREATE A TRAFFIC OR ENVIRONMENTAL HAZARD.
41. ALL CUT AND FILL EARTH BATTERS LESS THAN 3M IN ELEVATION SHALL BE TOPSOILED, AND GRASS SEEDED/ HYDRO-MULCHED WITHIN 10 DAYS OF COMPLETION OF GRADING IN CONSULTATION WITH COUNCIL.
42. ALL DISTURBED AREAS SHALL BE STABILISED IN ACCORDANCE WITH TIMELINES IN THE BLUE BOOK.
43. ALL REASONABLE AND PRACTICABLE MEASURES SHALL BE TAKEN TO PREVENT, OR AT LEAST MINIMISE, THE RELEASE OF SEDIMENT FROM THE SITE.
44. SUITABLE ALL-WEATHER MAINTENANCE ACCESS SHALL BE PROVIDED TO ALL SEDIMENT CONTROL DEVICES.
45. SEDIMENT CONTROL DEVICES, OTHER THAN SEDIMENT BASINS, SHALL BE DE-SILTED AND MADE FULLY OPERATIONAL AS SOON AS REASONABLE AND PRACTICABLE AFTER A SEDIMENT-PRODUCING EVENT, WHETHER NATURAL OR ARTIFICIAL, IF THE DEVICE'S SEDIMENT RETENTION CAPACITY FALLS BELOW 75% OF ITS DESIGN RETENTION CAPACITY.
46. ALL EROSION AND SEDIMENT CONTROL MEASURES, INCLUDING DRAINAGE CONTROL MEASURES, SHALL BE MAINTAINED IN PROPER WORKING ORDER AT ALL TIMES DURING THEIR OPERATIONAL LIVES.
47. WASHING/ FLUSHING OF SEALED ROADWAYS SHALL ONLY OCCUR WHERE SWEEPING HAS FAILED TO REMOVE SUFFICIENT SEDIMENT AND THERE IS A COMPELLING NEED TO REMOVE THE REMAINING SEDIMENT (E.G. FOR SAFETY REASONS). IN SUCH CIRCUMSTANCES, ALL REASONABLE AND PRACTICABLE SEDIMENT CONTROL MEASURES SHALL BE USED TO PREVENT, OR AT LEAST MINIMISE, THE RELEASE OF SEDIMENT INTO RECEIVING WATERS. ONLY THOSE MEASURES THAT WILL NOT CAUSE SAFETY AND PROPERTY FLOODING ISSUES SHALL BE EMPLOYED. SEDIMENT REMOVED FROM ROADWAYS SHALL BE DISPOSED OF IN A LAWFUL MANNER THAT DOES NOT CAUSE ONGOING SOIL EROSION OR ENVIRONMENTAL HARM.
48. SEDIMENT REMOVED FROM SEDIMENT TRAPS AND PLACES OF SEDIMENT DEPOSITION SHALL BE DISPOSED OF IN A LAWFUL MANNER THAT DOES NOT CAUSE ONGOING SOIL EROSION OR ENVIRONMENTAL HARM.

CONSTRUCTION ISSUE

REV.	REVISION DETAILS	DES	DWN	CHK	DATE	N	SURVEYED		PROJECT	SHEET TITLE			
0	PRELIMINARY ISSUE FOR REVIEW	JRR	DBM	JRR	07/06/22		METIRI			CIVIL ENGINEERING PLANS WOODBERRY LEARNING CENTRE CAR PARK UPGRADES LOT 1 DP 557998 WOODBERRY ROAD, WOODBERRY	EROSION & SEDIMENT CONTROL NOTES		
1	AMENDMENTS	JRR	DBM	JRR	22/06/22		DATUM	SCALE					
2	MINOR AMENDMENTS	JRR	DBM	JRR	24/06/22		AHD						
3	ADDED TREE REMOVAL PLAN AND OTHER MINOR AMENDMENTS	JRR	DBM	JRR	28/06/22								
4	CONCRETE PAVEMENT DETAILS ADDED.	JRR	DBM	JRR	13/07/22								
5	AMENDMENTS	JRR	JRR	JRR	21/07/22				CLIENT	PROJECT NUMBER	SHEET NUMBER	TOTAL SHEETS	REVISION
									NSW DEPARTMENT OF EDUCATION	210171	05	12	5



FILE PATH: C:\OneDrive\Metiri - Documents\Projects\2021\210171\04 - CADD\Drawings\Civil Engineering Plans\ PLOT DATE: 21/07/2022

NOTES

ROAD PAVEMENT

- ROAD PAVEMENT CONSTRUCTION IS TO BE CARRIED OUT IN ACCORDANCE WITH THE APPROVED GEOTECHNICAL REPORT (REF: NEW2IP-0138-AA.rev1, DATE: 01/07/22) BY QUALTEST. IF THE STANDARD OR REQUIREMENTS FOR WORK SHOWN ON THE DRAWINGS DIFFER FROM THAT REQUIRED BY THE APPROVED GEOTECHNICAL REPORT, THE REQUIREMENTS OF THE GEOTECHNICAL REPORT WILL GENERALLY PREVAIL. CLARIFICATION SHALL BE SOUGHT FROM METIRI SHOULD DISCREPANCIES ARISE.
- INSPECTION SHOULD BE CARRIED OUT BY A GEOTECHNICAL AUTHORITY DURING CONSTRUCTION TO VERIFY THE CONDITIONS ASSUMED IN THE GEOTECHNICAL REPORT AND IN THE DESIGN.
- CONCRETE ROAD PAVEMENT TO HAVE A COMPRESSIVE STRENGTH OF 32MPa (MIN.).
- CONCRETE ROAD PAVEMENT TO BE REINFORCED WITH SL82 MESH TOP AND BOTTOM WITH N12 PERIMETER BAR ALONG ALL EDGES.
- REFER TO PAVEMENT JOINT PLAN FOR JOINT LAYOUT.

KERB & GUTTER

- ALL EXPOSED KERB EDGES ARE TO BE ROUNDED TO 20mm RADIUS.
- ALL KERB IS TO BE CONSTRUCTED WITH 25MPa CONCRETE.
- CONTROL JOINTS ARE TO BE PROVIDED EVERY 2.5-3.0m AND EXPANSION JOINTS TO BE PROVIDED EVERY 15m AND AT EVERY LAYBACK, LINTEL AND KERB RAMP.

SUBSOIL DRAINAGE

- MINIMUM SUBSOIL TRENCH DEPTH IS TO BE 600MM IN EARTH AND 450MM IN ROCK.
- TRENCHES ARE TO BE LOCATED BELOW INVERT LEVEL OF ANY SERVICE CROSSINGS.
- PAVEMENT LAYERS ARE TO EXTEND TO AT LEAST THE LINE OF THE REAR OF THE TRENCH.
- MINIMUM LONGITUDINAL GRADE IS 1.0%. FOR NON-CORRUGATED PIPES, AN ABSOLUTE MINIMUM GRADE OF 0.5% IS ACCEPTABLE.
- CLEANOUT POINTS ARE TO BE PROVIDED AT THE COMMENCEMENT OF EACH RUN OF SUBSOIL DRAINAGE LINE AND AT INTERVALS NOT EXCEEDING 80m.

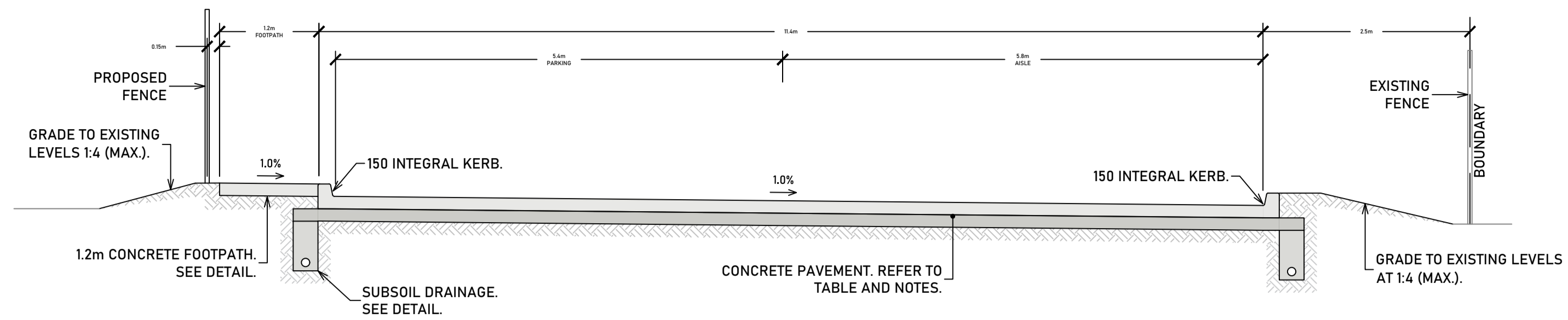

TYPICAL SECTION - CAR PARKS (90° PARKS)
NTS

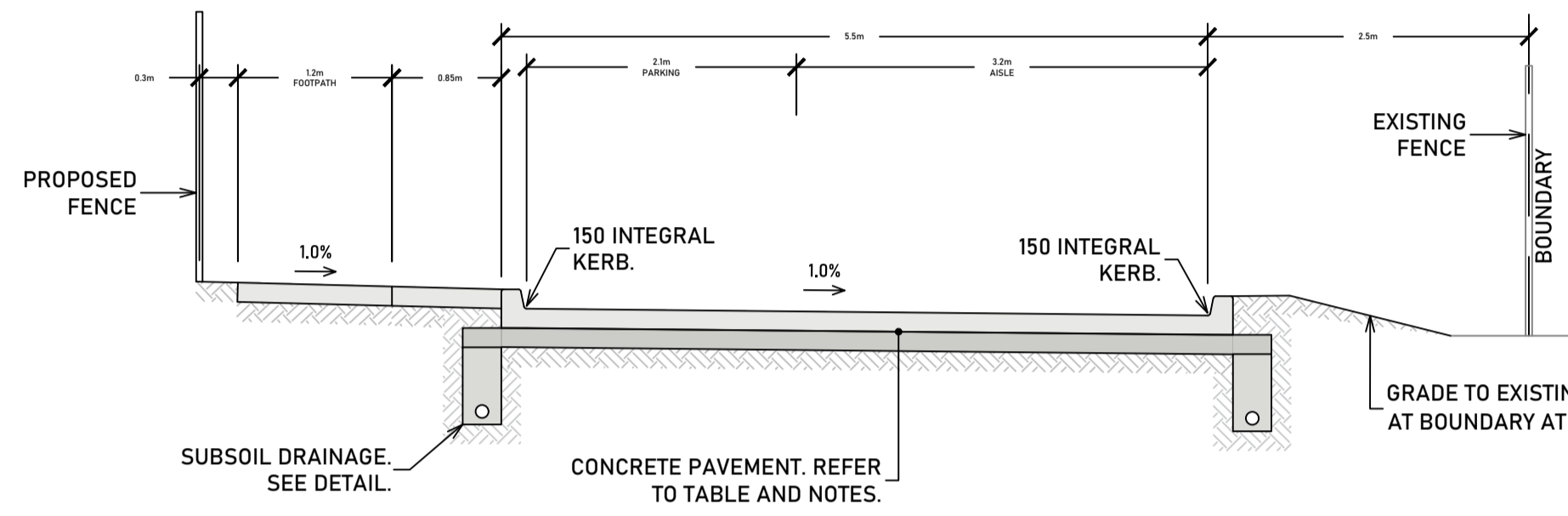

TYPICAL SECTION - CAR PARKS (PARALLEL PARKS)
NTS

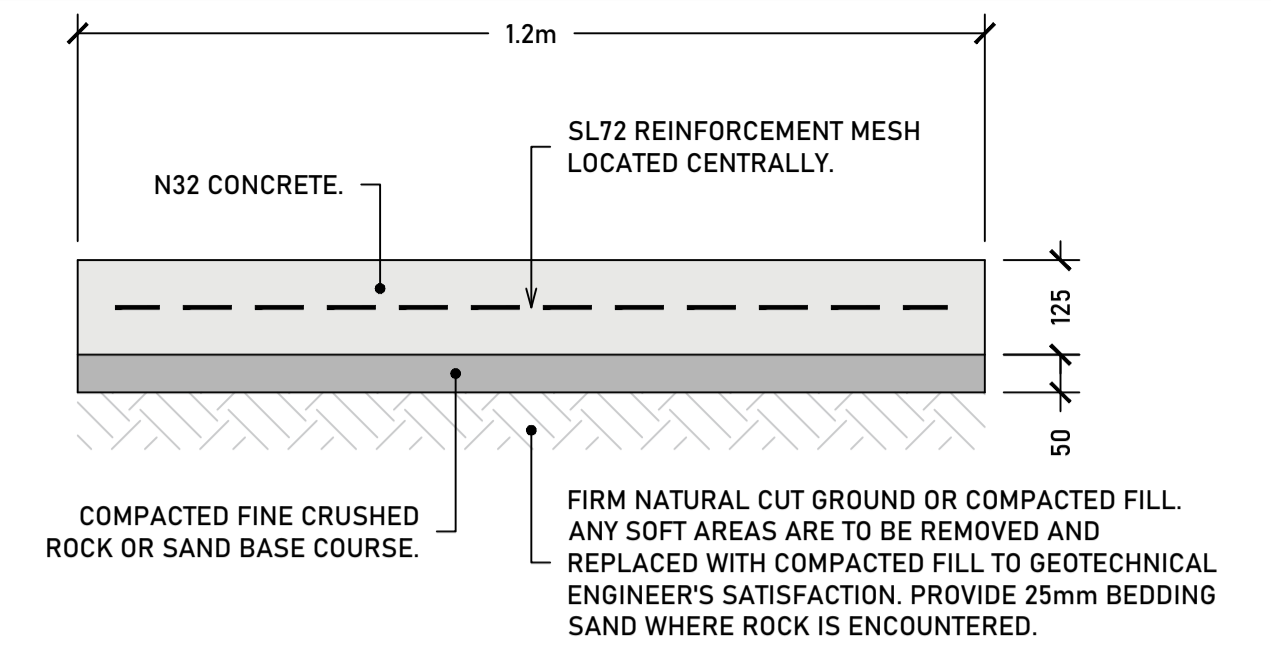

- NOTES:
- PROVIDE TOOLED CONTROL JOINTS AT 1.5m INTERVALS. CUT EVERY SECOND BAR AT JOINT.
 - PROVIDE PROPRIETARY EXPANSION JOINTS (CONNOLLY OR EQUIVALENT) AT 6.0m INTERVALS. INSTALL IN ACCORDANCE WITH MANUFACTURER'S SPECIFICATIONS.
 - JOINTS TO EXISTING CONCRETE FOOTPATHS TO BE DOWELLED WITH R12 DOWELS, 300mm LONG AT 300mm CENTRES.
 - ALL FINISHED SURFACES ARE TO BE NON-SLIP AND MAINTAIN AN EVEN SURFACE.

DETAIL - CONCRETE FOOTPATH
NTS

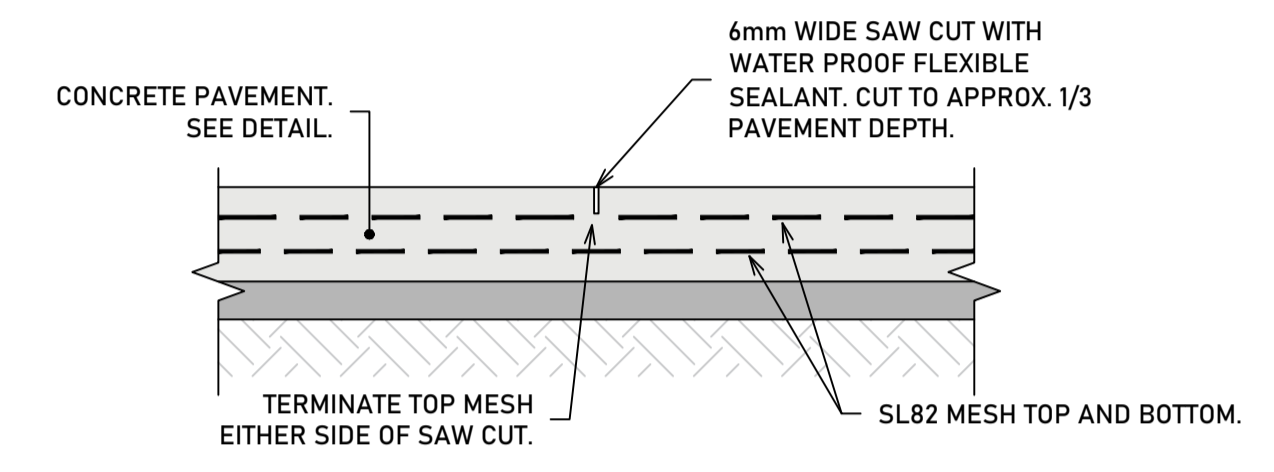

DETAIL - SAW CUT JOINT
NTS

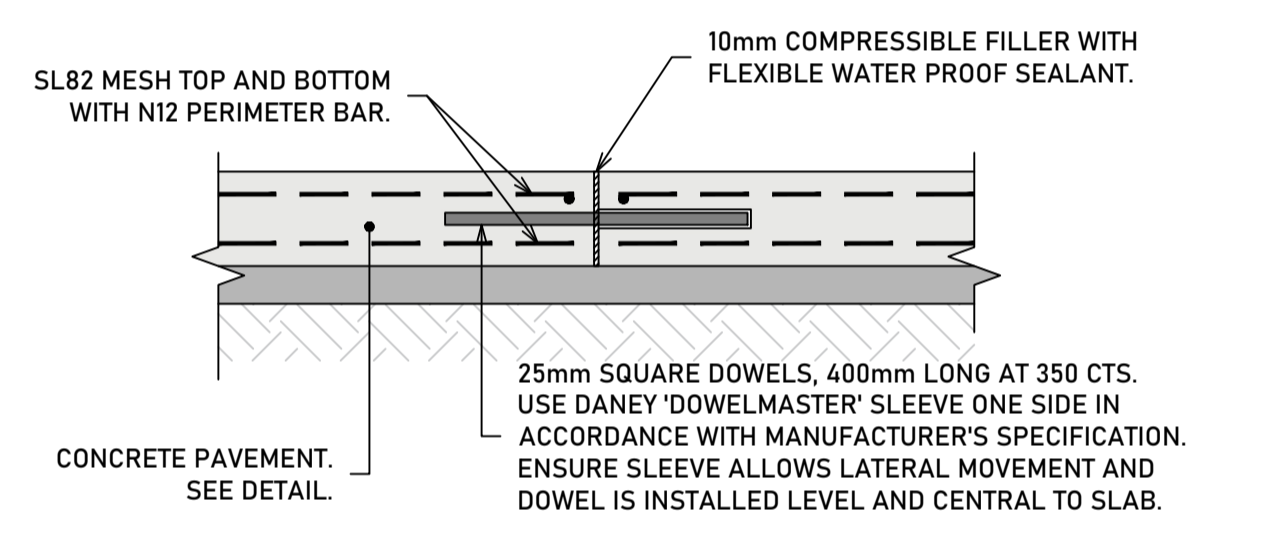

DETAIL - EXPANSION JOINT
NTS

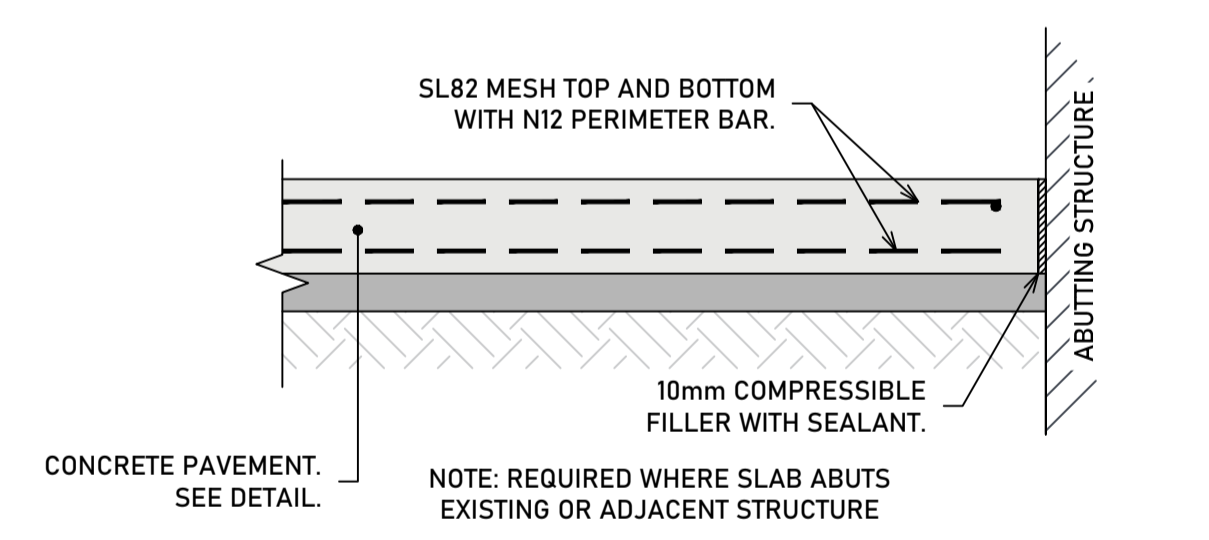

DETAIL - ISOLATION JOINT
NTS

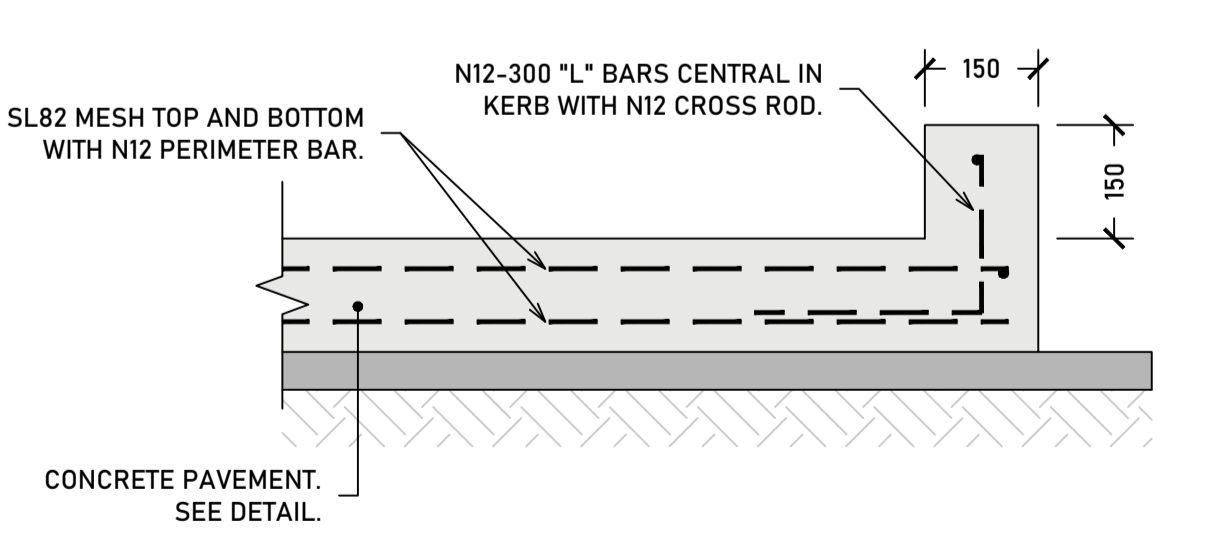

DETAIL - INTEGRAL KERB
NTS

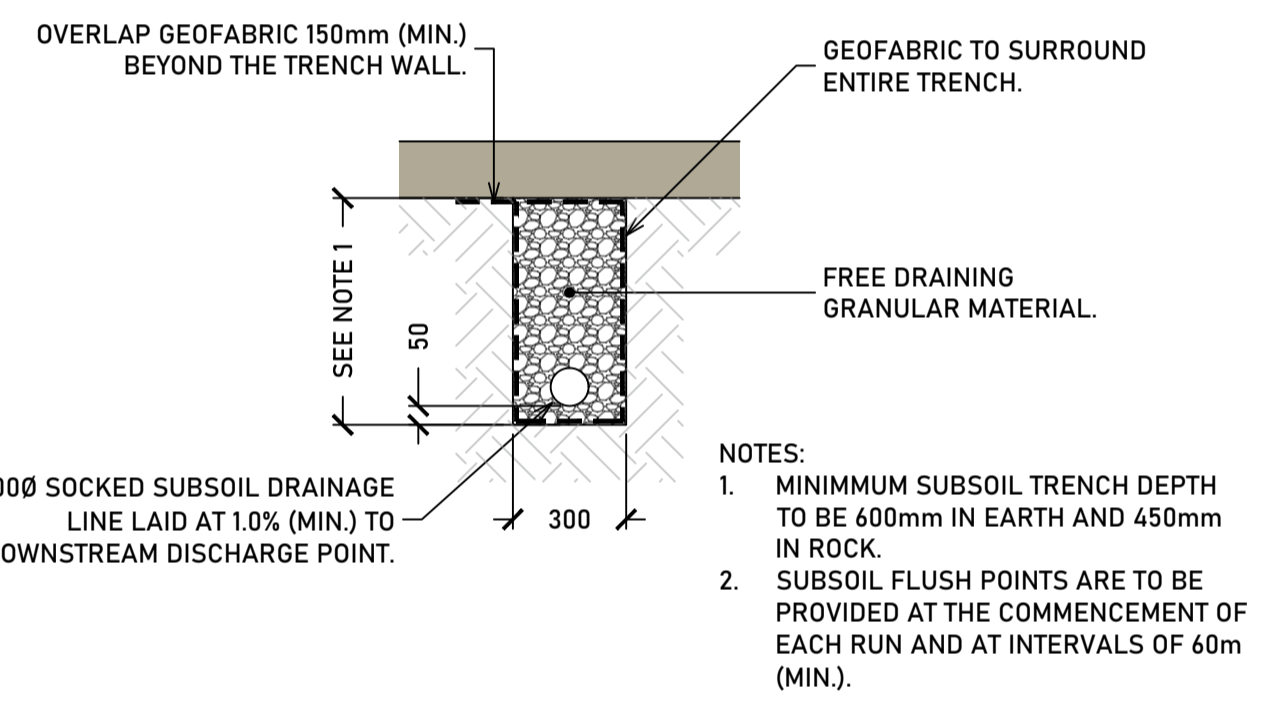

DETAIL - SUBSOIL DRAINAGE TRENCH
NTS

MINIMUM EMBEDMENT ZONE DIMENSIONS (AS2566.2-2002)

DN	Lb	Lc	Lo	B = DN + 2Lc
≥75, ≤150	75	100	100	275-350
>150, ≤300	100	150	150	450-600
>300, ≤450	100	200	150	700-850
>450, ≤900	150	300	150	1050-1500

- NOTES:
- PLACEMENT OF EMBEDMENT, TRENCH FILL & COMPACTION SHALL BE IN ACCORDANCE WITH AS2566.2-2002.
 - PIPE EMBEDMENT MATERIAL SHALL COMPLY WITH AS2566.2-2002 - APPENDIX G.
 - GEOTEXTILE FILTER FABRIC, WHERE SPECIFIED, SHALL COMPLY WITH AS2566.2-2002 - APPENDIX J.
 - WHERE THERE IS A POSSIBILITY OF MIGRATION OF FINES BETWEEN THE NATIVE SOIL AND THE EMBEDMENT ZONE, THE ENTIRE EMBEDMENT ZONE SHALL BE WRAPPED IN GEOTEXTILE FABRIC.
 - EXCAVATE OR COMPACT TRENCH FLOOR TO PROVIDE A FLAT FIRM BASE TO SUPPORT BEDDING MATERIAL AND MINIMISE PIPELINE SETTLEMENT.

DETAIL - STORMWATER DRAINAGE TRENCH
NTS

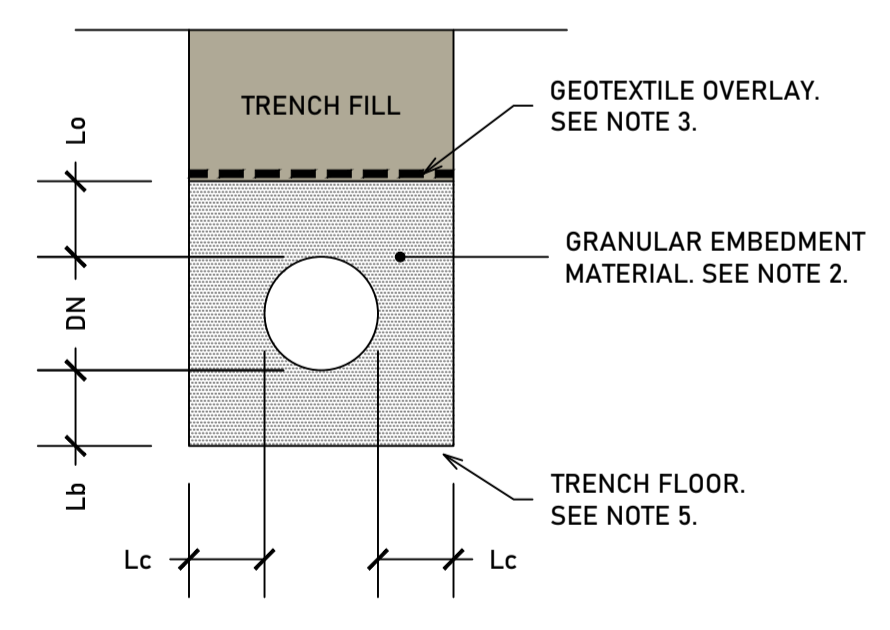

DETAIL - STORMWATER DRAINAGE TRENCH
NTS

PAVEMENT THICKNESS SUMMARY

ROAD SECTION	CAR PARK/ACCESS DRIVEWAY			
DESIGN TRAFFIC LOADING (ESA'S)	3.33 x 10 ⁶			
SUB-BASE OPTION	UNBOUND	BOUND	UNBOUND	BOUND
DESIGN SUBGRADE CBR (%)	3.0	3.0	5.0	5.0
CONCRETE BASE (mm)	195	180	185	170
SUB-BASE	125	125	125	125
TOTAL THICKNESS (mm)	320	305	310	295

REFER TO THE APPROVED GEOTECHNICAL REPORT (REF: NEW2IP-0138-AA.rev1, DATE: 01/07/22) BY QUALTEST FOR ADDITIONAL INFORMATION.

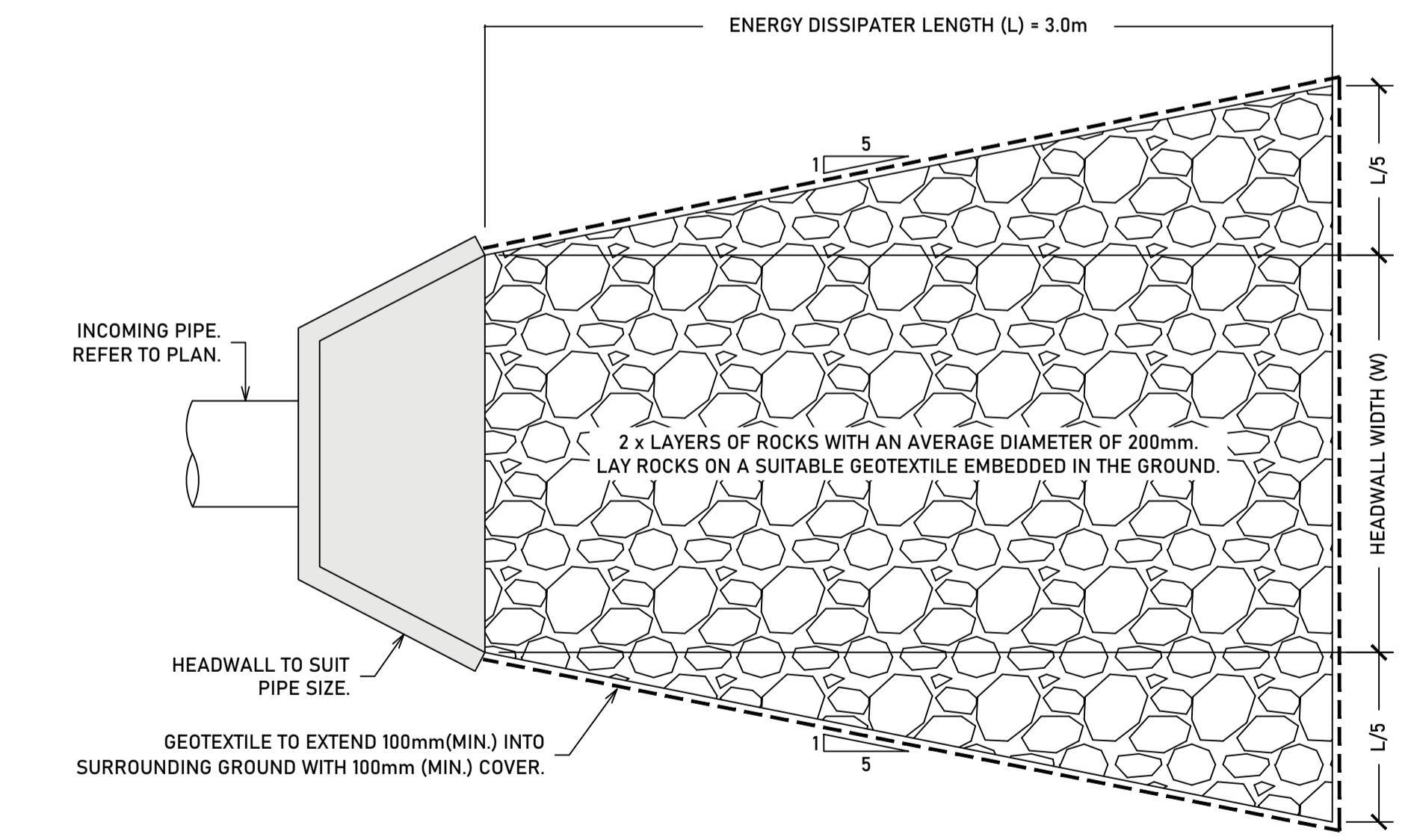

DETAIL - ROCK ENERGY DISSIPATER
NTS

CONSTRUCTION ISSUE

REV.	REVISION DETAILS	DES	DWN	CHK	DATE
0	PRELIMINARY ISSUE FOR REVIEW	JRR	DBM	JRR	07/06/22
1	AMENDMENTS	JRR	DBM	JRR	22/06/22
2	MINOR AMENDMENTS	JRR	DBM	JRR	24/06/22
3	ADDED TREE REMOVAL PLAN AND OTHER MINOR AMENDMENTS	JRR	DBM	JRR	28/06/22
4	CONCRETE PAVEMENT DETAILS ADDED.	JRR	DBM	JRR	13/07/22
5	AMENDMENTS	JRR	JRR	JRR	21/07/22

SURVEYED	
METIRI	
DATUM	SCALE
AHD	

PROJECT	CIVIL ENGINEERING PLANS WOODBERRY LEARNING CENTRE CAR PARK UPGRADES LOT 1 DP 557998 WOODBERRY ROAD, WOODBERRY
CLIENT	NSW DEPARTMENT OF EDUCATION

SHEET TITLE			
TYPICAL SECTIONS & DETAILS			
PROJECT NUMBER	SHEET NUMBER	TOTAL SHEETS	REVISION
210171	06	12	5

FILE PATH: C:\OneDrive\Metiri Consultants Pty Ltd\Metiri - Documents\Projects\2021\2107104 - CADD\Drawings\Civil Engineering Plans

PLOT DATE: 21/07/2022

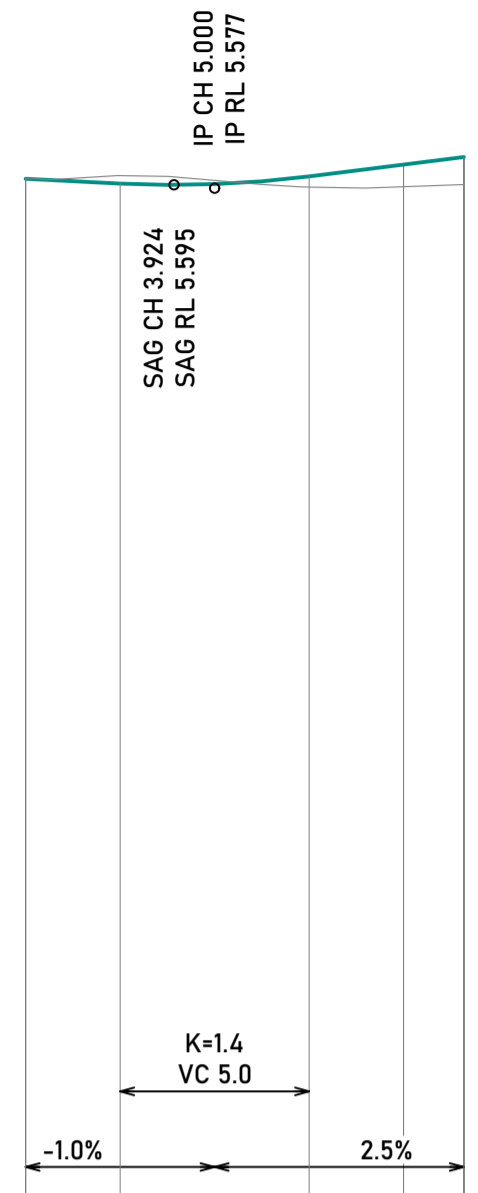

PROPOSED LEVELS	5.627	5.602	5.596	5.599	5.640	5.703	5.743
EXISTING LEVELS	5.627	5.644	5.632	5.619	5.584	5.586	5.597
LEVEL DIFFERENCE	0.000	-0.042	-0.036	-0.020	0.056	0.117	0.146
CHAINAGE	0.000	2.500	4.277	5.000	7.500	10.000	11.594

CL1 PROFILE
(5x VERTICAL EXAGGERATION)

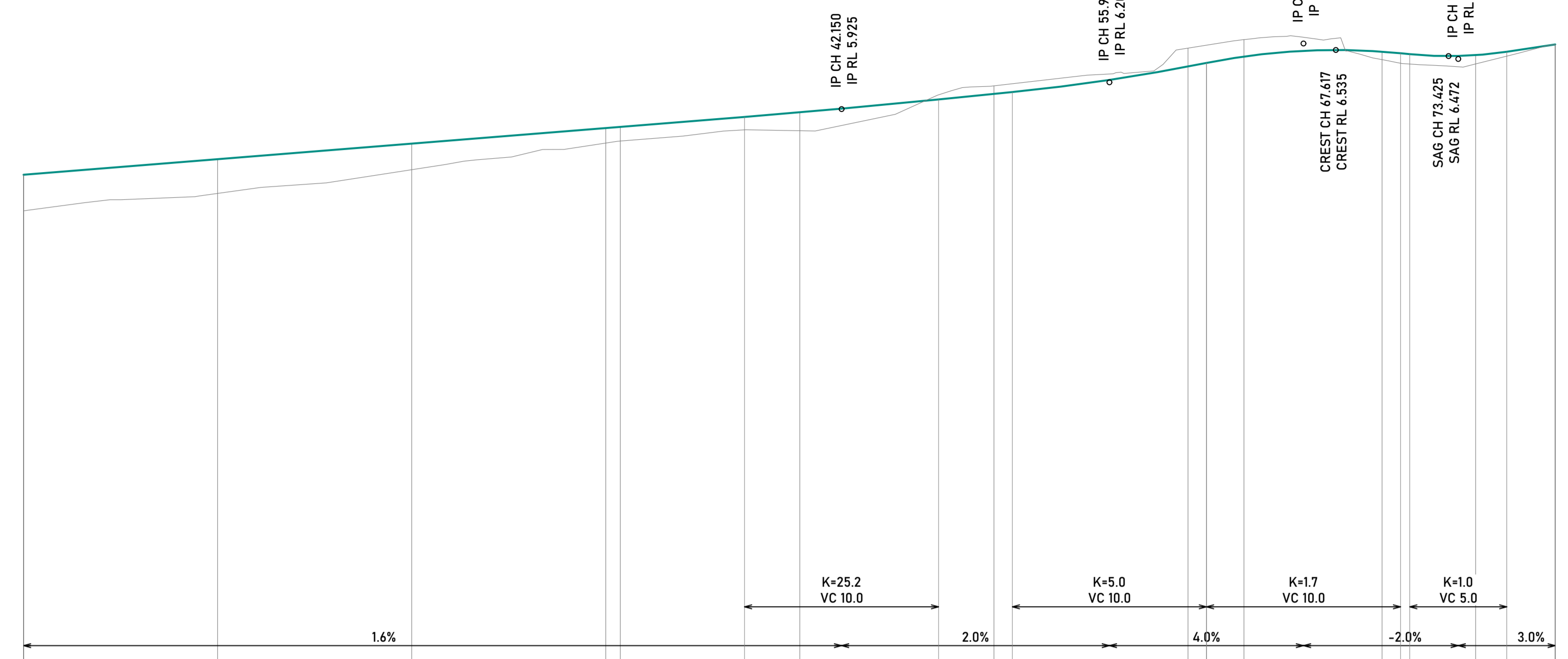

PROPOSED LEVELS	5.250	5.410	5.570	5.731	5.743	5.845	5.893	5.930	6.025	6.082	6.101	6.226	6.364	6.401	6.468	6.526	6.518	6.501	6.492	6.472	6.473	6.482	6.517	6.592
EXISTING LEVELS	4.878	5.058	5.302	5.576	5.597	5.712	5.703	5.757	6.073	6.166	6.187	6.288	6.554	6.584	6.642	6.666	6.436	6.398	6.390	6.369	6.362	6.391	6.471	6.592
LEVEL DIFFERENCE	0.372	0.352	0.269	0.154	0.146	0.133	0.190	0.174	-0.048	-0.083	-0.086	-0.062	-0.189	-0.183	-0.174	-0.140	0.082	0.103	0.102	0.103	0.111	0.090	0.046	0.000
CHAINAGE	0.000	10.000	20.000	30.000	30.750	37.150	40.000	42.150	47.150	50.000	50.949	55.950	60.000	60.949	62.882	65.950	70.000	70.951	71.425	73.425	73.925	74.820	76.425	78.925

CL2 PROFILE
(5x VERTICAL EXAGGERATION)

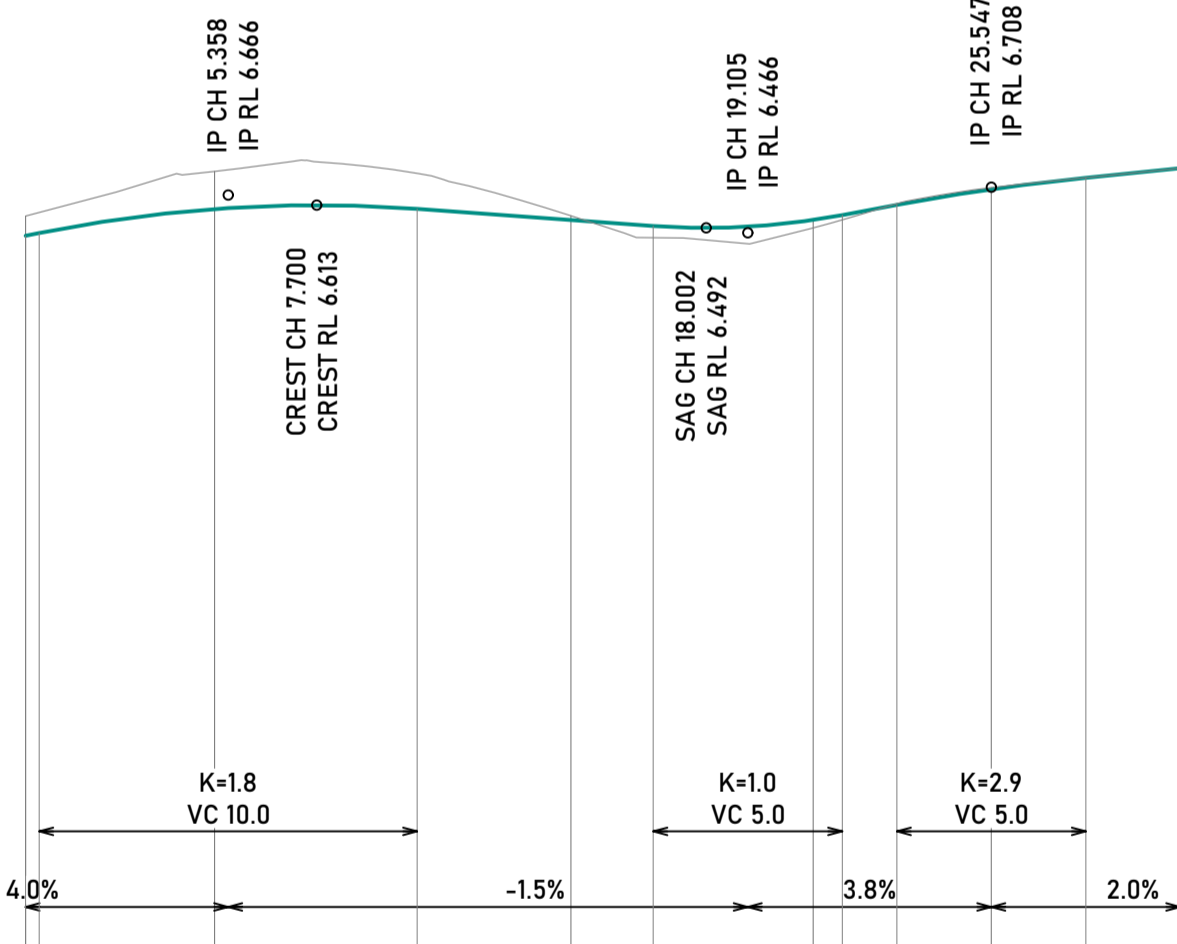

PROPOSED LEVELS	6.451	6.583	6.608	6.605	6.598	6.534	6.493	6.529	6.577	6.618	6.659	6.789	6.789	6.797
EXISTING LEVELS	6.555	6.778	6.818	6.809	6.792	6.557	6.420	6.483	6.562	6.626	6.659	6.789	6.789	6.797
LEVEL DIFFERENCE	-0.104	-0.195	-0.210	-0.204	-0.194	-0.023	0.073	0.046	0.015	-0.008	-0.001	0.000	0.000	0.000
CHAINAGE	0.000	4.410	9.050	9.408	10.000	14.410	18.475	20.654	22.052	23.155	24.000	25.654	27.098	29.597

KR 1-LIP PROFILE
(5x VERTICAL EXAGGERATION)

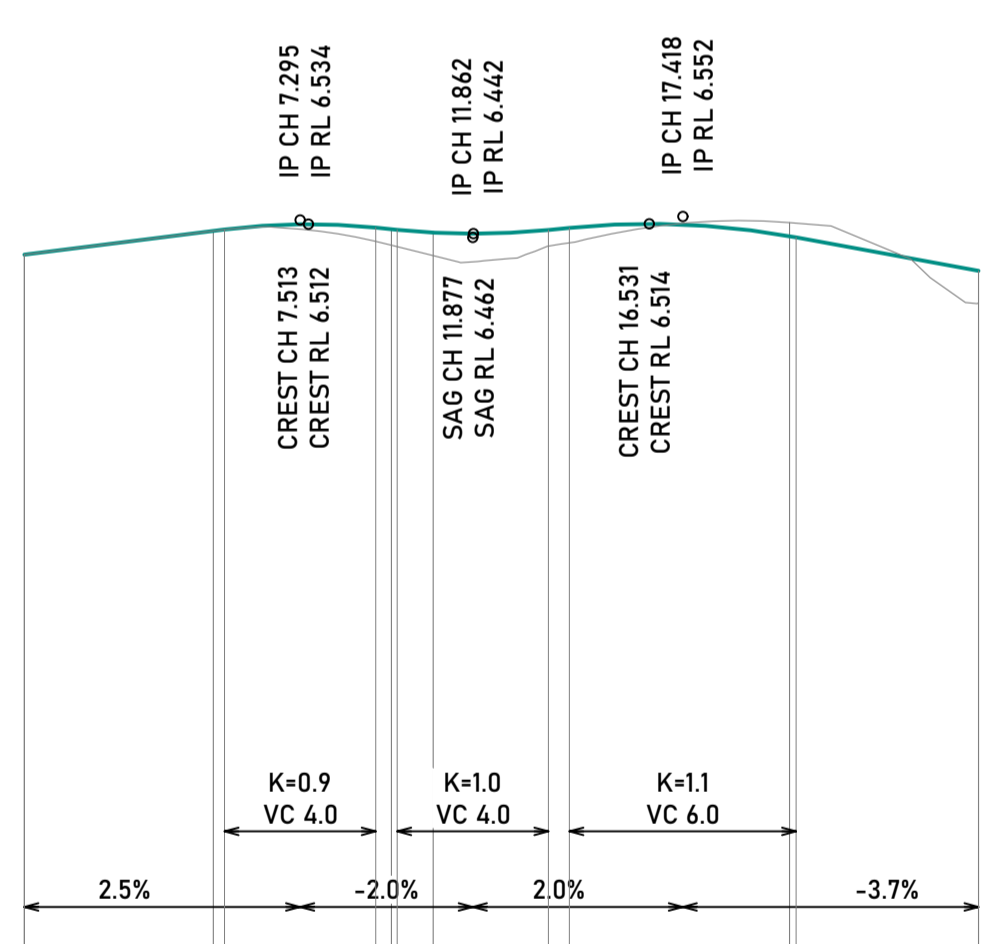

PROPOSED LEVELS	6.351	6.476	6.484	6.511	6.494	6.485	6.485	6.485	6.482	6.482	6.493	6.510	6.423	6.442
EXISTING LEVELS	6.351	6.476	6.484	6.511	6.494	6.485	6.485	6.485	6.482	6.482	6.493	6.510	6.423	6.442
LEVEL DIFFERENCE	0.000	0.000	0.001	0.026	0.001	0.000	0.000	0.000	0.003	0.003	0.001	0.000	-0.066	-0.075
CHAINAGE	0.000	5.000	5.295	7.295	9.295	9.712	9.862	10.000	10.817	11.862	11.782	13.862	17.429	20.949

KR 2-LIP PROFILE
(5x VERTICAL EXAGGERATION)

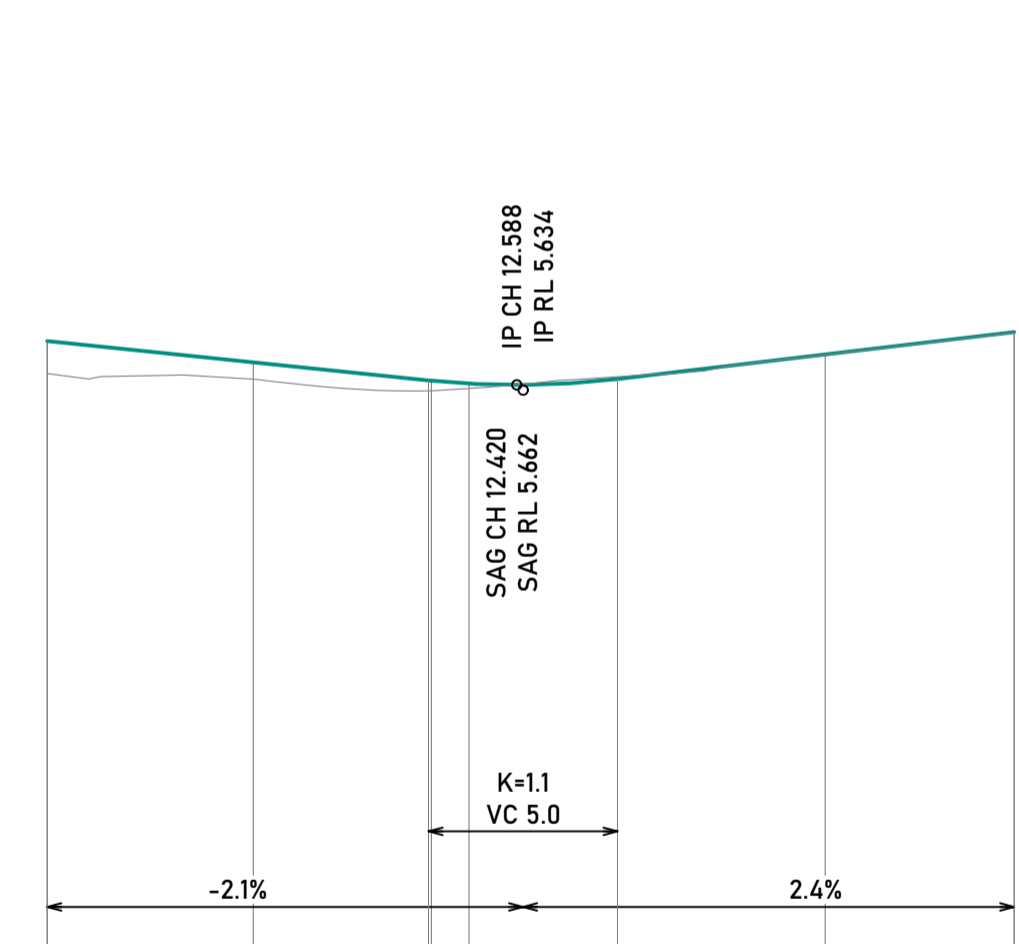

PROPOSED LEVELS	5.894	5.791	5.687	5.681	5.679	5.666	5.662	5.679
EXISTING LEVELS	5.721	5.697	5.630	5.634	5.679	5.666	5.671	5.679
LEVEL DIFFERENCE	0.172	0.093	0.057	0.048	0.020	-0.005	-0.008	0.000
CHAINAGE	0.000	5.000	10.000	10.345	10.419	11.413	12.845	15.345

KR 3-LIP PROFILE
(5x VERTICAL EXAGGERATION)

CONSTRUCTION ISSUE

REV.	REVISION DETAILS	DES	DWN	CHK	DATE
0	PRELIMINARY ISSUE FOR REVIEW	JRR	DBM	JRR	07/06/22
1	AMENDMENTS	JRR	DBM	JRR	22/06/22
2	MINOR AMENDMENTS	JRR	DBM	JRR	24/06/22
3	ADDED TREE REMOVAL PLAN AND OTHER MINOR AMENDMENTS	JRR	DBM	JRR	28/06/22
4	CONCRETE PAVEMENT DETAILS ADDED.	JRR	DBM	JRR	13/07/22
5	AMENDMENTS	JRR	JRR	JRR	21/07/22

SURVEYED
METIRI

DATUM: AHD SCALE: 1:200

10.00 0 5.00 10.00

SCALE @ A1

Metiri
Engineers • Surveyors • Planners

ABN 86 633 598 875 ACN 633 598 875
5/33 The Boulevard, Toronto NSW 2283
4950 5995 mail@metiri.com.au metiri.com.au

PROJECT
CIVIL ENGINEERING PLANS
WOODBERRY LEARNING CENTRE CAR PARK UPGRADES
LOT 1 DP 557998
WOODBERRY ROAD, WOODBERRY

CLIENT
NSW DEPARTMENT OF EDUCATION

SHEET TITLE ROAD PROFILES - SHEET 1			
PROJECT NUMBER 210171	SHEET NUMBER 07	TOTAL SHEETS 12	REVISION 5

FILE PATH: C:\OneDrive\Metiri Consultants Pty Ltd\Metiri - Documents\Projects\2021\2107\04 - CADD\Drawings\Civil Engineering Plans\ PLOT DATE: 21/07/2022

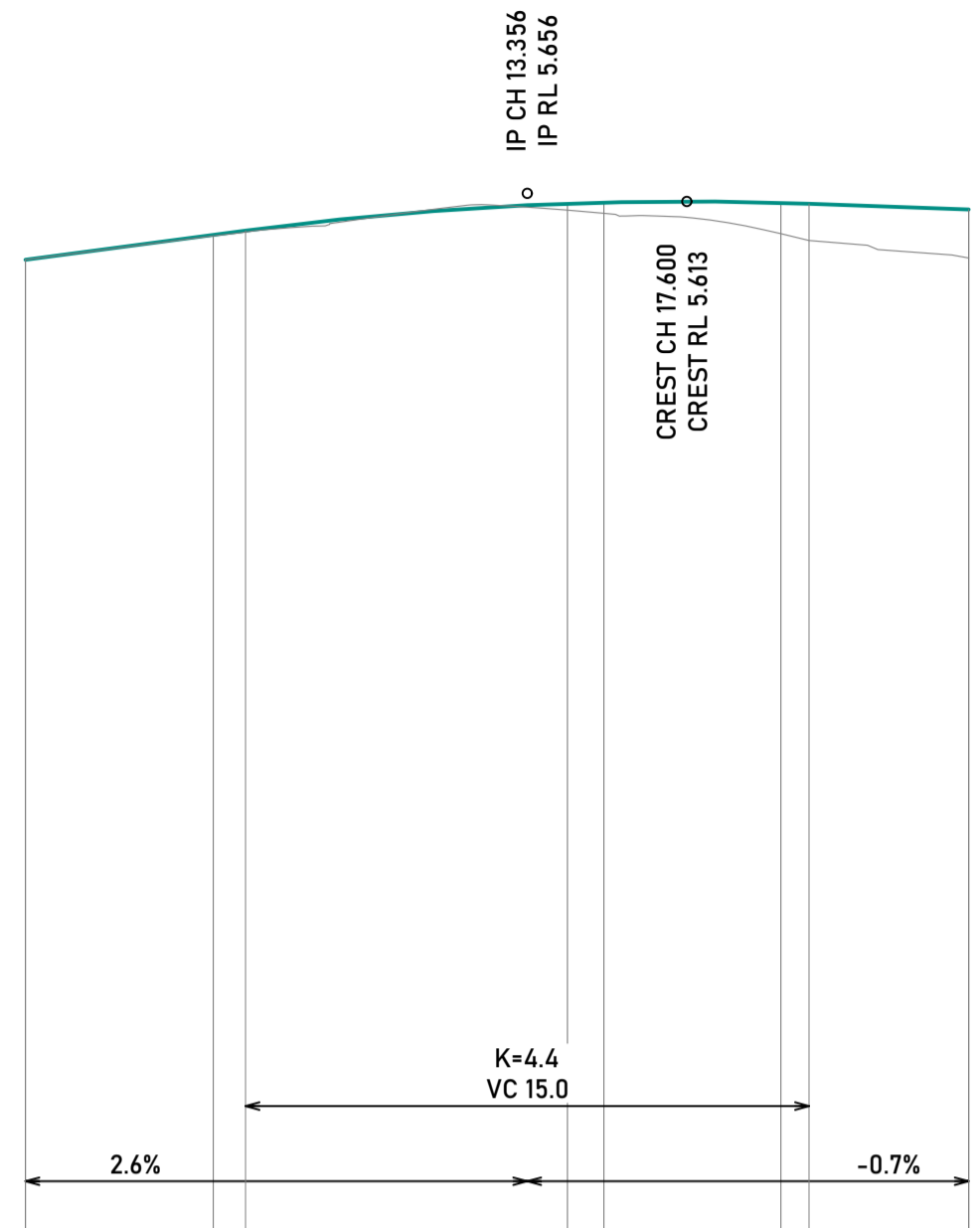

	0.000	5.000	7.796	10.000	15.295	14.425	15.394	20.000	20.814	22.796	25.814
PROPOSED LEVELS	5.302	5.435	5.505	5.548	5.607	5.602	5.607	5.606	5.601	5.597	
EXISTING LEVELS	5.302	5.430	5.482	5.548	5.552	5.566	5.550	5.466	5.407	5.355	
LEVEL DIFFERENCE	0.000	0.005	0.023	-0.001	0.055	0.035	0.057	0.140	0.194	0.232	
CHAINAGE	0.000	5.000	7.796	10.000	15.295	14.425	15.394	20.000	20.814	22.796	25.814

KR 4-LIP PROFILE
(5x VERTICAL EXAGGERATION)

CONSTRUCTION ISSUE

REV.	REVISION DETAILS	DES	DWN	CHK	DATE
0	PRELIMINARY ISSUE FOR REVIEW	JRR	DBM	JRR	07/06/22
1	AMENDMENTS	JRR	DBM	JRR	22/06/22
2	MINOR AMENDMENTS	JRR	DBM	JRR	24/06/22
3	ADDED TREE REMOVAL PLAN AND OTHER MINOR AMENDMENTS	JRR	DBM	JRR	28/06/22
4	CONCRETE PAVEMENT DETAILS ADDED.	JRR	DBM	JRR	13/07/22
5	AMENDMENTS	JRR	JRR	JRR	21/07/22

SURVEYED
METIRI

DATUM
AHD

SCALE
1:200

10.00 0 5.00 10.00
SCALE @ A1

Metiri
Engineers • Surveyors • Planners

ABN 86 633 598 875 ACN 633 598 875
5/33 The Boulevard, Toronto NSW 2283
4950 5995 mail@metiri.com.au metiri.com.au

PROJECT
**CIVIL ENGINEERING PLANS
WOODBERRY LEARNING CENTRE CAR PARK UPGRADES
LOT 1 DP 557998
WOODBERRY ROAD, WOODBERRY**

CLIENT
NSW DEPARTMENT OF EDUCATION

SHEET TITLE
ROAD PROFILES - SHEET 2

PROJECT NUMBER 210171	SHEET NUMBER 08	TOTAL SHEETS 12	REVISION 5
---------------------------------	---------------------------	---------------------------	----------------------

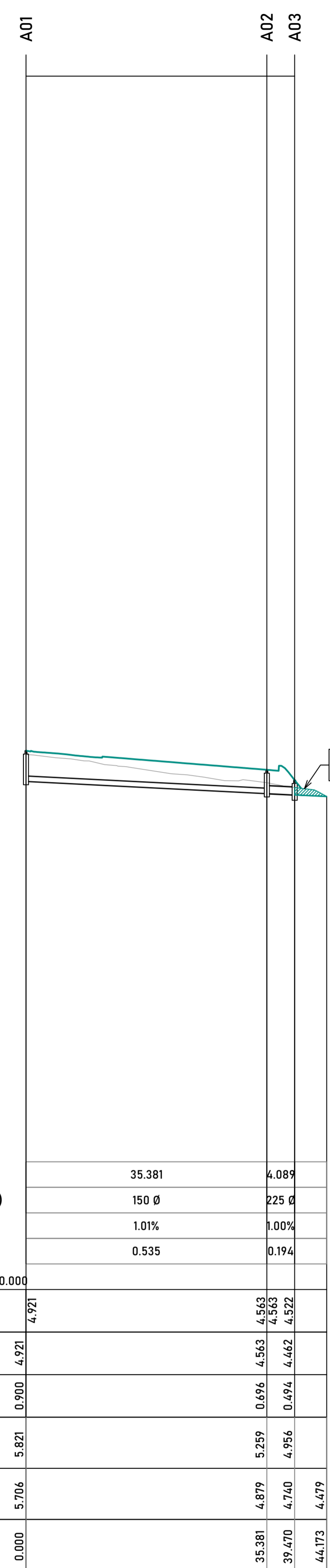

PIT SCHEDULE											
PIT NO.	PIT TYPE	PIT LENGTH	PIT WIDTH	INLET Ø	INLET INV	OUTLET Ø	OUTLET INV	PIT FSL	PIT DEPTH	EASTING	NORTHING
A01	PRE-CAST CONCRETE PIT - GRATED COVER	600	600			150	4.921	5.821	0.900	375637.107	6370984.230
A02	PRE-CAST CONCRETE PIT - GRATED COVER	600	600	150	4.563	225	4.563	5.259	0.696	375636.459	6370948.855
A03	CONCRETE HEADWALL TO SUIT PIPE SIZE	600	600	225	4.522			4.956	0.494	375639.591	6370946.226

PIPE SCHEDULE							
U/S PIT	D/S PIT	PIPE TYPE	PIPE Ø	PIPE LENGTH	PIPE GRADE	U/S INV	D/S INV
A01	A02	uPVC-SN4	150	35.381	1.01%	4.921	4.563
A02	A03	uPVC-SN4	225	4.089	1.00%	4.563	4.522

PIPE LENGTH (m)	35.381	4.089
PIPE DIAMETER (mm)	150 Ø	225 Ø
PIPE GRADE (%)	1.01%	1.00%
PIPE MIN. COVER (m)	0.535	0.194
DATUM -10.000		
PIPE INVERT LEVEL	4.921	4.563 4.563 4.522
PIT INVERT LEVEL	4.921	4.563 4.462
PIT DEPTH	0.900	0.696 0.494
PROPOSED LEVELS	5.821	5.259 4.956
EXISTING LEVELS	5.706	4.879 4.740 4.479
CHAINAGE	0.000	35.381 39.470 44.173

DRAINAGE LINE A PROFILE
(5x VERTICAL EXAGGERATION)

CONSTRUCTION ISSUE

FILE PATH: C:\OneDrive\Metiri Consultants Pty Ltd\Metiri - Documents\Projects\2021\2107\04 - CADD\Drawings\Civil Engineering Plans\ PLOT DATE: 21/07/2022

REV.	REVISION DETAILS	DES	DWN	CHK	DATE
0	PRELIMINARY ISSUE FOR REVIEW	JRR	DBM	JRR	07/06/22
1	AMENDMENTS	JRR	DBM	JRR	22/06/22
2	MINOR AMENDMENTS	JRR	DBM	JRR	24/06/22
3	ADDED TREE REMOVAL PLAN AND OTHER MINOR AMENDMENTS	JRR	DBM	JRR	28/06/22
4	CONCRETE PAVEMENT DETAILS ADDED.	JRR	DBM	JRR	13/07/22
5	AMENDMENTS	JRR	JRR	JRR	21/07/22

SURVEYED
METIRI

DATUM: AHD SCALE: 1:500

SCALE @ A1

Metiri
Engineers • Surveyors • Planners





ABN 86 633 598 875 ACN 633 598 875
5/33 The Boulevard, Toronto NSW 2283
4950 5995 mail@metiri.com.au metiri.com.au

PROJECT
CIVIL ENGINEERING PLANS
WOODBERRY LEARNING CENTRE CAR PARK UPGRADES
LOT 1 DP 557998
WOODBERRY ROAD, WOODBERRY

CLIENT
NSW DEPARTMENT OF EDUCATION

SHEET TITLE			
STORMWATER DRAINAGE PROFILES & SCHEDULES			
PROJECT NUMBER	SHEET NUMBER	TOTAL SHEETS	REVISION
210171	09	12	5

LEGEND

	SAW CUT JOINT. SEE DETAIL.
	EXPANSION JOINT. SEE DETAIL.
	2N12 TRIMMER TO EXTEND MIN. 1.0m BEYOND SIDES OF PIT.
	+50mm SLAB THICKENING 2.0m AROUND PIT.

NOTES

- REFER TO TYPICAL SECTIONS AND DETAILS SHEET FOR PAVEMENT AND JOINT DETAILS.

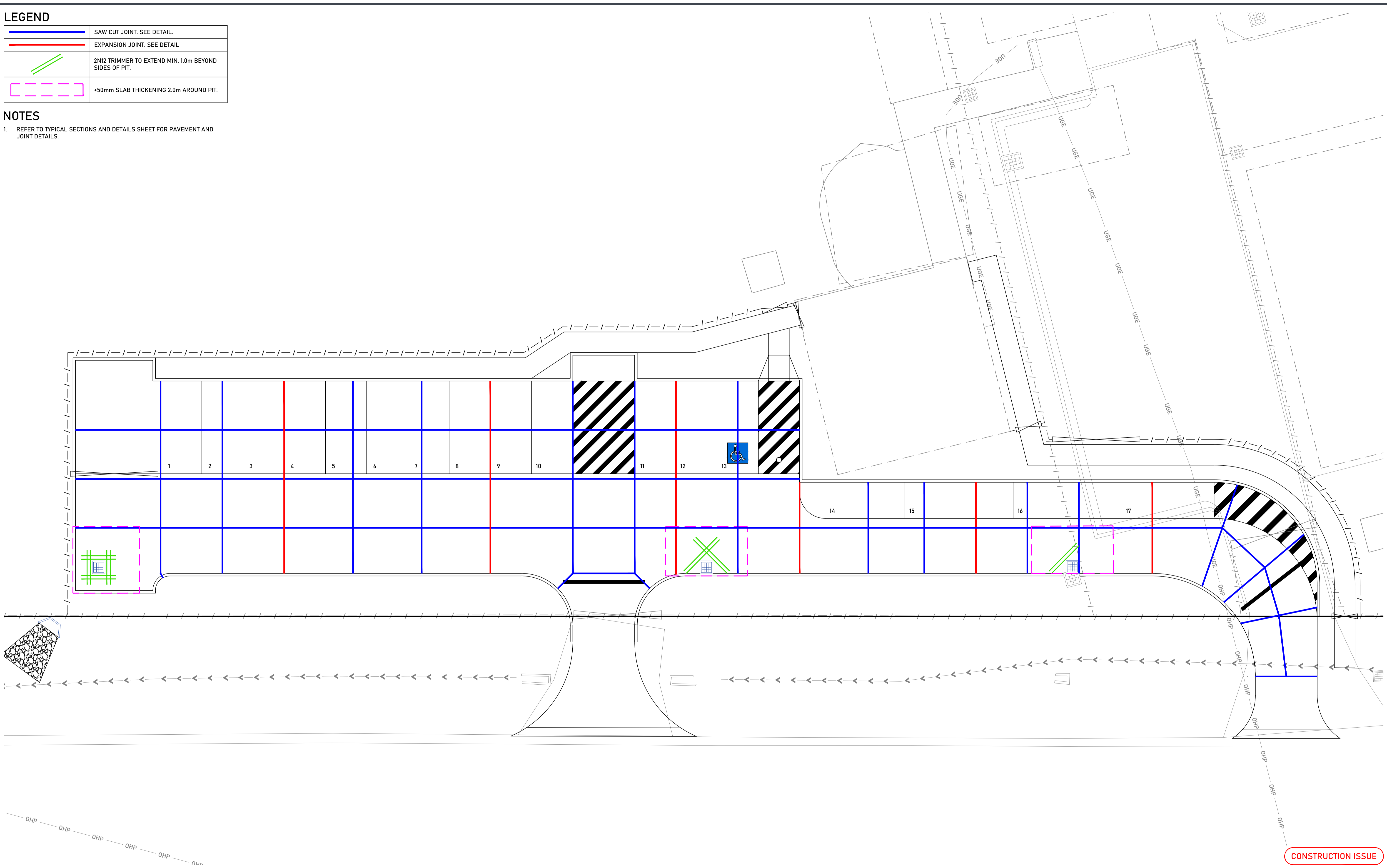

REV.	REVISION DETAILS	DES	DWN	CHK	DATE
0	PRELIMINARY ISSUE FOR REVIEW	JRR	DBM	JRR	07/06/22
1	AMENDMENTS	JRR	DBM	JRR	22/06/22
2	MINOR AMENDMENTS	JRR	DBM	JRR	24/06/22
3	ADDED TREE REMOVAL PLAN AND OTHER MINOR AMENDMENTS	JRR	DBM	JRR	28/06/22
4	CONCRETE PAVEMENT DETAILS ADDED.	JRR	DBM	JRR	13/07/22
5	AMENDMENTS	JRR	JRR	JRR	21/07/22

METIRI

DATUM: **AHD** SCALE: **1:100**

SCALE @ A1

Metiri
Engineers • Surveyors • Planners

ABN 86 633 598 875 ACN 633 598 875
5/33 The Boulevard, Toronto NSW 2283
4950 5995 mail@metiri.com.au metiri.com.au

PROJECT	CIVIL ENGINEERING PLANS WOODBERRY LEARNING CENTRE CAR PARK UPGRADES LOT 1 DP 557998 WOODBERRY ROAD, WOODBERRY		
CLIENT	NSW DEPARTMENT OF EDUCATION		

SHEET TITLE			
PAVEMENT JOINT PLAN			
PROJECT NUMBER	SHEET NUMBER	TOTAL SHEETS	REVISION
210171	10	12	5

FILE PATH: C:\OneDrive\Metiri Consultants Pty Ltd\Metiri - Documents\Projects\2021\210171\04 - CADD\Drawings\Civil Engineering Plans\ PLOT DATE: 21/07/2022

LEGEND

	LINEMARKING (PROPOSED GENERAL)
	LINEMARKING (EXISTING)
	SIGNPOST (PROPOSED)
	MOUNTED SIGN (PROPOSED)

NOTES

LINE MARKING AND SIGNPOSTING

- CAR PARK LINE MARKING AND SIGNPOSTING SHALL COMPLY WITH AS2890.
- ALL PAVEMENT MARKINGS SHALL HAVE A SLIP RESISTANT SURFACE.
- PARKING SPACES OTHER THAN THOSE FOR PEOPLE WITH DISABILITIES SHALL BE DELINEATED BY WHITE OR YELLOW LINES 80-100mm WIDE IN ACCORDANCE WITH AS2890.1.
- DEDICATED DISABILITY ACCESS SPACES SHALL BE DELINEATED BY YELLOW LINES 80-100mm WIDE IN ACCORDANCE WITH AS2890.6.
- SHARED AREAS SHALL BE DELINEATED AS ABOVE AND MARKED WITH DIAGONAL STRIPES 150-200mm WIDE WITH SPACES 200-300mm BETWEEN STRIPES. THE STRIPES SHALL BE AT AN ANGLE OF 45 +/- 10 DEGREES TO THE SIDE OF THE SPACE.
- DEDICATED DISABILITY ACCESS SPACES SHALL BE IDENTIFIED BY MEANS OF A WHITE SYMBOL OF ACCESS IN ACCORDANCE WITH AS 1428.1 BETWEEN 0.8-1.0m HIGH PLACED ON A BLUE RECTANGLE WITH NO SIDE MORE THAN 1.2m, PLACED AS A PAVEMENT MARKING IN THE CENTRE OF THE SPACE BETWEEN 0.5m-0.6m FROM ITS ENTRY POINT.
- DIAGONAL STRIPE MARKING OTHER THAN DISABILITY ACCESS SHARED SPACES SHALL BE MARKED WITH DIAGONAL STRIPES 150-200mm WIDE WITH SPACES 200-300mm BETWEEN STRIPES. THE STRIPES SHALL BE AT AN ANGLE OF 45 +/- 10 DEGREES TO THE SIDE OF THE SPACE.
- AREAS SHOWN WITH DIAGONAL STRIPE MARKING OTHER THAN DISABILITY ACCESS SHARED SPACES SHALL BE MARKED WITH WHITE OR YELLOW DIAGONAL STRIPES 150-200mm WIDE WITH SPACES 200-300mm BETWEEN STRIPES. THE STRIPES SHALL BE AT AN ANGLE OF 45 +/- 10 DEGREES TO THE SIDE OF THE SPACE.

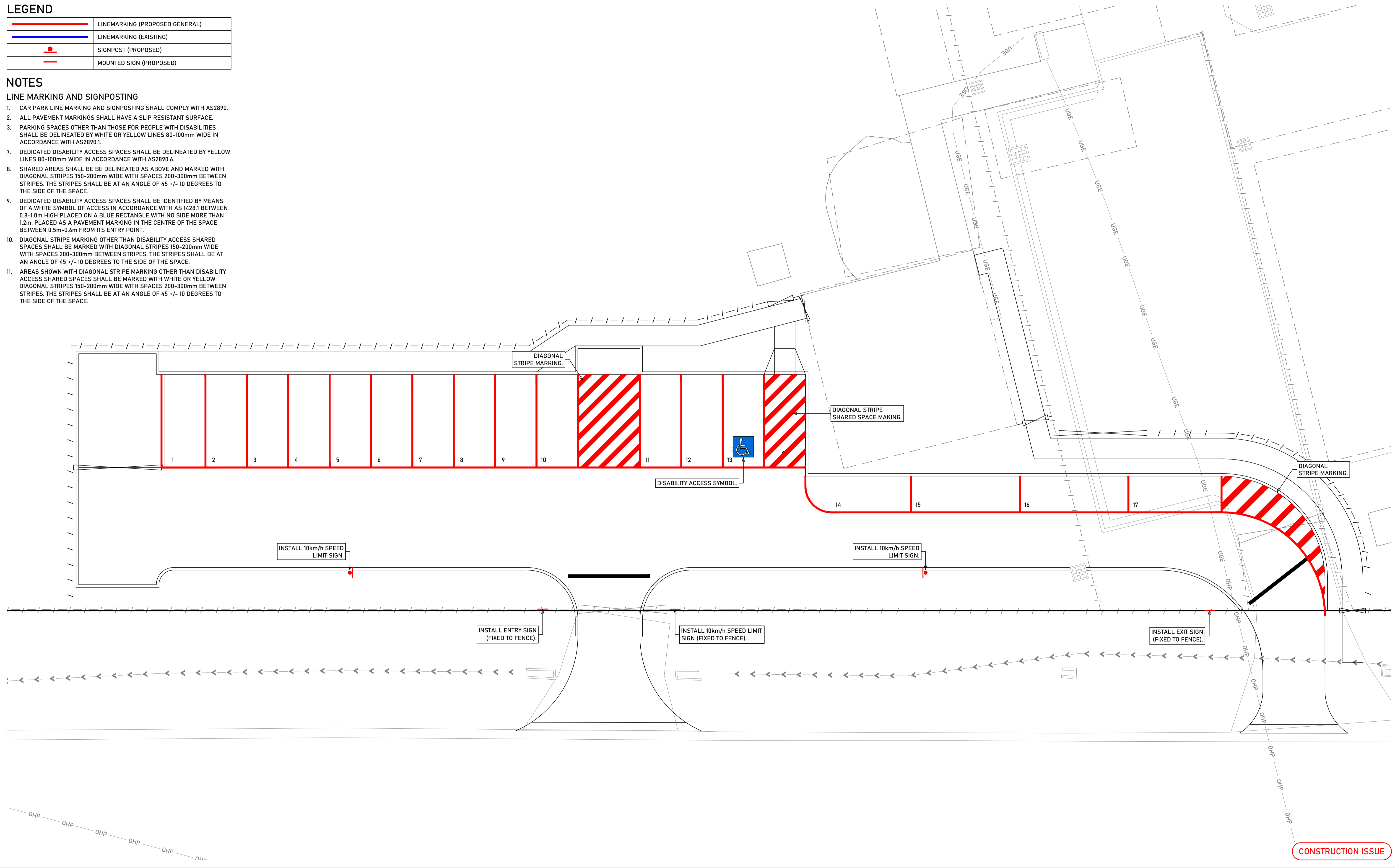

CONSTRUCTION ISSUE

REV.	REVISION DETAILS	DES	DWN	CHK	DATE
0	PRELIMINARY ISSUE FOR REVIEW	JRR	DBM	JRR	07/06/22
1	AMENDMENTS	JRR	DBM	JRR	22/06/22
2	MINOR AMENDMENTS	JRR	DBM	JRR	24/06/22
3	ADDED TREE REMOVAL PLAN AND OTHER MINOR AMENDMENTS	JRR	DBM	JRR	28/06/22
4	CONCRETE PAVEMENT DETAILS ADDED.	JRR	DBM	JRR	13/07/22
5	AMENDMENTS	JRR	JRR	JRR	21/07/22

METIRI

DATUM: **AHD** SCALE: **1:100**

SCALE @ A1

ABN 86 633 598 875 ACN 633 598 875
 5/33 The Boulevard, Toronto NSW 2283
 4950 5995 mail@metiri.com.au metiri.com.au

PROJECT: **CIVIL ENGINEERING PLANS
 WOODBERRY LEARNING CENTRE CAR PARK UPGRADES
 LOT 1 DP 557998
 WOODBERRY ROAD, WOODBERRY**

CLIENT: **NSW DEPARTMENT OF EDUCATION**

SHEET TITLE			
LINEMARKING & SIGNPOSTING PLAN			
PROJECT NUMBER	SHEET NUMBER	TOTAL SHEETS	REVISION
210171	11	12	5

FILE PATH: C:\OneDrive\Metiri Consultants Pty Ltd\Metiri - Documents\Projects\2021\210171\04 - CADD\Drawings\Civil Engineering Plans\ PLOT DATE: 21/07/2022

LEGEND

	TREES TO BE REMOVED
	TREES TO BE RETAINED

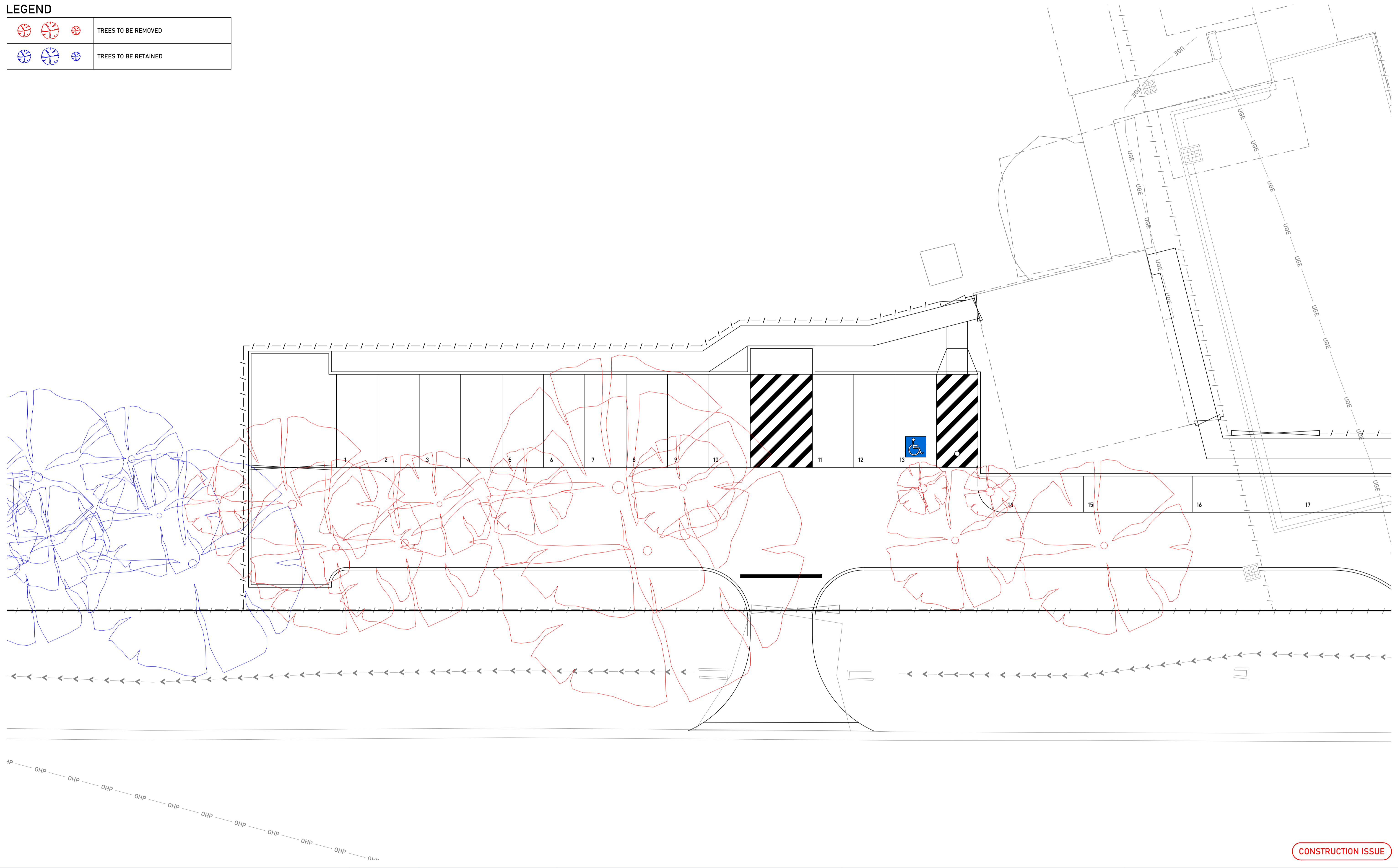

CONSTRUCTION ISSUE

REV.	REVISION DETAILS	DES	DWN	CHK	DATE
0	PRELIMINARY ISSUE FOR REVIEW	JRR	DBM	JRR	07/06/22
1	AMENDMENTS	JRR	DBM	JRR	22/06/22
2	MINOR AMENDMENTS	JRR	DBM	JRR	24/06/22
3	ADDED TREE REMOVAL PLAN AND OTHER MINOR AMENDMENTS	JRR	DBM	JRR	28/06/22
4	CONCRETE PAVEMENT DETAILS ADDED.	JRR	DBM	JRR	13/07/22
5	AMENDMENTS	JRR	JRR	JRR	21/07/22

METIRI

DATUM: **AHD** SCALE: **1:100**

SCALE @ A1

Metiri
Engineers • Surveyors • Planners

ABN 86 633 598 875 ACN 633 598 875
5/33 The Boulevard, Toronto NSW 2283
4950 5995 mail@metiri.com.au metiri.com.au

PROJECT	CIVIL ENGINEERING PLANS WOODBERRY LEARNING CENTRE CAR PARK UPGRADES LOT 1 DP 557998 WOODBERRY ROAD, WOODBERRY
CLIENT	NSW DEPARTMENT OF EDUCATION

SHEET TITLE			
TREE REMOVAL PLAN			
PROJECT NUMBER	SHEET NUMBER	TOTAL SHEETS	REVISION
210171	12	12	5

FILE PATH: C:\OneDrive\Metiri Consultants Pty Ltd\Metiri - Documents\Projects\2021\04 - CADD\Drawings\Civil Engineering Plans\ PLOT DATE: 21/07/2022