

**STORMWATER PHILOSOPHY**

- ALL ROOFWATER IS DIRECTED TO 2 X 4000L ABOVE GROUND TANKS MADE UP OF 2500L OSD & 1500L RAINWATER. THE STORED RAINWATER WILL BE REUSED INTERNALLY.
- OVERFLOW FROM THE RAINWATER TANKS WILL BE DIRECTED TO STORMWATER PITS. A LOW FLOW PIPE WILL RESTRICT DISCHARGE FROM THE TANK TO 0.9 L/s. THE SIZE OF THE TANK AND ALLOWABLE DISCHARGE HAS BEEN PROPORTIONED TO THE IMPERVIOUS PERCENTAGE OF THE ROOF AREA FOR EACH LOT.
- REMAINING IMPERVIOUS AREAS ON THE HIGH SIDE OF THE DRIVEWAY WILL SHEET FLOW TO THE ROAD & CAPTURED IN SURFACE INLET PITS. REMAINING IMPERVIOUS AREAS ON THE LOW SIDE OF THE DRIVEWAY WILL BE CAPTURED BY A GRATED DRAIN AND DIRECTED TO STORMWATER PITS AT THE REAR OF THE LOT.
- SUFFICIENT VOLUME HAS BEEN PROVIDED TO LIMIT THE POST-DEVELOPMENT DISCHARGE FROM ALL STORM EVENTS UP TO AND INCLUDING THE 1 IN 100 YEAR EVENT.
- DISCHARGE TO THE SURFACE INLET PITS IN ALL STORM EVENTS WILL BE LIMITED TO THE 1 IN 10 YEAR PRE-DEVELOPED FLOWS. STORM EVENTS GREATER THAN 1 IN 10 YEAR WILL BE SAFELY CONVEYED VIA SHEET FLOW DOWN THE PROPOSED DRIVEWAY FOR LOTS 1-4 & AS SHEET FLOW TO THE SOUTHERN BOUNDARY FOR LOTS 5-7.

**STORMWATER CALCULATIONS**

|                             |   |                        |
|-----------------------------|---|------------------------|
| SITE AREA                   | = | 4789.00 m <sup>2</sup> |
| ROOF AREA                   | = | 1610.10 m <sup>2</sup> |
| BYPASS AREA 1 DRIVEWAY AREA | = | 1593.50 m <sup>2</sup> |
| PERVIOUS AREA               | = | 432.76 m <sup>2</sup>  |
| IMPERVIOUS %                | = | 1160.74 m <sup>2</sup> |
| BYPASS AREA 2 DRIVEWAY AREA | = | 1587.66 m <sup>2</sup> |
| PERVIOUS AREA               | = | 546.00 m <sup>2</sup>  |
| IMPERVIOUS %                | = | 1041.66 m <sup>2</sup> |

**Onsite Detention Calculations (OSD)**

|                        |   |                               |
|------------------------|---|-------------------------------|
| Q <sub>PRE(10Y)</sub>  | = | C I A (t <sub>c</sub> = 5min) |
|                        | = | 0.4 x 162 x 4789              |
|                        | = | 86.22 L/s                     |
| Q <sub>PRE(100Y)</sub> | = | C I A (t <sub>c</sub> = 5min) |
|                        | = | 0.48 x 266 x 4789             |
|                        | = | 169.88 L/s                    |

ROOF WATER IS THE ONLY STORM WATER THAT WILL BE CAPTURED & STORED WITHIN THIS SITE. ALL OTHER FLOW WILL BE BYPASS FLOW. THE BYPASS FLOW WILL BE CONVEYED TO THE DRIVEWAY & DISCHARGED TO THE STREET OR THE FLOW WILL MAINTAIN PREDEVELOPMENT FLOW CONDITIONS.

|                                  |   |                               |
|----------------------------------|---|-------------------------------|
| Q <sub>BYPASS AREA 1 (10Y)</sub> | = | C I A (t <sub>c</sub> = 5min) |
|                                  | = | 0.54 x 162 x 1593.5           |
|                                  | = | 38.42 L/s                     |
| Q <sub>BYPASS AREA 2 (10Y)</sub> | = | C I A (t <sub>c</sub> = 5min) |
|                                  | = | 0.57 x 162 x 1587.66          |
|                                  | = | 40.87 L/s                     |
| Q <sub>BYPASS TOTAL (10Y)</sub>  | = | 38.42 + 40.87                 |
|                                  | = | 79.29 L/s                     |

THEREFORE THE ALLOWABLE DISCHARGE FROM THE SITE IN THE 10 YEAR STORM EVENT IS

|                              |   |   |
|------------------------------|---|---|
| Q <sub>ALLOWABLE (10Y)</sub> | = | Q <sub>PRE(10Y)</sub> - Q <sub>BYPASS TOTAL (10Y)</sub> |
|                              | = | 86.22 - 79.29   |
|                              | = | 6.93 L/s  |

EACH LOT WILL BE ABLE TO DISCHARGE AN EQUAL PORTION OF THIS (7 LOTS)

|                                      |   |                               |
|--------------------------------------|---|-------------------------------|
| Q <sub>ALLOWABLE PER LOT (10Y)</sub> | = | 0.99 L/s                      |
| Q <sub>BYPASS AREA 1 (100Y)</sub>    | = | C I A (t <sub>c</sub> = 5min) |
|                                      | = | 0.64 x 266 x 1593.5           |
|                                      | = | 75.71 L/s                     |
| Q <sub>BYPASS AREA 2 (100Y)</sub>    | = | C I A (t <sub>c</sub> = 5min) |
|                                      | = | 0.69 x 266 x 1587.66          |
|                                      | = | 80.52 L/s                     |
| Q <sub>BYPASS TOTAL (100Y)</sub>     | = | 75.71 + 80.52                 |
|                                      | = | 156.23 L/s                    |

ALLOWABLE DISCHARGE<sub>(100Y)</sub> = 169.88 - 6.93 = 13.65 L/s

THE OSD STORAGE FOR EACH LOT IS DETERMINED BY THE 100 Yr STORM EVENT.

|                               |   |                               |
|-------------------------------|---|-------------------------------|
| Q <sub>ROOF AREA (100Y)</sub> | = | C I A (t <sub>c</sub> = 5min) |
|                               | = | 1 x 266 x 1610.10             |
|                               | = | 118.97 L/s                    |

VOLUME FOR OSD = 118.97 - 6.93 (t<sub>c</sub> = 5min) = 112.04 L/s = 33.61 m<sup>3</sup>

VOLUME FOR OSD PER LOT (7 LOTS) = 4.8 m<sup>3</sup>

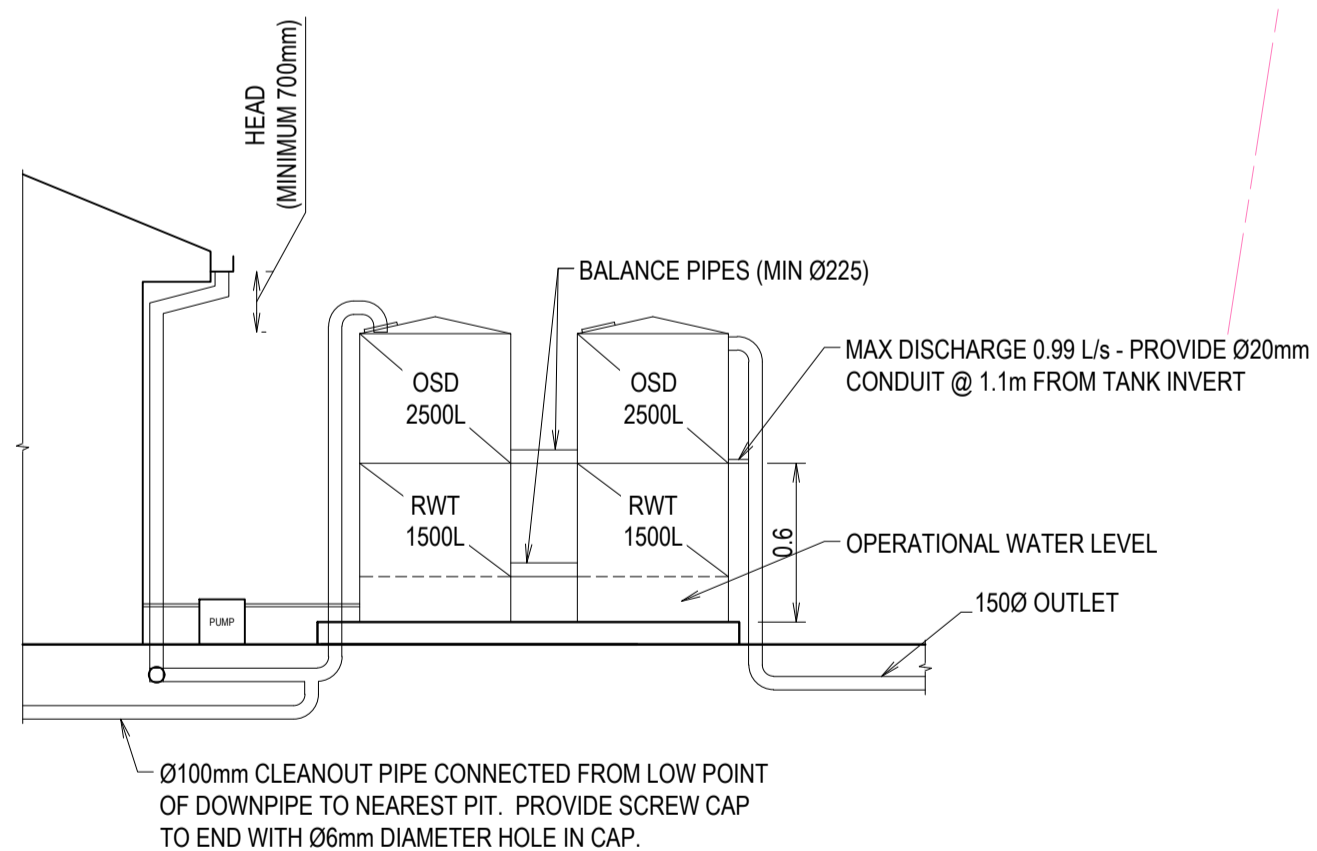

**RWT SCHEMATIC SECTION**  
NTS

REFER TO HYDRAULIC ENGINEERS DRAWING FOR TANK DETAILS

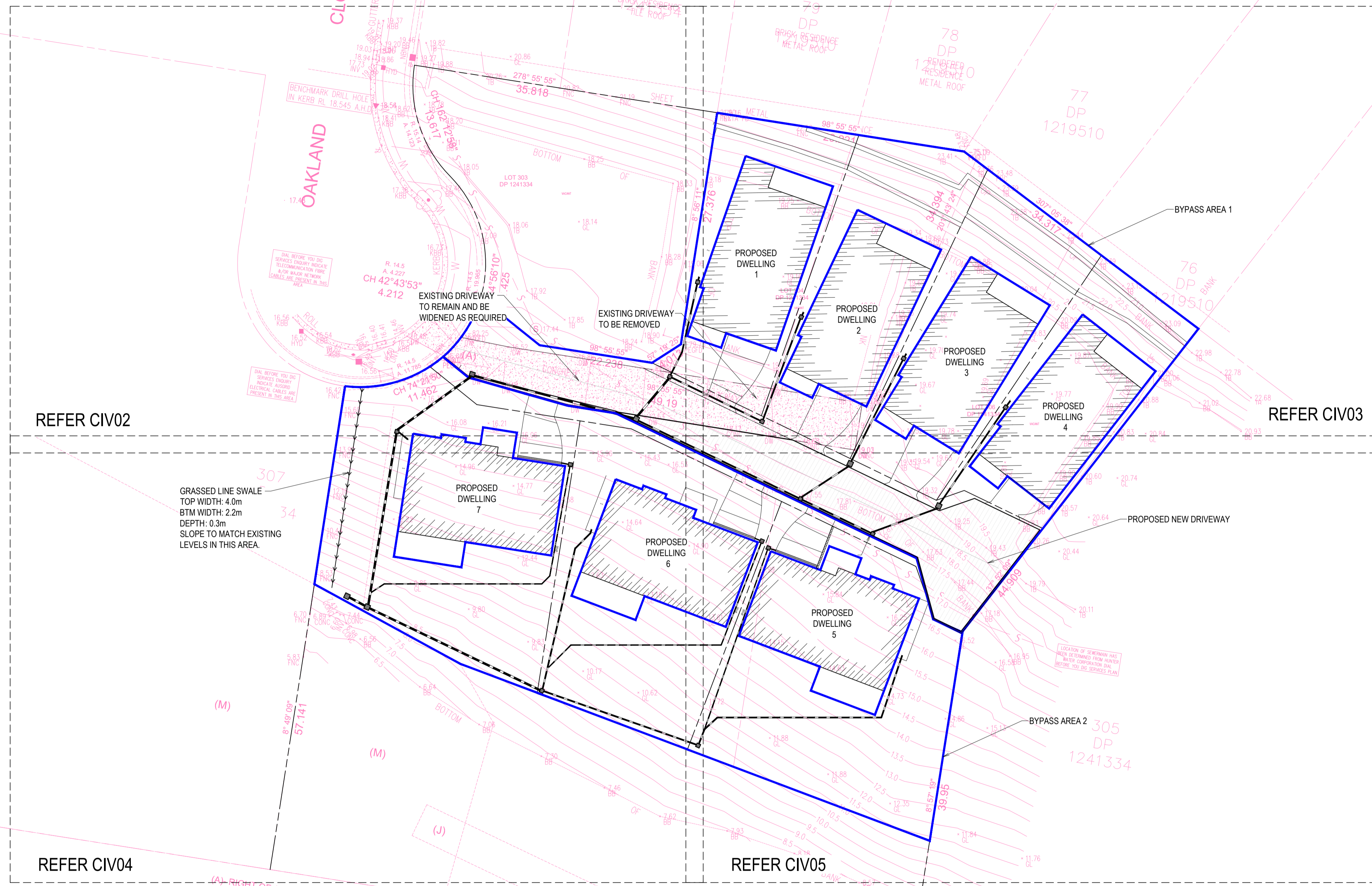
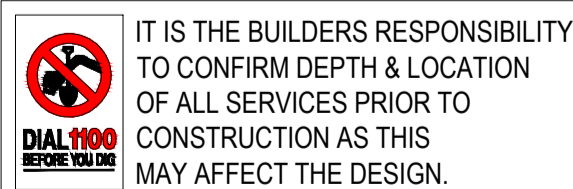

This drawing is not approved for construction unless signed.

Mathew McLennans  
BEing (Civil) Hons MIE (Aust)

COPYRIGHT - This drawing and the information provided shall remain the property of DRB Consulting Engineers Pty Ltd (DRB) and may not be used, copied or reproduced, in whole or part, for any purpose other than that for which it was supplied without the prior consent of DRB.

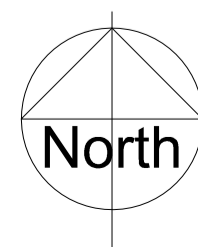

PO BOX 4105 Kotara East 2305  
0402 915 549  
ABN 64 625 755 482



OVERALL PLAN & CIVIL DETAILS  
80 (LOTS 304 & 306) OAKLANDS CLOSE,  
BOLWARRA  
PERCEPTION PLANNING

DRAWING STATUS

**NOT FOR CONSTRUCTION**

PROJECT REF No.  
210695

DRAWING No.  
CIV01

SHEET SIZE

**A1**

SCALE

1:300

REVISION

**G**



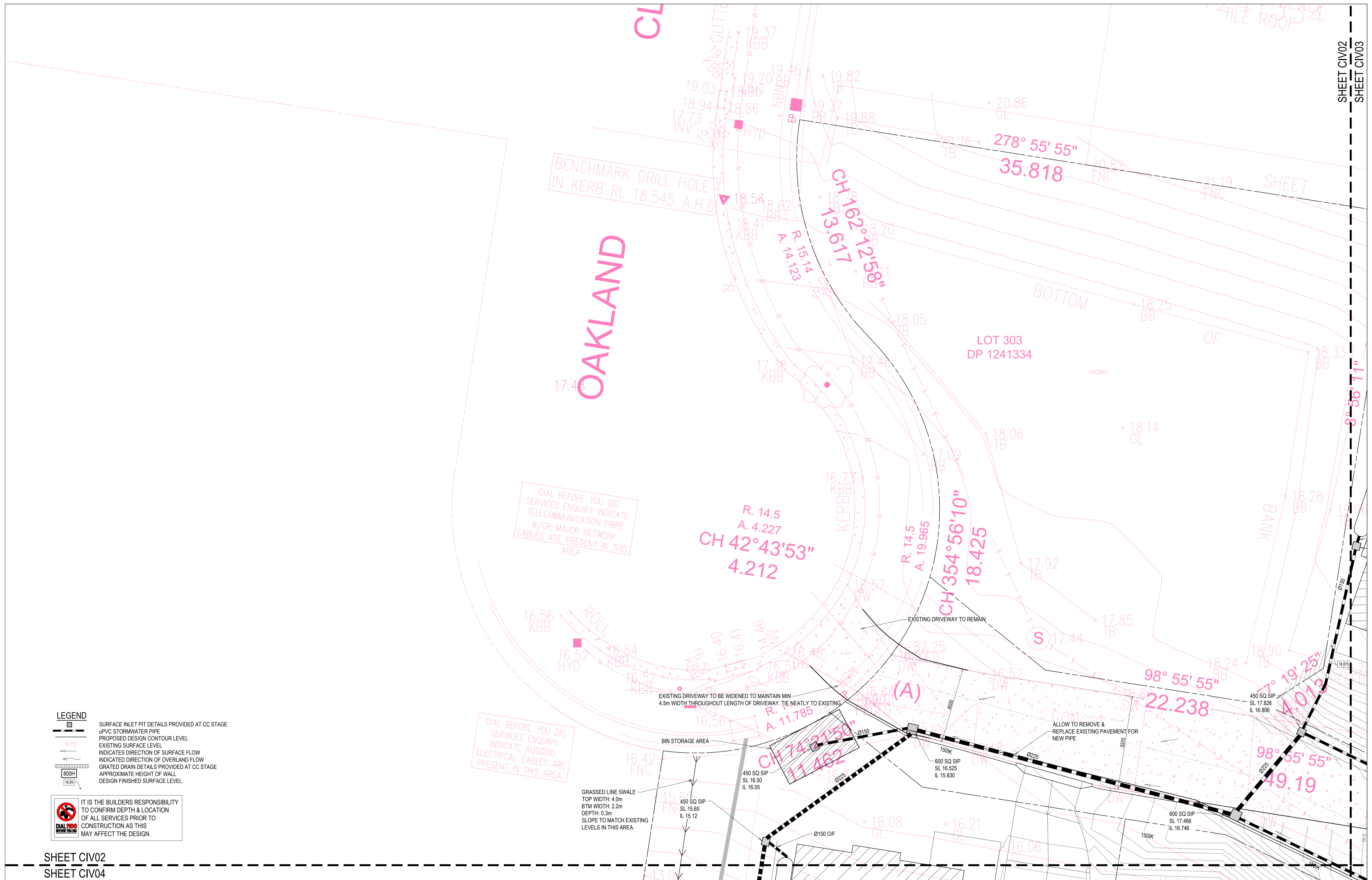

**LEGEND**

|  |  |
|--|--|
|  | SURFACE INLET PIT DETAILS PROVIDED AT CC STAGE |
|  | uPVC STORMWATER PIPE                           |
|  | PROPOSED DESIGN CONTOUR LEVEL                  |
|  | EXISTING SURFACE LEVEL                         |
|  | INDICATES DIRECTION OF SURFACE FLOW            |
|  | INDICATED DIRECTION OF OVERLAND FLOW           |
|  | GRATED DRAIN DETAILS PROVIDED AT CC STAGE      |
|  | APPROXIMATE HEIGHT OF WALL                     |
|  | DESIGN FINISHED SURFACE LEVEL                  |

IT IS THE BUILDERS RESPONSIBILITY TO CONFIRM DEPTH & LOCATION OF ALL SERVICES PRIOR TO CONSTRUCTION AS THIS MAY AFFECT THE DESIGN.

DIAL BEFORE YOU DIG SERVICES ENQUIRY INDICATE AUSGRID ELECTRICAL CABLES ARE PRESENT IN THIS AREA

DIAL BEFORE YOU DIG SERVICES ENQUIRY INDICATE TELECOMMUNICATION FIBRE &/OR MAJOR NETWORK CABLES ARE PRESENT IN THIS AREA

SHEET CIV02  
SHEET CIV04

| REV | DATE     | DRN  | CHK  | APP  | DRAWING STATUS       |
|-----|----------|------|------|------|----------------------|
| G   | 09.12.21 | J.T. | M.M. | M.M. | REVISED ISSUE FOR DA |
| F   | 07.12.21 | J.T. | M.M. | M.M. | REVISED ISSUE FOR DA |
| E   | 08.11.21 | J.T. | M.M. | M.M. | REVISED ISSUE FOR DA |
| D   | 20.08.21 | J.T. | M.M. | M.M. | REVISED ISSUE FOR DA |
| C   | 07.06.21 | J.T. | M.M. | M.M. | REVISED ISSUE FOR DA |
| B   | 10.05.21 | J.T. | M.M. | M.M. | REVISED ISSUE FOR DA |
| A   | 28.04.21 | J.T. | M.M. | M.M. | ISSUED FOR DA        |

This drawing is not approved for construction unless signed.

Mathew McNamara  
BEng (Civil) Hon MIE (Aust)

COPYRIGHT - This drawing and the information provided shall remain the property of DRB Consulting Engineers Pty Ltd (DRB) and may not be used, copied or reproduced, in whole or part, for any purpose other than that for which it was supplied without the prior consent of DRB.

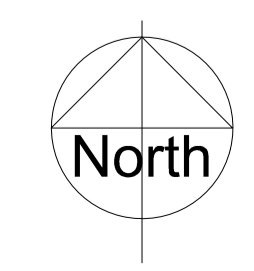

PO BOX 4105 Kotara East 2305  
0402 915 549  
ABN 64 625 755 482



STORMWATER MANAGEMENT PLAN - SHEET 1  
80 (LOTS 304 & 306) OAKLANDS CLOSE,  
BOLWARRA  
PERCEPTION PLANNING

|                             |             |            |
|-----------------------------|-------------|------------|
| DRAWING STATUS              |             | SHEET SIZE |
| <b>NOT FOR CONSTRUCTION</b> |             | <b>A1</b>  |
| PROJECT REF No.             | DRAWING No. | SCALE      |
| 210695                      | CIV02       | 1:100      |
|                             |             | REVISION   |
|                             |             | G          |



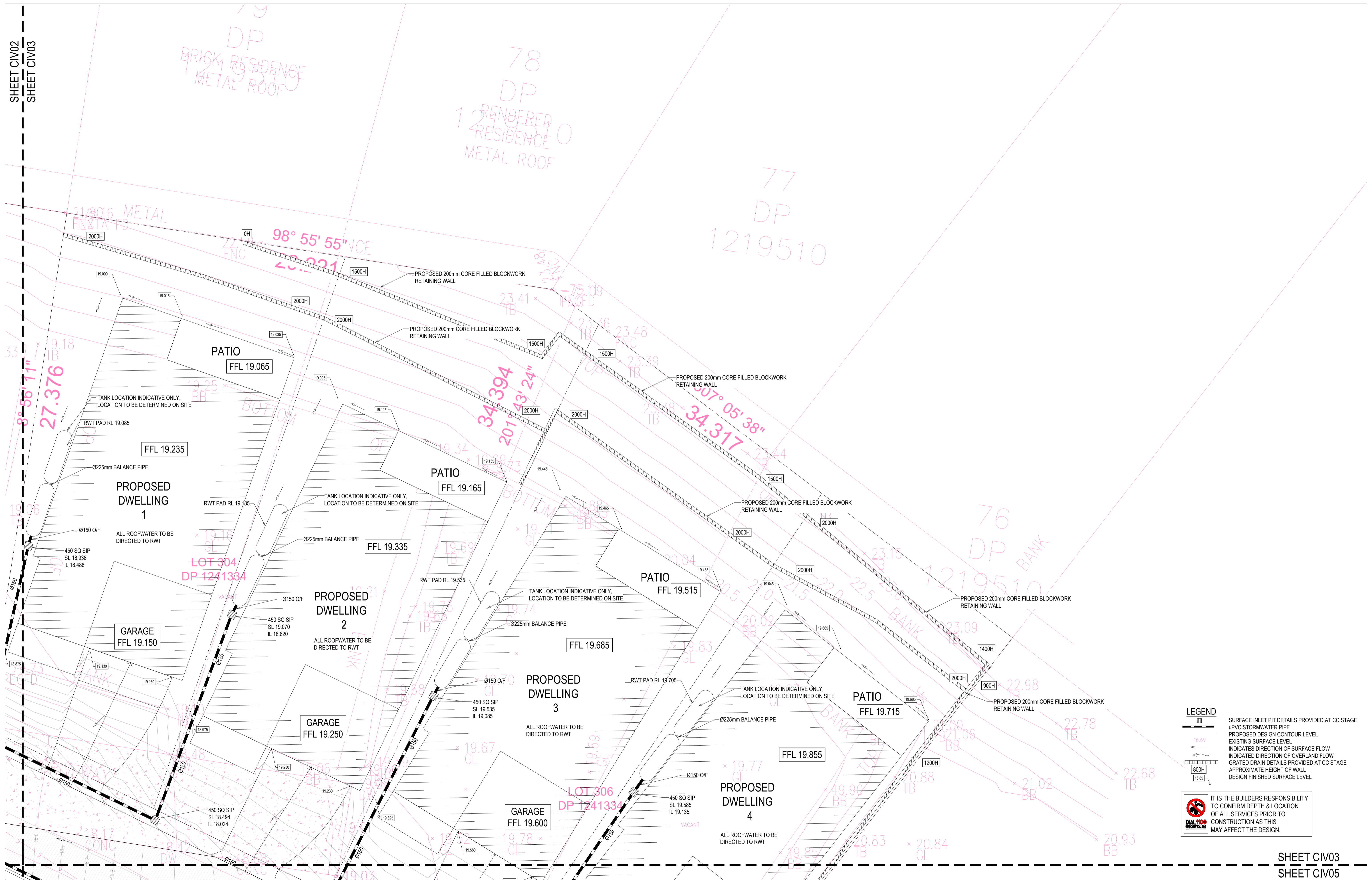

**LEGEND**

- SURFACE INLET PIT DETAILS PROVIDED AT CC STAGE
- pPVC STORMWATER PIPE
- PROPOSED DESIGN CONTOUR LEVEL
- EXISTING SURFACE LEVEL
- INDICATES DIRECTION OF SURFACE FLOW
- INDICATED DIRECTION OF OVERLAND FLOW
- GRATED DRAIN DETAILS PROVIDED AT CC STAGE
- APPROXIMATE HEIGHT OF WALL
- DESIGN FINISHED SURFACE LEVEL

IT IS THE BUILDERS RESPONSIBILITY TO CONFIRM DEPTH & LOCATION OF ALL SERVICES PRIOR TO CONSTRUCTION AS THIS MAY AFFECT THE DESIGN.

| REV | DATE     | DRN  | CHK  | APP  | DRAWING STATUS       |
|-----|----------|------|------|------|----------------------|
| F   | 07.12.21 | J.T. | M.M. | M.M. | REVISED ISSUE FOR DA |
| E   | 08.11.21 | J.T. | M.M. | M.M. | REVISED ISSUE FOR DA |
| D   | 20.08.21 | J.T. | M.M. | M.M. | REVISED ISSUE FOR DA |
| C   | 07.06.21 | J.T. | M.M. | M.M. | REVISED ISSUE FOR DA |
| B   | 10.05.21 | J.T. | M.M. | M.M. | REVISED ISSUE FOR DA |
| A   | 28.04.21 | J.T. | M.M. | M.M. | ISSUED FOR DA        |

This drawing is not approved for construction unless signed.

Mathew McLennars  
BEng (Civil) Hon MIE (Aust)

COPYRIGHT - This drawing and the information provided shall remain the property of DRB Consulting Engineers Pty Ltd (DRB) and may not be used, copied or reproduced, in whole or part, for any purpose other than that for which it was supplied without the prior consent of DRB.

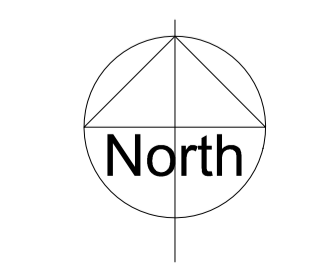

PO BOX 4105 Kotara East 2305  
0402 915 549  
ABN 64 625 755 482

STORMWATER MANAGEMENT PLAN - SHEET 2  
80 (LOTS 304 & 306) OAKLANDS CLOSE,  
BOLWARRA  
PERCEPTION PLANNING

|                             |             |            |
|-----------------------------|-------------|------------|
| DRAWING STATUS              |             | SHEET SIZE |
| <b>NOT FOR CONSTRUCTION</b> |             | <b>A1</b>  |
| PROJECT REF No.             | DRAWING No. | SCALE      |
| 210695                      | CIV03       | 1:100      |
| REVISION                    |             | REVISION   |
|                             |             | F          |



307  
DP  
124133

(M)

(M)

(J)

8° 49' 09"  
57.141

**LEGEND**

|  |  |
|--|--|
|  | SURFACE INLET PIT DETAILS PROVIDED AT CC STAGE |
|  | PVC STORMWATER PIPE                            |
|  | PROPOSED DESIGN CONTOUR LEVEL                  |
|  | EXISTING SURFACE LEVEL                         |
|  | INDICATES DIRECTION OF SURFACE FLOW            |
|  | INDICATED DIRECTION OF OVERLAND FLOW           |
|  | GRATED DRAIN DETAILS PROVIDED AT CC STAGE      |
|  | APPROXIMATE HEIGHT OF WALL                     |
|  | DESIGN FINISHED SURFACE LEVEL                  |

IT IS THE BUILDERS RESPONSIBILITY TO CONFIRM DEPTH & LOCATION OF ALL SERVICES PRIOR TO CONSTRUCTION AS THIS MAY AFFECT THE DESIGN.

This drawing is not approved for construction unless signed.

Mathew McNamara  
BEng (Civil) Hon MIE (Aust)

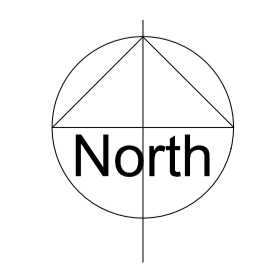

PO BOX 4105 Kotara East 2305  
0402 915 549  
ABN 64 625 755 482



STORMWATER MANAGEMENT PLAN - SHEET 3  
80 (LOTS 304 & 306) OAKLANDS CLOSE,  
BOLWARRA  
PERCEPTION PLANNING

|                             |             |            |
|-----------------------------|-------------|------------|
| DRAWING STATUS              |             | SHEET SIZE |
| <b>NOT FOR CONSTRUCTION</b> |             | <b>A1</b>  |
| PROJECT REF No.             | DRAWING No. | SCALE      |
| 210695                      | CIV04       | 1:100      |
| REVISION                    |             | REVISION   |
|                             |             | F          |

| REV | DATE     | DRN  | CHK  | APP  | DRAWING STATUS       |
|-----|----------|------|------|------|----------------------|
| F   | 07.12.21 | J.T. | M.M. | M.M. | REVISED ISSUE FOR DA |
| E   | 08.11.21 | J.T. | M.M. | M.M. | REVISED ISSUE FOR DA |
| D   | 20.08.21 | J.T. | M.M. | M.M. | REVISED ISSUE FOR DA |
| C   | 07.06.21 | J.T. | M.M. | M.M. | REVISED ISSUE FOR DA |
| B   | 10.05.21 | J.T. | M.M. | M.M. | REVISED ISSUE FOR DA |
| A   | 28.04.21 | J.T. | M.M. | M.M. | ISSUED FOR DA        |

COPYRIGHT - This drawing and the information provided shall remain the property of DRB Consulting Engineers Pty Ltd (DRB) and may not be used, copied or reproduced, in whole or part, for any purpose other than that for which it was supplied without the prior consent of DRB.







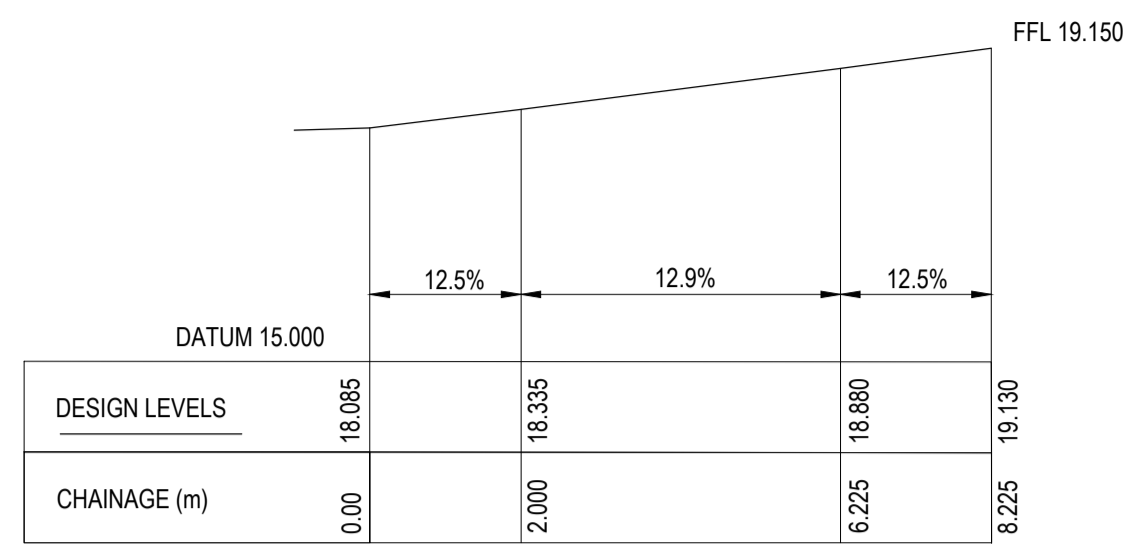

ACCESS DRIVEWAY DWELLING 1 LONGITUDINAL SECTION  
VERT 1:100  
HORIZ 1:100

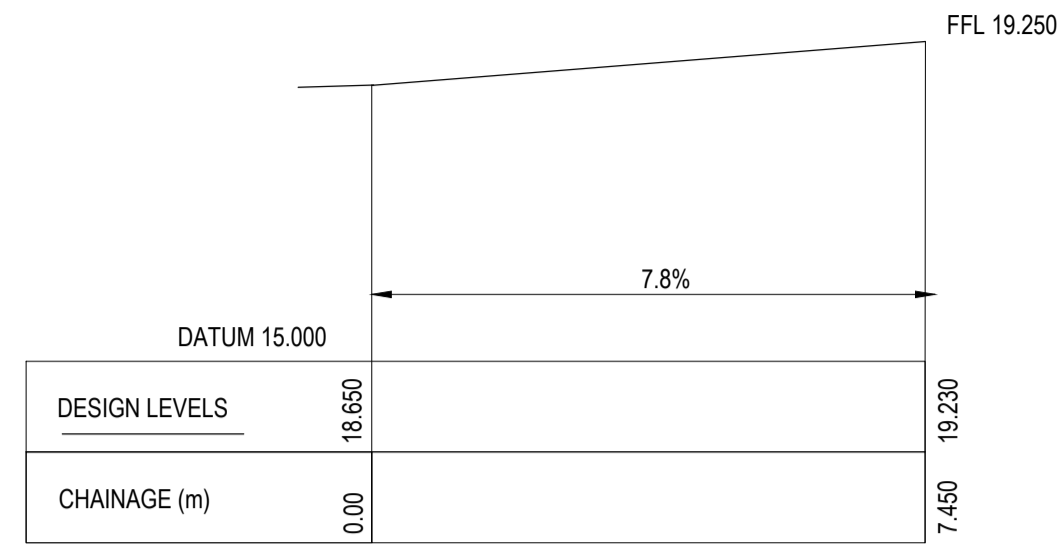

ACCESS DRIVEWAY DWELLING 2 LONGITUDINAL SECTION  
VERT 1:100  
HORIZ 1:100

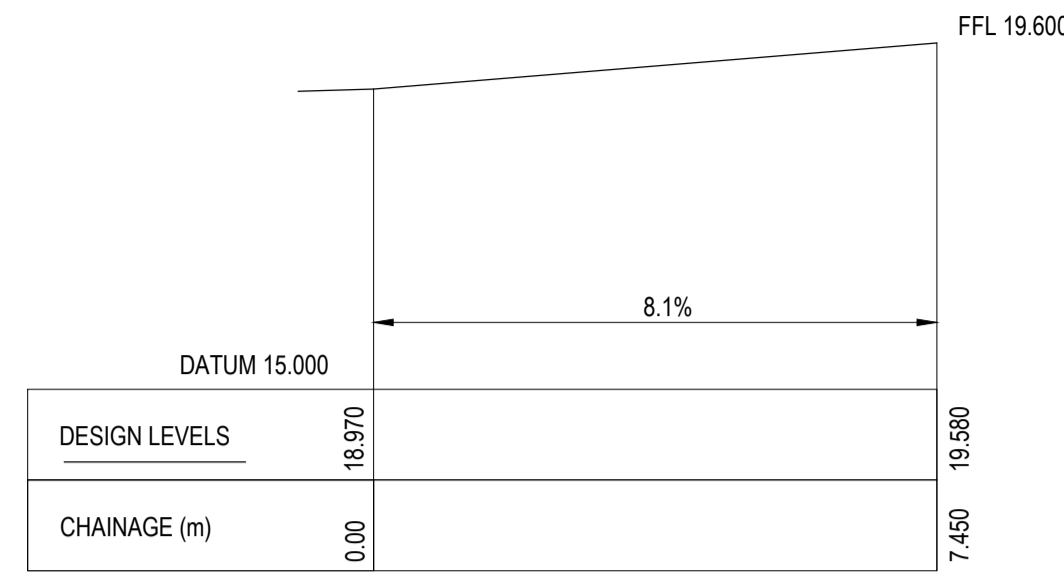

ACCESS DRIVEWAY DWELLING 3 LONGITUDINAL SECTION  
VERT 1:100  
HORIZ 1:100

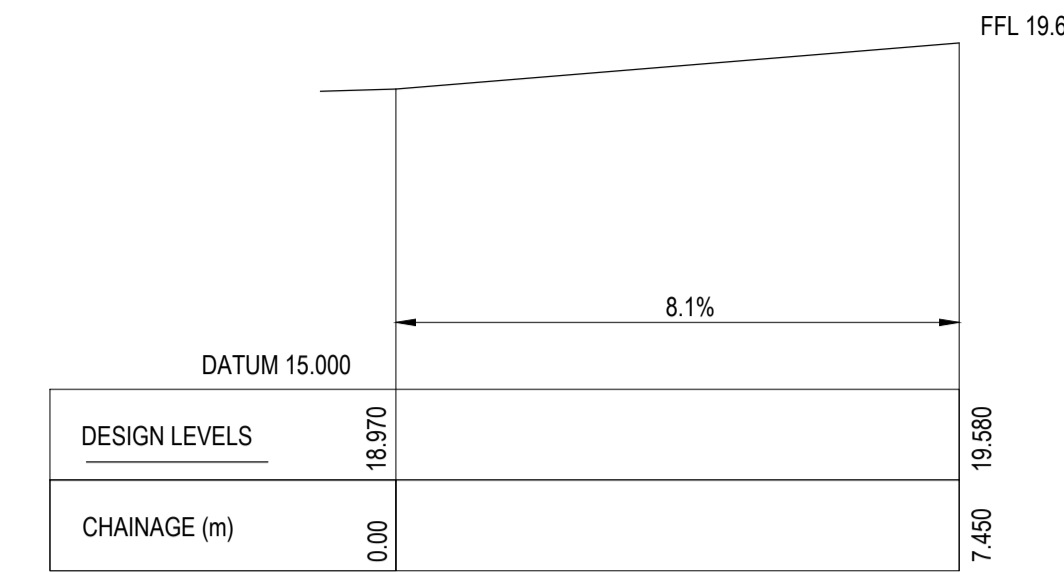

ACCESS DRIVEWAY DWELLING 3 LONGITUDINAL SECTION  
VERT 1:100  
HORIZ 1:100

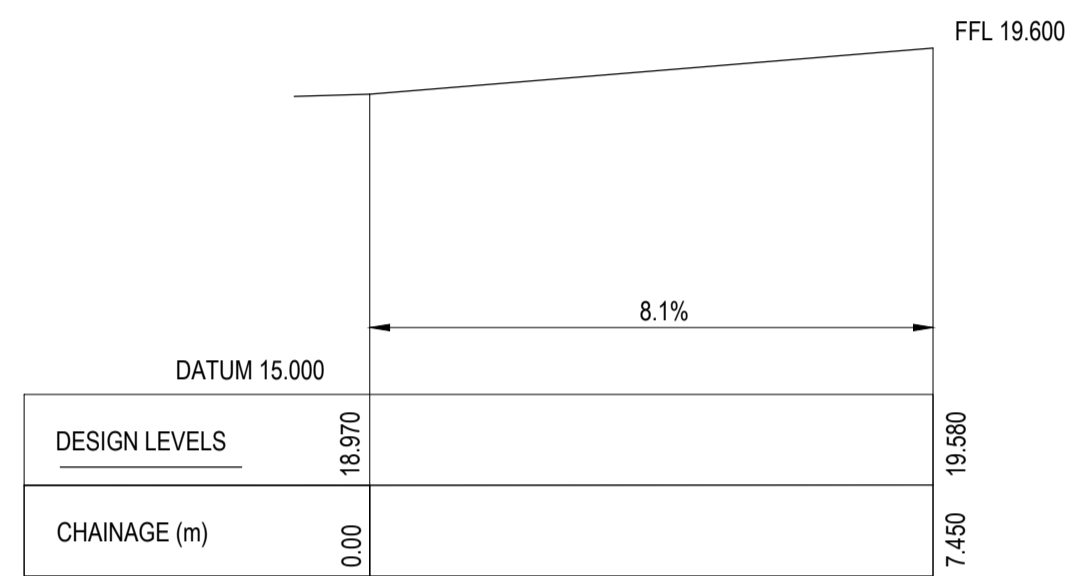

ACCESS DRIVEWAY DWELLING 3 LONGITUDINAL SECTION  
VERT 1:100  
HORIZ 1:100

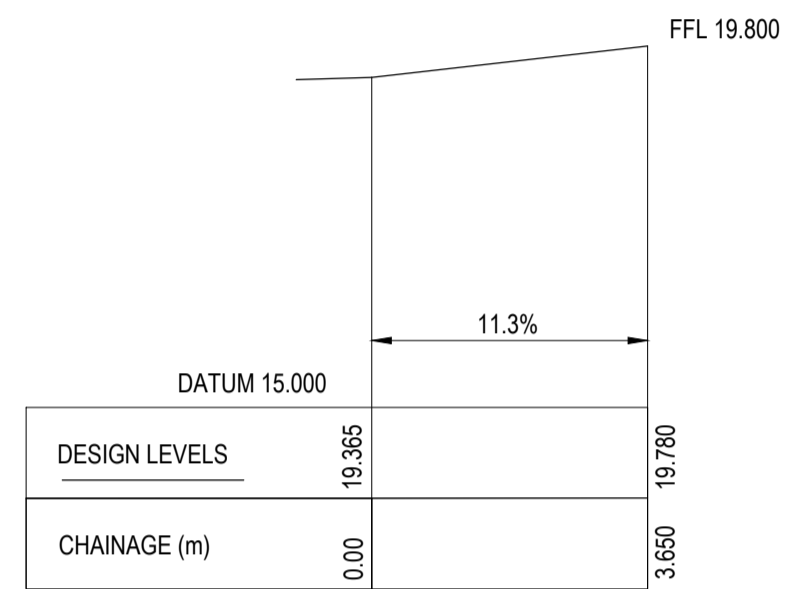

ACCESS DRIVEWAY DWELLING 4 LONGITUDINAL SECTION  
VERT 1:100  
HORIZ 1:100

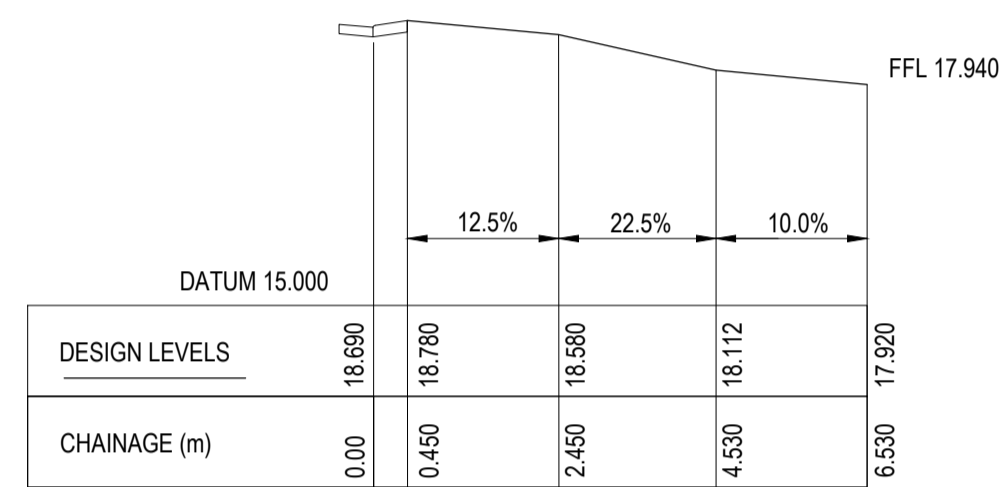

ACCESS DRIVEWAY DWELLING 5 LONGITUDINAL SECTION  
VERT 1:100  
HORIZ 1:100

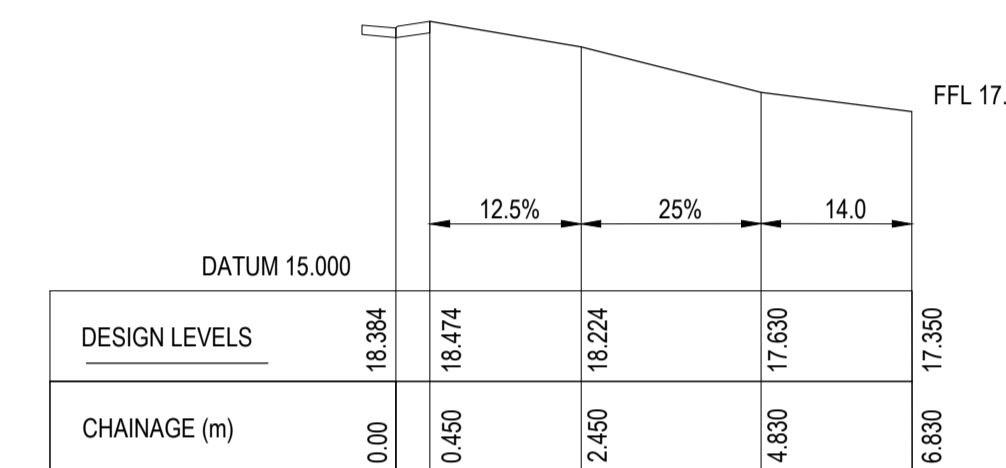

ACCESS DRIVEWAY DWELLING 6 LONGITUDINAL SECTION  
VERT 1:100  
HORIZ 1:100

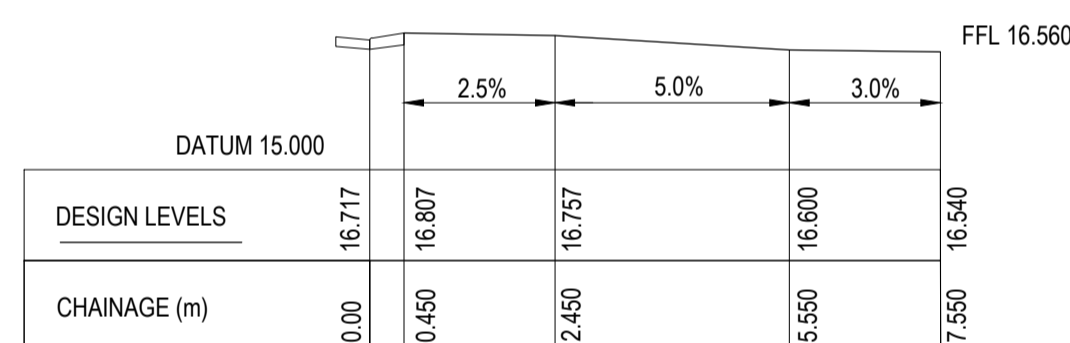

ACCESS DRIVEWAY DWELLING 7 LONGITUDINAL SECTION  
VERT 1:100  
HORIZ 1:100

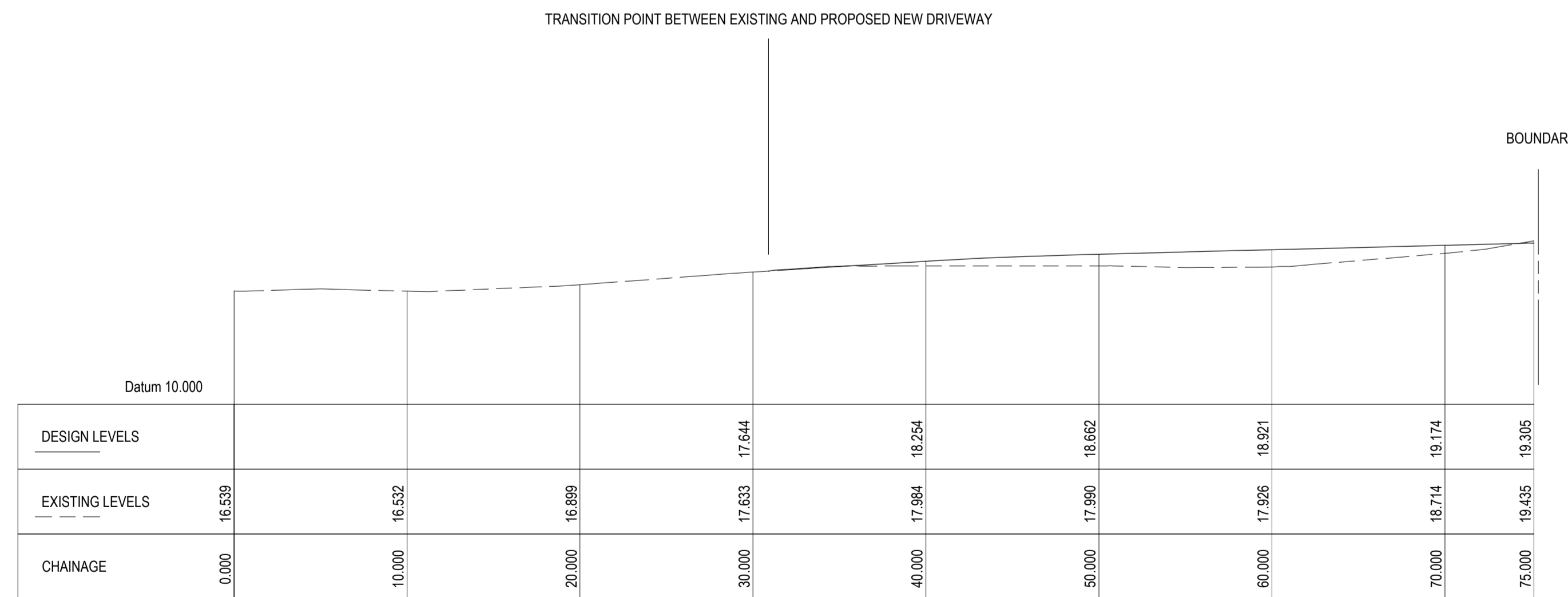

COMMUNITY DRIVEWAY LONGITUDINAL SECTION  
VERT 1:250  
HORIZ 1:250

This drawing is not approved for construction unless signed.

Mathew McManara  
BEing (Civil) Hon's MIE (Aust)

COPYRIGHT - This drawing and the information provided shall remain the property of DRB Consulting Engineers Pty Ltd (DRB) and may not be used, copied or reproduced, in whole or part, for any purpose other than that for which it was supplied without the prior consent of DRB.

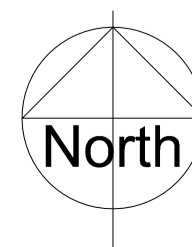

PO BOX 4105 Kotara East 2305  
0402 915 549  
ABN 64 625 755 482



DRIVEWAY LONG SECTIONS  
80 (LOTS 304 & 306) OAKLANDS CLOSE,  
BOLWARRA  
PERCEPTION PLANNING

DRAWING STATUS

NOT FOR CONSTRUCTION

PROJECT REF No.  
210695

DRAWING No.  
CIV06

SHEET SIZE

A1

SCALE

1:100

REVISION

B

REVISIONS

|     |          |      |      |      |                |
|-----|----------|------|------|------|----------------|
|     |          |      |      |      |                |
|     |          |      |      |      |                |
|     |          |      |      |      |                |
|     |          |      |      |      |                |
| B   | 08.11.21 | J.T. | M.M. | M.M. | ISSUED FOR DA  |
| A   | 20.08.21 | J.T. | M.M. | M.M. | ISSUED FOR DA  |
| REV | DATE     | DRN  | CHK  | APP  | DRAWING STATUS |



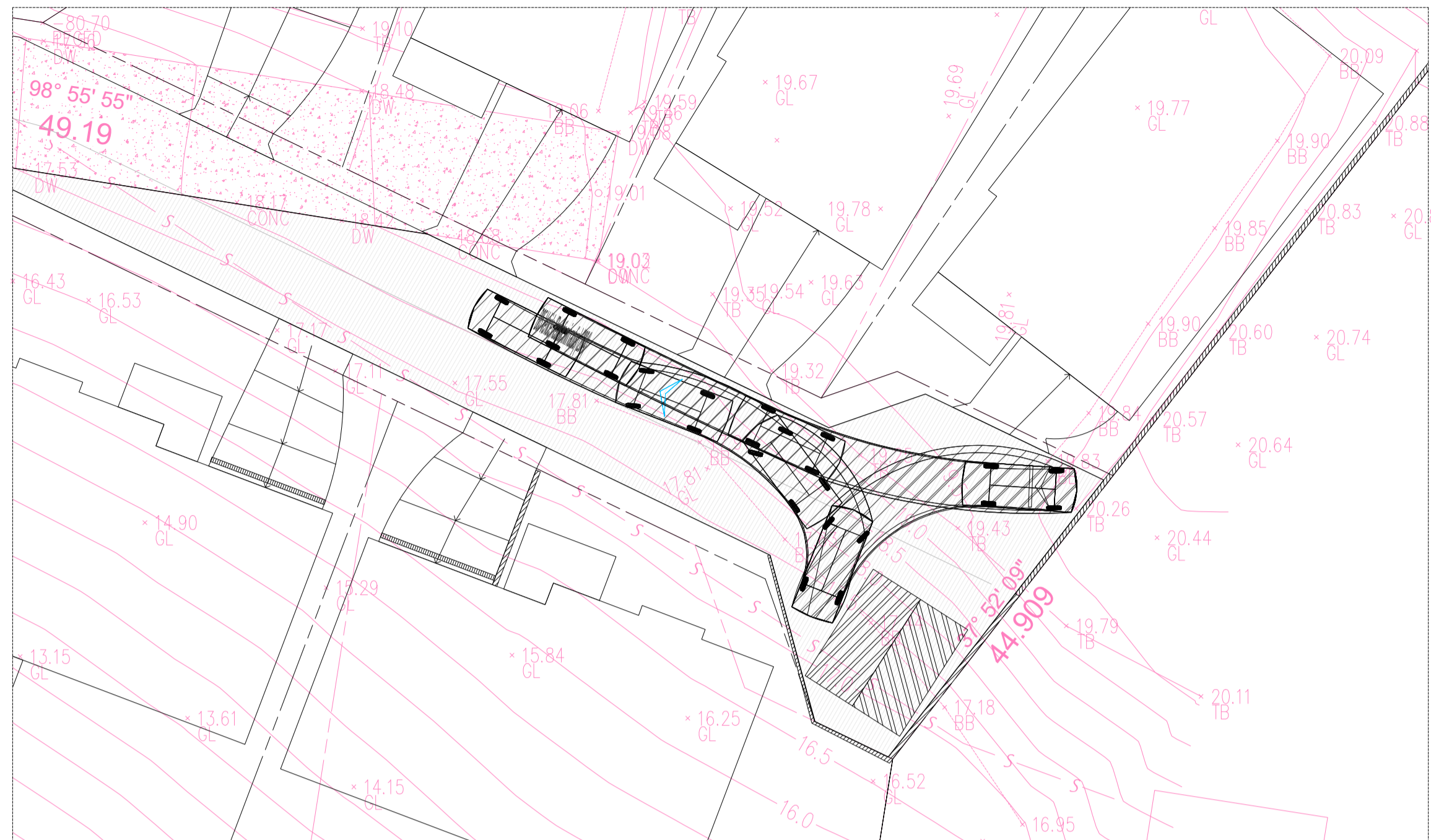

**B85 TURNING PATH - VEHICLE ENTER/EXIT**  
1:200

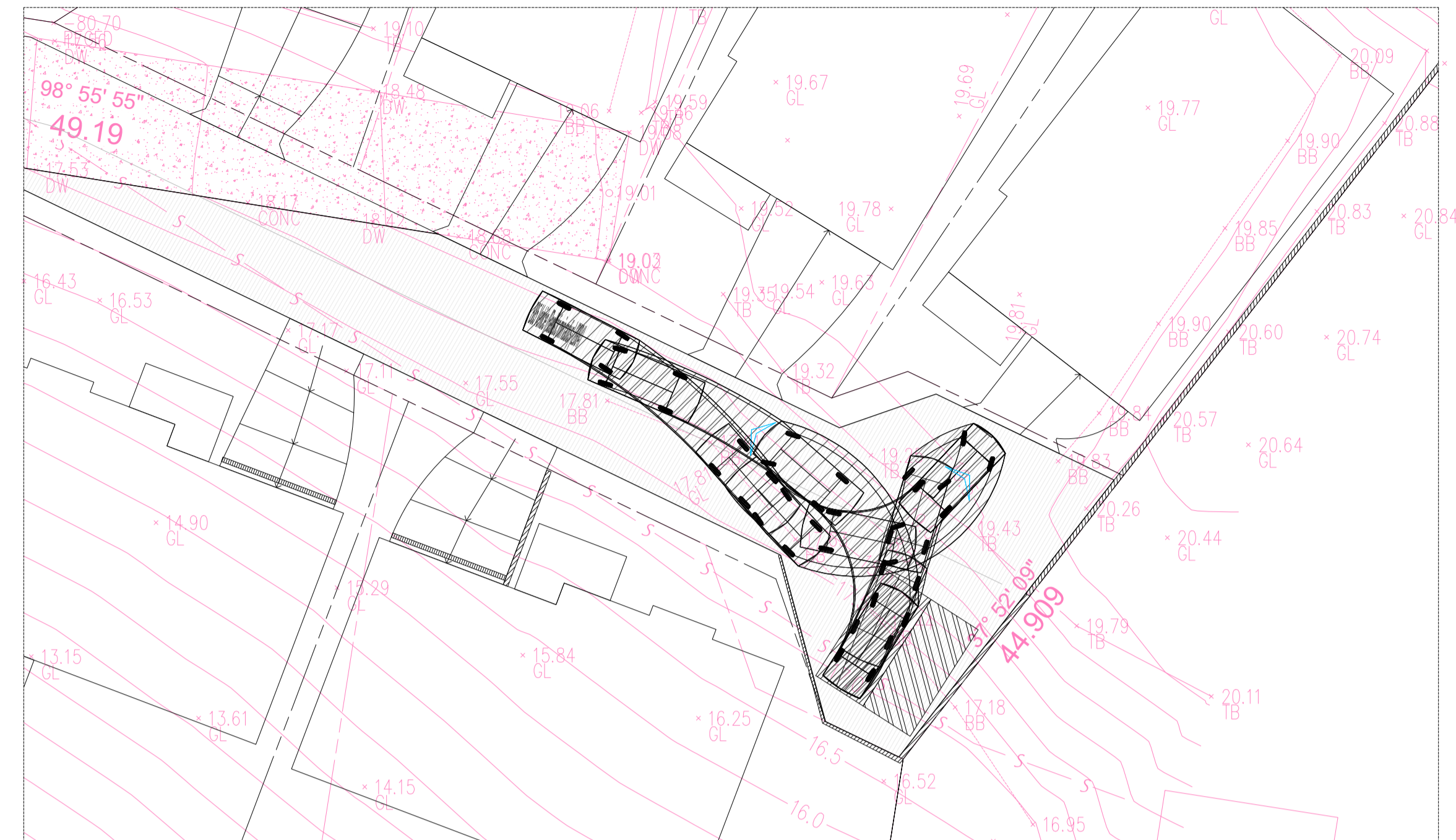

**B85 TURNING PATH - VISITOR PARK 1**  
1:200

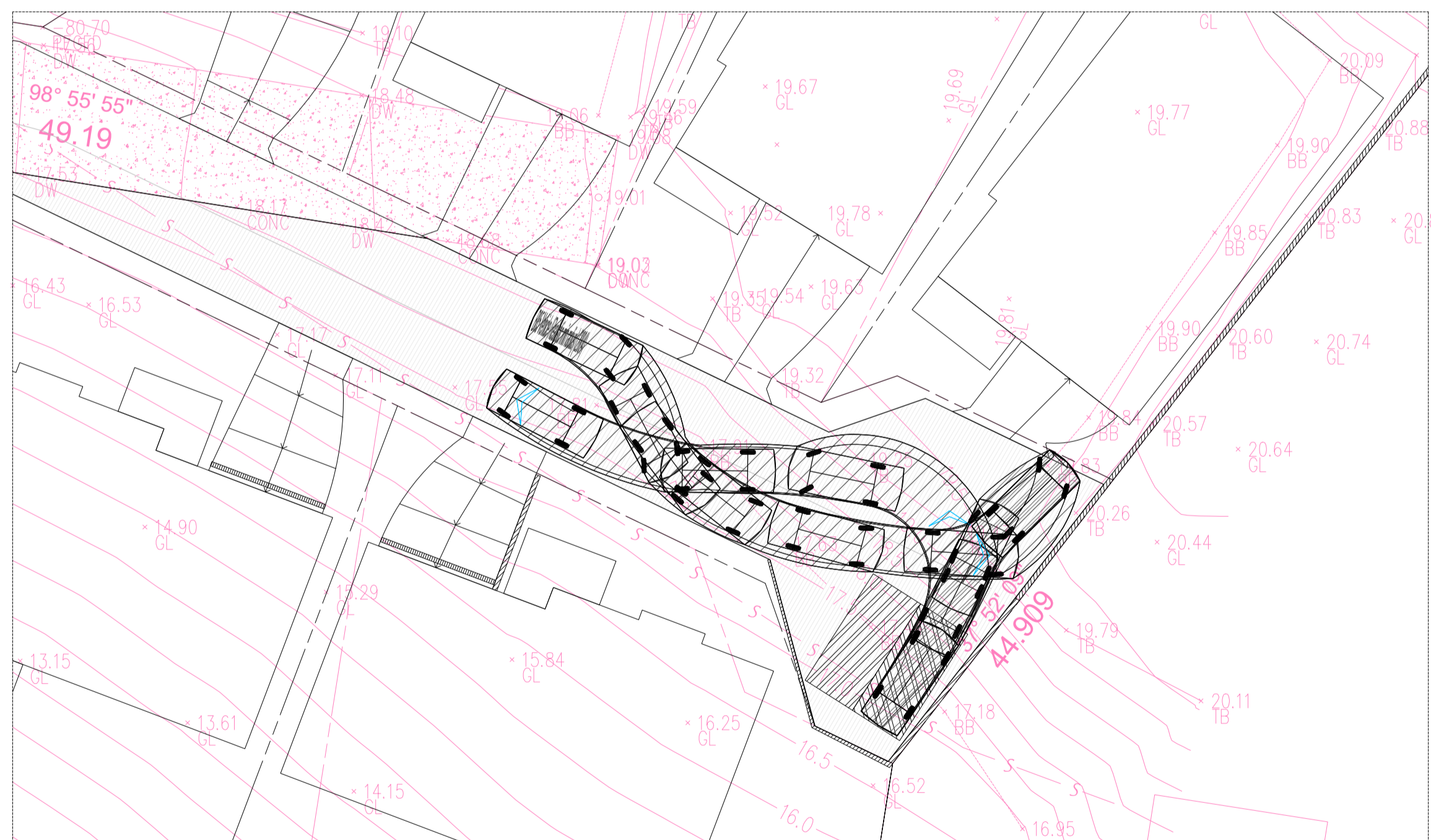

**B85 TURNING PATH - VISITOR PARK 2**  
1:200

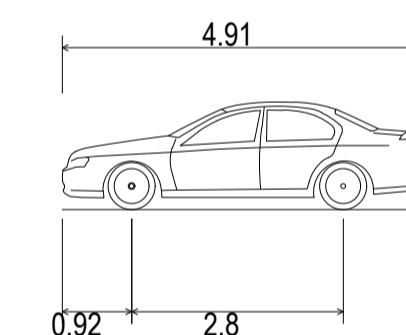

**B85 Vehicle (Realistic min radius) (2004)**  
 Overall Length 4.910m  
 Overall Width 1.870m  
 Overall Body Height 1.421m  
 Min Body Ground Clearance 0.159m  
 Track Width 1.770m  
 Lock-to-lock time 4.00s  
 Curb to Curb Turning Radius 5.750m

| REV | DATE     | DRN  | CHK  | APP  | DRAWING STATUS   |
|-----|----------|------|------|------|------------------|
| B   | 08.11.21 | J.T. | M.M. | M.M. | RE-ISSUED FOR DA |
| A   | 20.08.21 | J.T. | M.M. | M.M. | ISSUED FOR DA    |

This drawing is not approved for construction unless signed.

Mathew McNamara  
BEng (Civil) Hons MIE (Aust)

**COPYRIGHT** - This drawing and the information provided shall remain the property of DRB Consulting Engineers Pty Ltd (DRB) and may not be used, copied or reproduced, in whole or part, for any purpose other than that for which it was supplied without the prior consent of DRB.

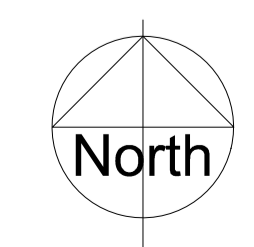

PO BOX 4105 Kotara East 2305  
0402 915 549  
ABN 64 625 755 482

**B85 DRIVEWAY SWEEP PATHS**  
 80 (LOTS 304 & 306) OAKLANDS CLOSE,  
 BOLWARRA  
 PERCEPTION PLANNING

| DRAWING STATUS              |  | SHEET SIZE        |
|-----------------------------|--|-------------------|
| <b>NOT FOR CONSTRUCTION</b> |  | <b>A1</b>         |
| PROJECT REF No. 210695      |  | SCALE 1:200       |
| DRAWING No. CIV07           |  | REVISION <b>B</b> |