

WASTE MANAGEMENT PLAN

Centre-based Child Care Facility

2 Gregory Road, Lochinvar NSW 2321

Lot 1101 in DP1275266

December 2021

Document Control

Prepared by HPC Planning
ABN 48 107 272 757

Reference 20464 WMP

Rev	Date	File	Author	Reviewer	Status
01	14.12.2021	WMP v1	CL	HH	Draft
02	15.12.2021	WMP v2	CL	HH	Final

Contents

1	Introduction	2
2	Operational Waste Management.....	2
2.1	Waste Generation.....	2
2.2	Waste Storage.....	2
2.3	Waste Collection.....	4

1 Introduction

This Waste Management Plan (WMP) has been prepared for Lochinvar Child Care Pty Ltd and has regard to the proposed Centre-based Child Care Facility at 2 Gregory Road, Lochinvar NSW 2321, described as Lot 1101 in DP1275266.

This WMP will assist in identifying the type of waste that will be generated and advise how the development intends to re-use, recycle or dispose of the generated waste.

2 Operational Waste Management

Preparation of this Operational Waste Management Plan has been undertaken with reference to the proponent's substantial experience and industry best practices.

2.1 Waste Generation

The following resource streams will be generated during the development's operational phase:

Material Stream	Source
General Waste	Child Care
Mixed Recycling	Child Care

The table below provides estimated volumes of materials generated by the proposed development operation in litres per week. These have been calculated using the following generation rates adopted from other centres operated by the proponent in the Hunter Region.

Waste stream	Generation rate	Number of children	Total estimated generation
General Waste	19L per child per week, including food waste	82	1,558L per week
Mixed recycling waste	12-15 litres per child per week	82	1,230L per week

2.2 Internal Waste Storage

The development will be provided with smaller indoor waste/recycling bins servicing each activity room for the interim storage of waste generated from the indoors / internal components of the development. It will be the responsibility of the site staff/contracted cleaners to move waste from the indoor waste/recycling receptacles to 1,100L the bulk bins as required throughout the day.

2.3 Bin Storage and Servicing Point

Figure 1 below shows the typical dimensions of a 1,100L bulk bin. Figure 2 demonstrates the location of the bin storage on site. Figure 3 demonstrates that the bin store is sufficiently sized to accommodate one general waste bulk bin and 1 recycling waste bulk bin.

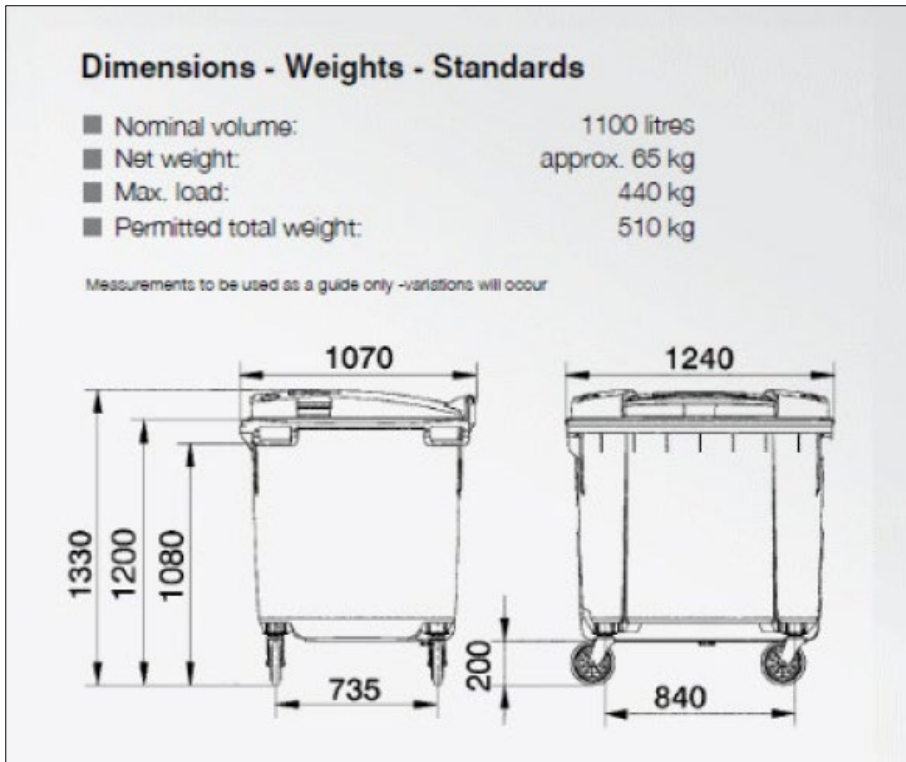

Figure 1: 1,100L bulk bin dimensions

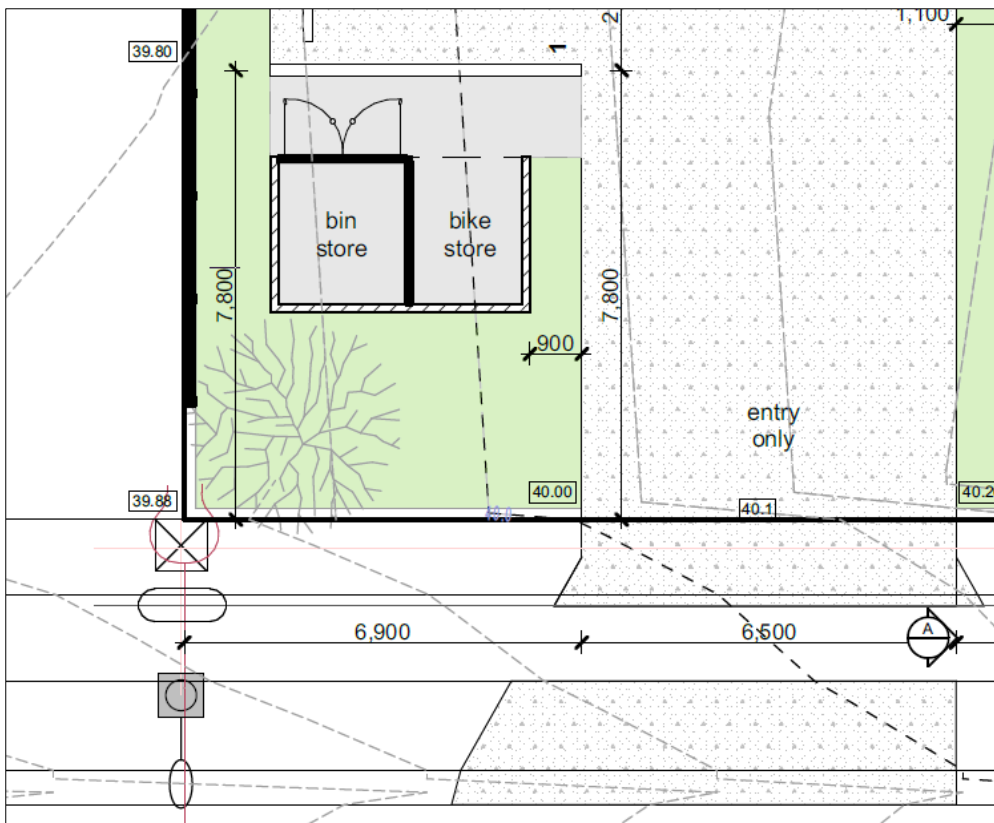

Figure 2: Waste storage area

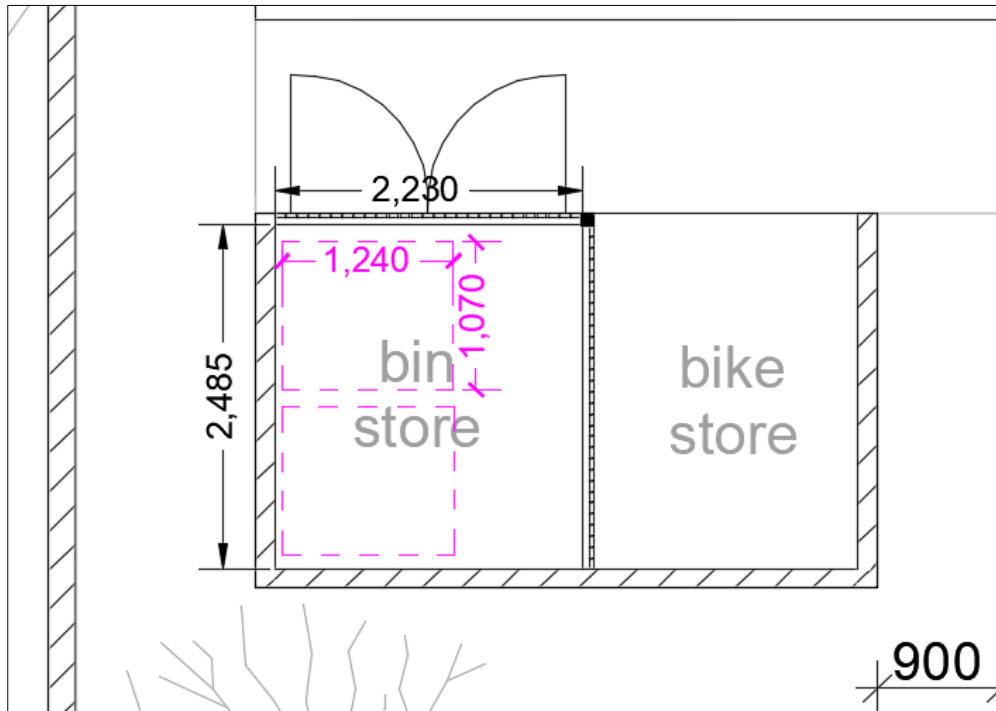

Figure 3: Waste storage area including dimensions and bulk bin accommodation

2.4 Waste Collection

The table below shows the storage requirement and collection frequency that will be required to service the waste generated by the development.

Waste stream	Bin size	No. of bins	Weekly generation	Collections per week
General Waste	1,100L	1	1,558L	2
Mixed recycling waste	1,100L	1	1,230L	2

The proposed development provides for onsite refuse collection to occur from the carpark. As confirmed by the Traffic Assessment submitted with the development application material, a refuse collection vehicle can use the carpark to manoeuvre on site and enter and exit in a forward direction.

The agreement with the waste collection contractor will ensure that collection periods occur outside peak drop-off and pick up times to minimise conflicts with development traffic.