

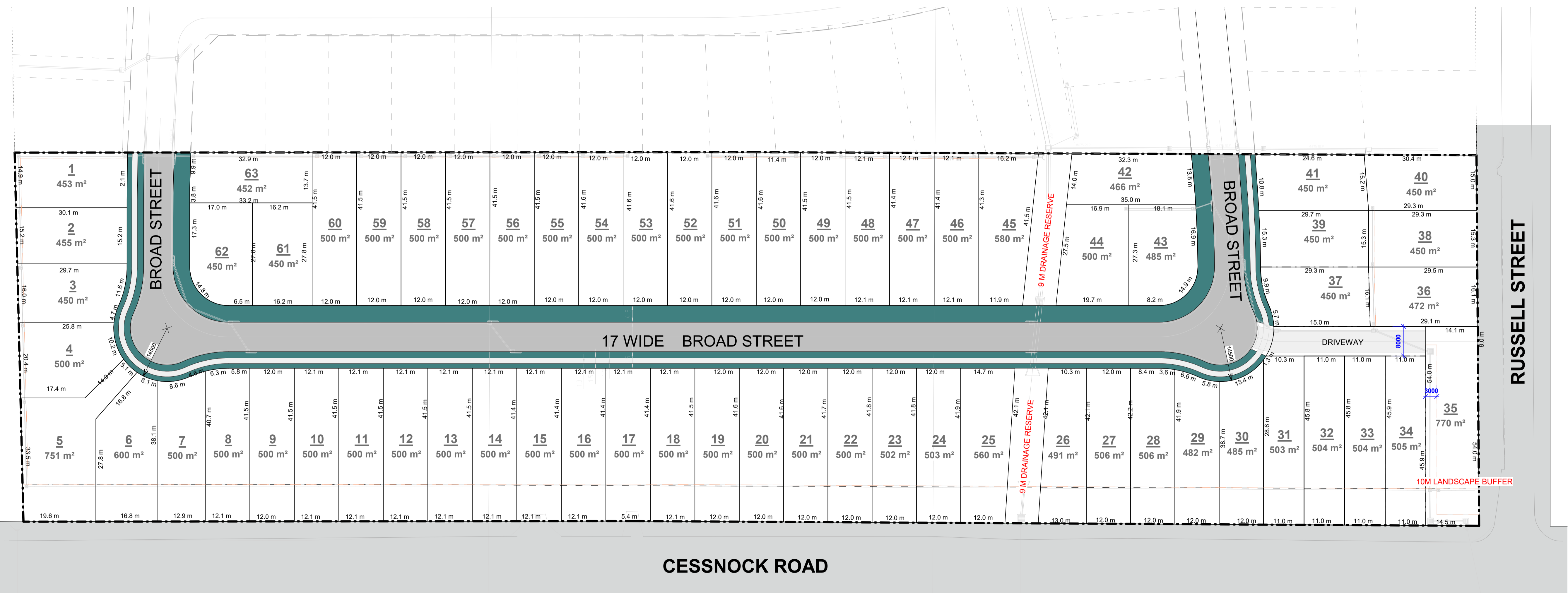

SITE LOCATION (SOURCE: SIX MAPS)



1 NP01 NOTIFICATION PLAN  
1:600

DO NOT SCALE  
USE FIGURED DIMENSIONS AT ALL TIMES. IF IN DOUBT CHECK WITH THE BUILDER. CONTRACTORS TO CHECK AND VERIFY ALL LEVELS, DATUMS AND DIMENSIONS ON SITE AND SHALL REPORT ANY DISCREPANCIES OR OMISSIONS TO THE BUILDER PRIOR TO COMMENCEMENT OF WORK AND DURING THE CONSTRUCTION PHASE.

REV	DATE	DESCRIPTION	BY
1	05/07/2022	ISSUED FOR DA APPLICATION	SS

GENERAL NOTES:  
THIS DRAWING IS THE EXCLUSIVE PROPERTY OF THE DEVELOPER & THE REPRODUCTION OF ANY PART WITHOUT THE PRIOR WRITTEN CONSENT OF THE DEVELOPER IS A VIOLATION OF APPLICABLE LAWS. IN NO EVENT SHALL THE DEVELOPER BE HELD LIABLE FOR SPECIAL, COLLATERAL, INCIDENTAL, OR CONSEQUENTIAL LIABILITY IN CONNECTION WITH THE USE OF THIS DIGITAL DATA ONCE RELEASED FROM THE DEVELOPER'S OFFICE. THIS DRAWING IS TO BE READ & UNDERSTOOD IN CONJUNCTION WITH THE STRUCTURAL, MECHANICAL, ELECTRICAL & / OR ANY OTHER CONSULTANT'S DOCUMENTATION AS MAY BE APPLICABLE TO THE PROJECT PRIOR TO THE START OF ANY WORKS AND FOR ITS DURATION.

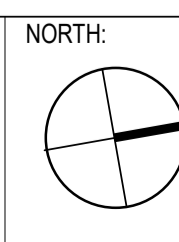

02 9636 2465 | 02 9688 4762 | www.bathla.com.au  
**The Bathla Group**  
 137 Gilba Road, Girraween NSW 2145  
 PO Box 270, Westworthville NSW 2145  
 Connect with us "Building dreams together."

PROJECT:  
412 Cessnock Road Gillieston Heights  
2321



LOT NUMBER:  
Lot 21 & 22 DP1092105

DRAWING TITLE:  
**NOTIFICATION PLAN**

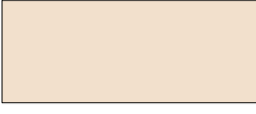

PROJECT No.	DATE	DRAWING No.	REV.
SS	15/06/2022	NP01	1
DRAWN BY:	SCALE:	ISSUED BY:	
SS	1:600	SS	

2:\Projects-Current\Cessnock Road 412-414\_Gillieston Heights\03 DA\ARCHITECTURAL\REVIT\PROJECT\Cessnock Road 412-414\_Gillieston Heights\_R01\_Russell Street.rvt

DA ISSUE

CODE	LOT AREA
	450 SQMT LOTS
	500 SQMT LOTS
	VARIABLE
<b>TOTAL NO OF LOTS - 63</b>	

**LEGEND**

-  SITE BOUNDARY
-  PROPOSED LOT BOUNDARY
-  DRAINAGE EASEMENT

OVERALL SITE AREA - 39600 SQM

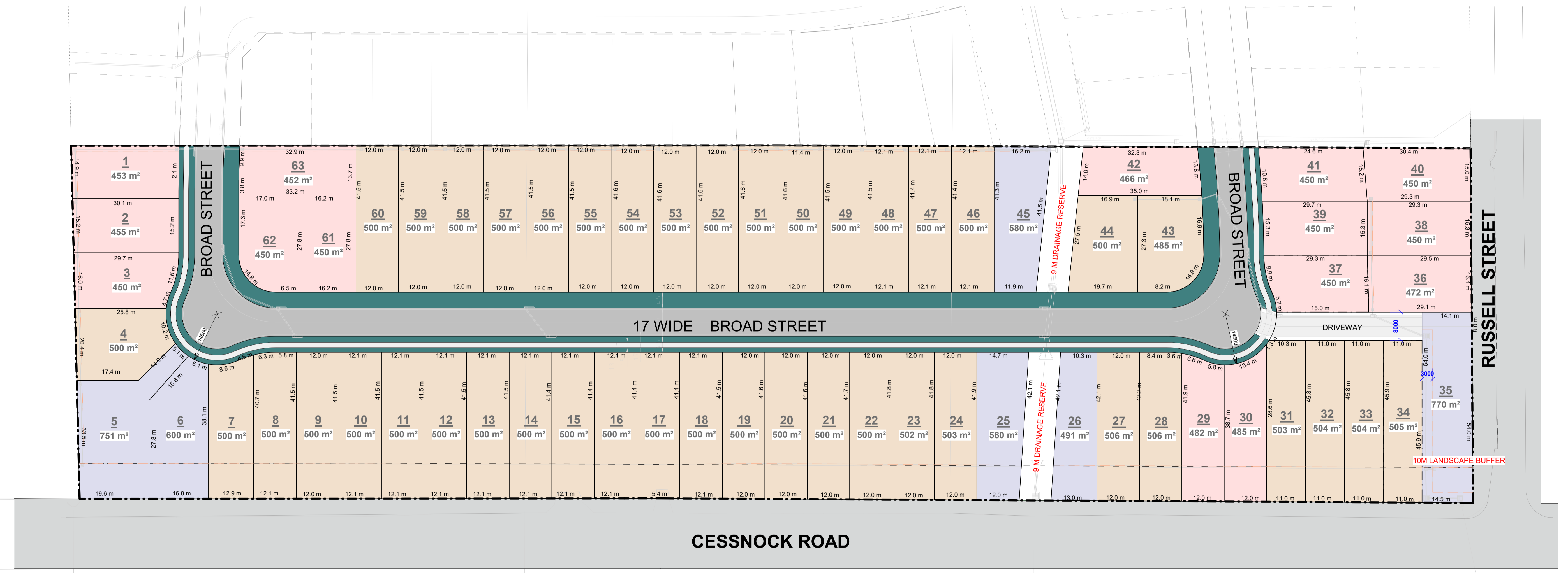

**1** SUBDIVISION PLAN  
1:600

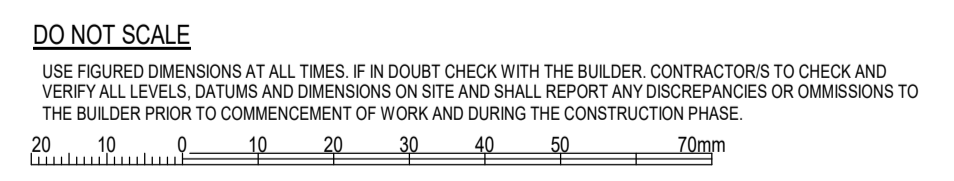

REV	DATE	DESCRIPTION	BY
1	05/07/2022	ISSUED FOR DA APPLICATION	SS

**GENERAL NOTES:**

THIS DRAWING IS THE EXCLUSIVE PROPERTY OF THE DEVELOPER & THE REPRODUCTION OF ANY PART WITHOUT THE PRIOR WRITTEN CONSENT OF THE DEVELOPER IS A VIOLATION OF APPLICABLE LAWS. IN NO EVENT SHALL THE DEVELOPER BE HELD LIABLE FOR SPECIAL, COLLATERAL, INCIDENTAL, OR CONSEQUENTIAL LIABILITY IN CONNECTION WITH THE USE OF THIS DIGITAL DATA ONCE RELEASED FROM THE DEVELOPER'S OFFICE. THIS DRAWING IS TO BE READ & UNDERSTOOD IN CONJUNCTION WITH THE STRUCTURAL, MECHANICAL, ELECTRICAL & / OR ANY OTHER CONSULTANT'S DOCUMENTATION AS MAY BE APPLICABLE TO THE PROJECT PRIOR TO THE START OF ANY WORKS AND FOR ITS DURATION.

**NORTH**



02 9636 2465 | 02 9688 4762 | www.bathia.com.au

**The Bathia Group**

137 Gibba Road, Girraween NSW 2145  
PO Box 270, Westworthville NSW 2145

Connect with us *Building dreams together.*

**PROJECT:**  
412 Cessnock Road Gillieston Heights  
2321

**LOT NUMBER:**  
Lot 21 & 22 DP1092105

**DRAWING TITLE:**  
SUBDIVISION PLAN

PROJECT No.	DATE	DRAWING No.	REV.
SS	15/06/2022	DA02	1
<b>DRAWN BY:</b> SS		<b>ISSUED BY:</b> SS	

2:\Projects-Current\Cessnock Road 412-414\_Gillieston Heights\03 DA\ARCHITECTURAL\REVIT\PROJECT\Cessnock Road 412-414\_Gillieston Heights\_R01\_Russell Street.rvt