

Version 2.2 (30 November 2020)

BUILDING PLAN ASSESSMENT

Clear of Hunter Water Assets

Reference No: 21467

Water not available for connection
 Sewer not available for connection

Only valid for 21467

Development Assessment (Section 50) application has been submitted and is being reviewed by Hunter Water. A Hydraulic Design Assessment application is required if development is larger than 2 units or commercial/industrial. Application for Services Connection will be required.

Date Processed: 16 April 2021
 Applicant: Perception Planning, Roxy White
 Property Location: 213 STATION LANE LOCHINVAR

PLEASE TAKE INTO CONSIDERATION

412
DP 794240

708
1.06 Ha

709
3.07 Ha

E3

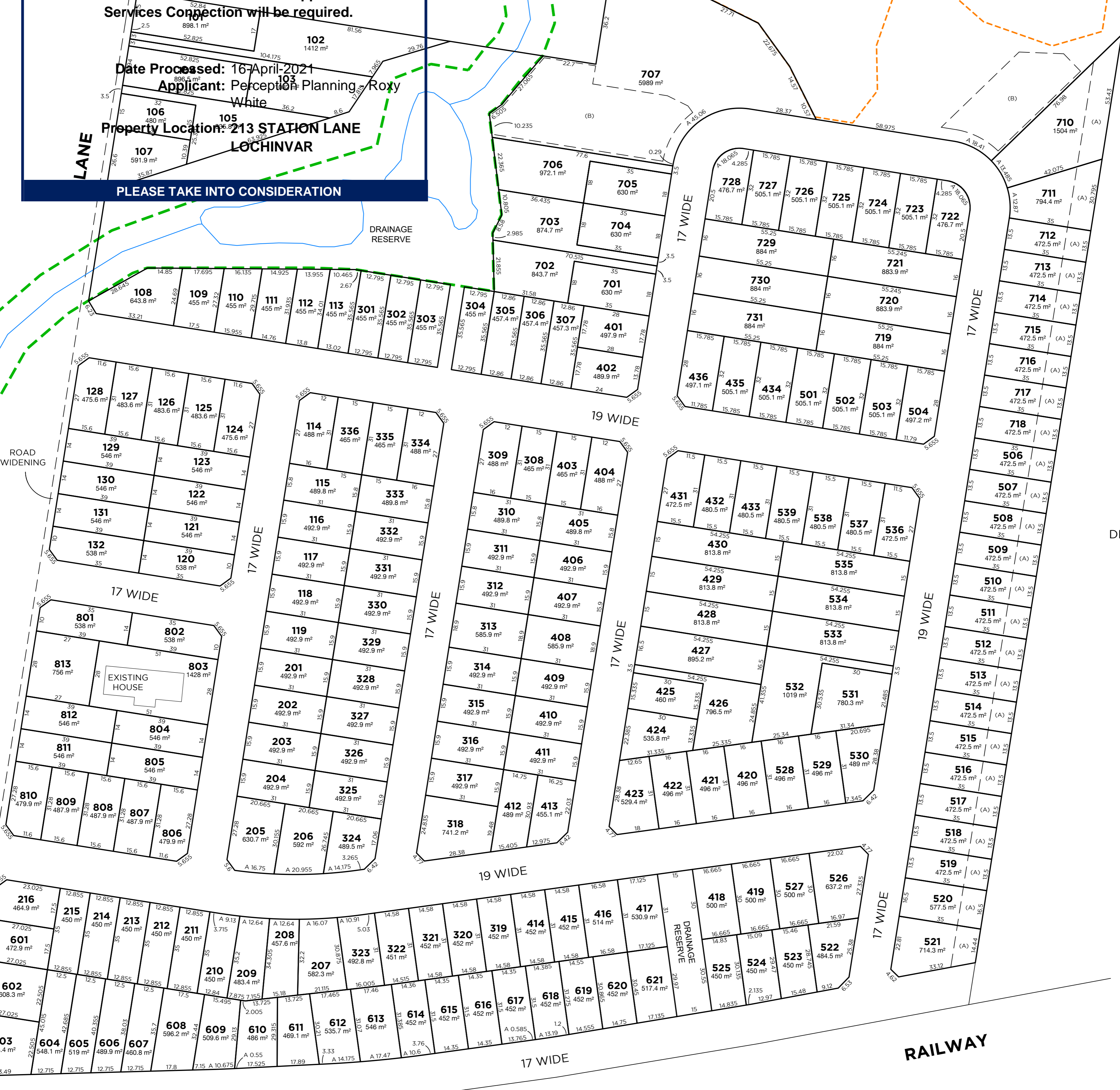

1309
DP 1141533

RAILWAY

NORTHERN

MAIN

LEGEND

- (A) ASSET PROTECTION ZONE 10 WIDE
- (B) BUILDING ENVELOPE
- ZONE BOUNDARY (E3)
- RIPARIAN BUFFER (10m)
- WATER COURSE (FROM DCDB INFORMATION)

LOTS 224
DRAINAGE RESERVES 2

REV.	DATE	AMENDMENT(S)	SUR	DFT	CHK
A	27.10.20	ORIGINAL ISSUE	-	JD	TC
B	13.11.20	AMENDED LOT LAYOUT	-	JD	TC
C	10.12.20	AMENDED LOT LAYOUT	-	JD	TC
D	16.03.21	AMENDED LOT LAYOUT	-	TC	TC
E	31.03.21	APZ & BUILDING ENVELOPE ADDED	-	ND	ND
F	14.04.21	AMENDED LOT LAYOUT & LOT NUMBERING	-	TC	TC

DELFS LASCELLES
CONSULTING SURVEYORS

260 MAITLAND ROAD, T: (02) 4964 4886
MAYFIELD NSW 2304 E: admin@delcs.com.au
ABN: 28 164 260 100 delcs.com.au

CAD REF: 20618_Site Plan_Rev F

SUBDIVISION LAYOUT
LOT 1307 & 1308
DP 1141533

SITE ADDRESS: STATION LANE LOCHINVAR
CLIENT: T. KENYON

POSITION DATUM: N/A
ORIENTATION: MGA (GROUND)
EASTING: -
NORTHING: -
CLASS: -
HEIGHT DATUM: N/A
CLASS: -
RL: -

ORDER: -
DATE: -

ASPIRE COMPANY
UNIVERSITY COMPANY
JAS-ANZ
QUAL APPROVED YOU DEC

SURVEYED	DRAFTED	CHECKED
-	JD	TC
SCALE	PAGE SIZE	DATE
1:1000	A1	10.12.20
SHEET	REV.	PROJECT No.
1 of 3	F	20618