

SURVEY NOTES:

THIS PLAN HAS BEEN PREPARED WITH THE INTENTION OF PROVIDING AN INDICATIVE DESIGN TO ACCOMPANY A DEVELOPMENT APPLICATION TO COUNCIL.

THE INFORMATION DEPICTED ON THIS PLAN IS NOT TO BE USED FOR ANY REASON OTHER THAN WHAT IS STATED ABOVE.

ALL DIMENSIONS, AREAS AND TOTAL NUMBER OF LOTS SHOWN ON THIS PLAN ARE APPROXIMATE AND SUBJECT TO FIELD SURVEY AND ALSO TO THE REQUIREMENTS OF COUNCIL AND ANY OTHER AUTHORITY WHICH MAY HAVE REQUIREMENTS UNDER ANY RELEVANT LEGISLATION.

IN PARTICULAR, NO RELIANCE SHOULD BE PLACED ON THE INFORMATION ON THIS PLAN FOR DETAILED DESIGN OR FOR ANY FINANCIAL DEALINGS INVOLVING THE LAND.

INTRAX CONSULTING GROUP THEREFORE DISCLAIMS ANY LIABILITY FOR ANY LOSS OR DAMAGE WHATSOEVER OR HOWSOEVER INCURRED, ARISING FROM ANY PARTY USING OR RELYING UPON THIS PLAN FOR ANY PURPOSE OTHER THAN AS A DOCUMENT PREPARED FOR THE SOLE PURPOSE OF ACCOMPANYING AN APPLICATION TO COUNCIL FOR DEVELOPMENT AND WHICH MAY BE SUBJECT TO ALTERATION FOR REASONS BEYOND THE CONTROL OF INTRAX CONSULTING GROUP.

UNLESS STAMPED BY COUNCIL, THIS PLAN IS NOT A PLAN OF AN APPROVED DEVELOPMENT.

THIS NOTE IS AN INTEGRAL PART OF THE PLAN.

NOTE:
AREAS AND DIMENSIONS ARE SUBJECT TO
FINAL SURVEY AND COUNCIL APPROVAL

TO BE TORRENS TITLED

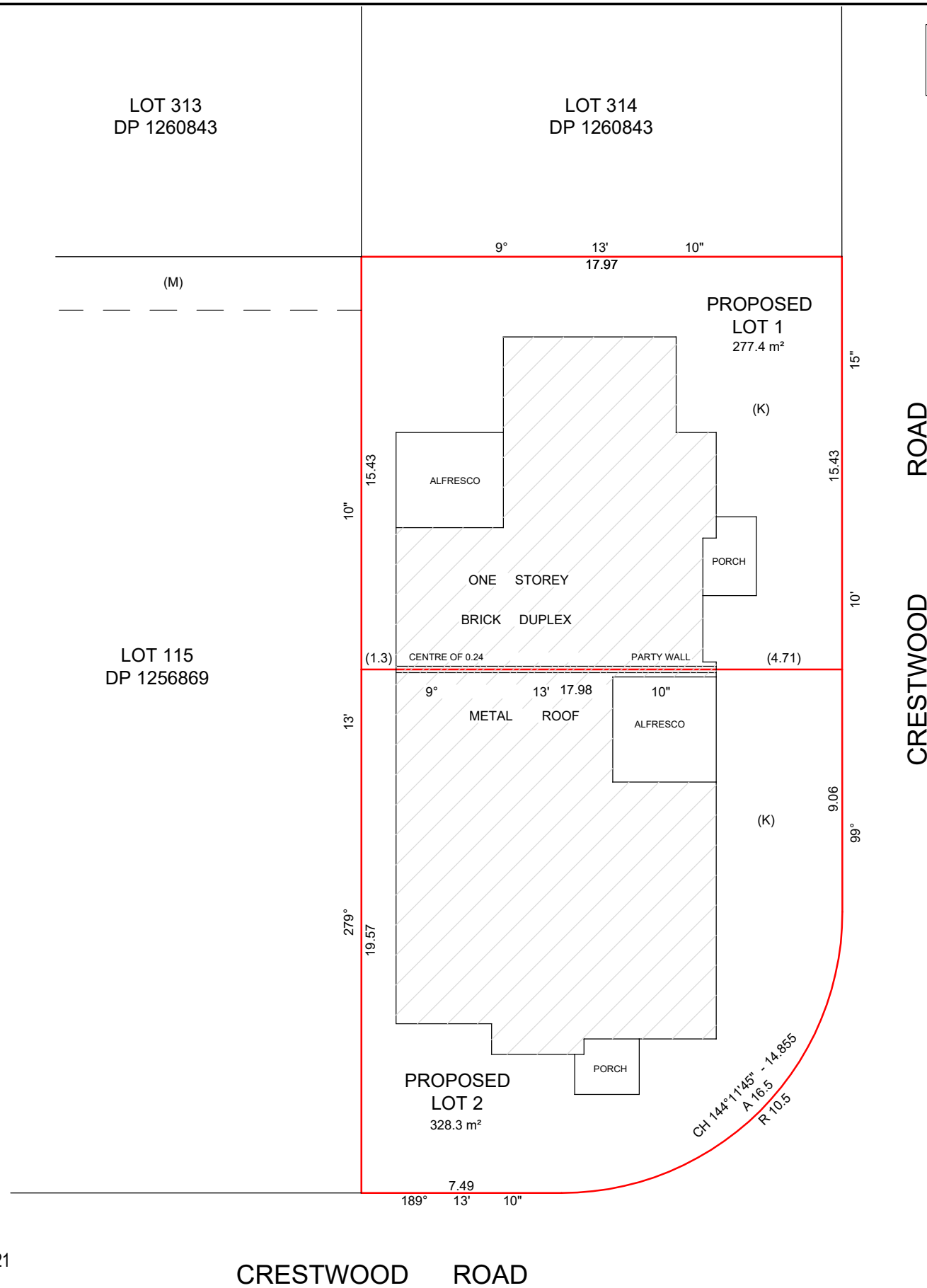

- (K) - BENEFITED BY EASEMENT TO DRAIN WATER (M) (DP 1256869)
- (M) - EASEMENT TO DRAIN WATER 2 AND 2.5 WIDE (DP 1256869)

SETOUT DIMENSIONS ARE BASED ON DESIGN JOB No.: 144325 DATED 16.04.2021

CRESTWOOD ROAD

DRAWING No: 151201_SUR_PROSUB_27 CRESTWOOD ROAD, THORNTON - REV A	REV	REVISION DETAILS	DATE	REDUCTION RATIO 1:100 @ A1 & 1:200 @ A3	CLIENT:	IMPACT HOMES PTY LTD	CLIENT No:	2531607	LOT No.	315	CONTOUR INTERVAL:	-	www.intrax.com.au Intrax Consulting Group VIC NSW SA QLD	PLAN SHOWING PROPOSED SUBDIVISION OF FOR LOT 315 IN DP 1260843 "No. 27" CRESTWOOD ROAD, THORNTON	SHEET No.	1
					REF:	S#151201	SURVEY FILE:	151201_Master File_IL	SECTION	-	DATUM:	-			No. of SHEETS:	1
					SURVEYED BY:	-	DATE OF SURVEY:	-	PLAN No.	DP 1260843	ORIGIN OF LEVELS:	-	SITE No:	S#151201	REV:	-
					DRAWN BY:	I SZPYTMA	CHECKED BY:	B O'HARA	SUBURB	THORNTON	RL:	-				
									LGA	MAITLAND						
									PARISH	ALNWICK						
									COUNTY	NORTHUMBERLAND						