

COORDINATE SCHEDULE

MARK	MGA COORDINATES		CLASS	PU	METHOD	STATE
	EASTING	NORTHING				
					SCIMS	FOUND
					SCIMS	FOUND
					SCIMS	FOUND

DATE OF SCIMS COORDINATES: / /20 MGA ZONE: 56
 MGA DATUM: GDA
 COMBINED SCALE FACTOR 0.999

NOTE: ALL BEARINGS, DISTANCES, AREAS AND EASEMENTS ARE SUBJECT TO FINAL SURVEY AND REGISTRATION OF A PLAN OF SUBDIVISION

DRAFT
 REVISION B 4/11/2021

MGA SCIMS

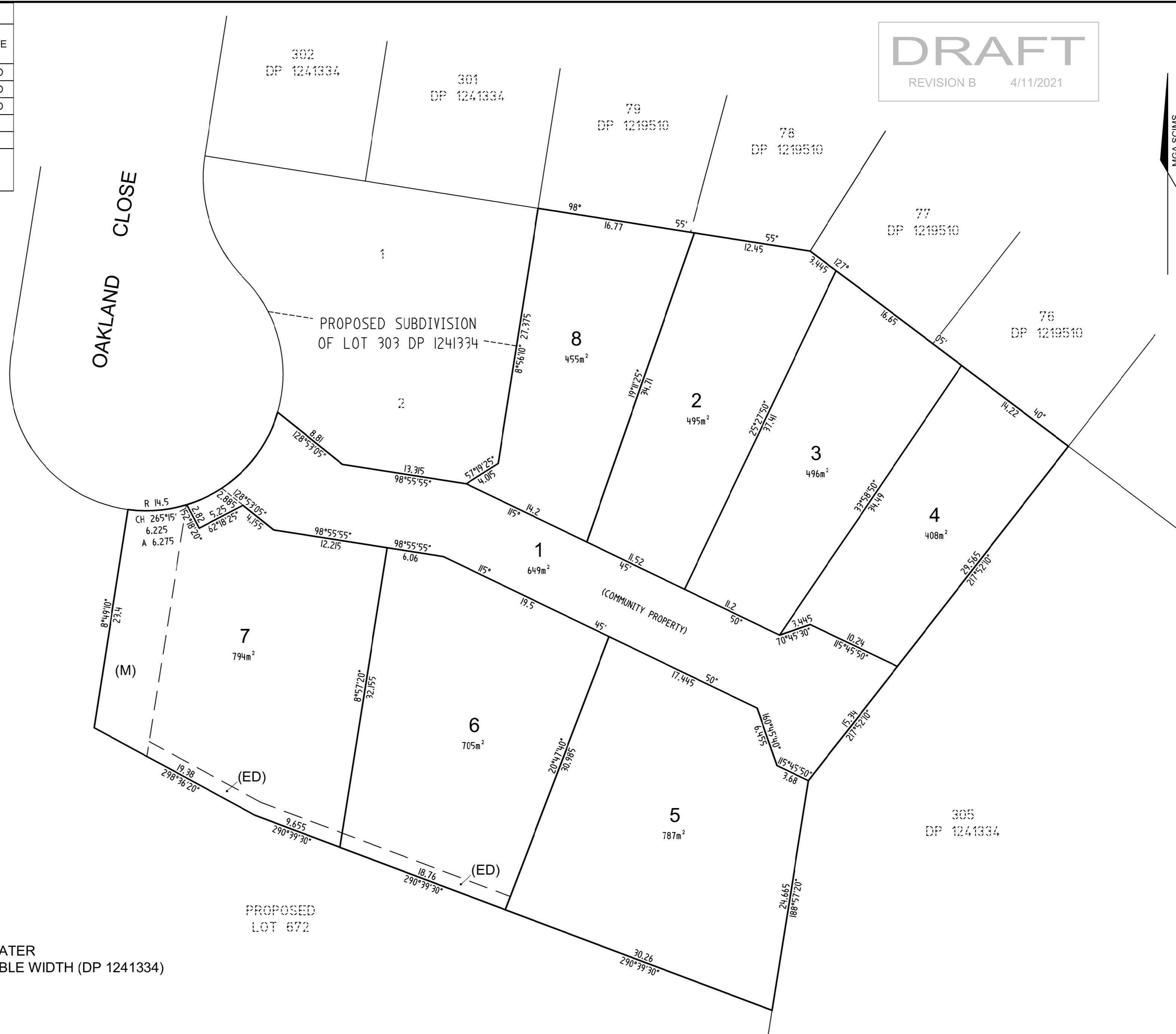

(ED) PROPOSED EASEMENT FOR DRAINAGE OF WATER
 (M) EASEMENT FOR DRAINAGE OF WATER VARIABLE WIDTH (DP 1241334)

NORTH POINT SURVEYS (NSW) PTY LTD
 A/F NORTH POINT SURVEYS TRUST AEN 52 041 168 075
 SURVEYING AND LAND DEVELOPMENT CONSULTANTS
 Level 1 | 19 Stockton Street | Nelson Bay NSW 2315
 PO Box 378 | Nelson Bay NSW 2315
 Phone: 02 4984 2606
 Email: admin@northpointsurveys.com.au

SURVEYOR
 Name: ANDREW EDWARD DALY
 Date: .
 Reference: 37017 DP-4

COMMUNITY TITLE SUBDIVISION
 OF PROPOSED LOT 342 &
 PROPOSED LOT 671

LGA: MAITLAND
 Locality: BOLWARRA
 Reduction Ratio 1: 300
 Lengths are in metres

REGISTERED

REV.	REVISION DETAILS	DATE
B	LOT 7 REVISED	4/11/21